



SHERPA
PREMIUM RACK SYSTEMS

THE DIABLO

RACK SYSTEM INSTALL GUIDE

HARDWARE CHECKLIST

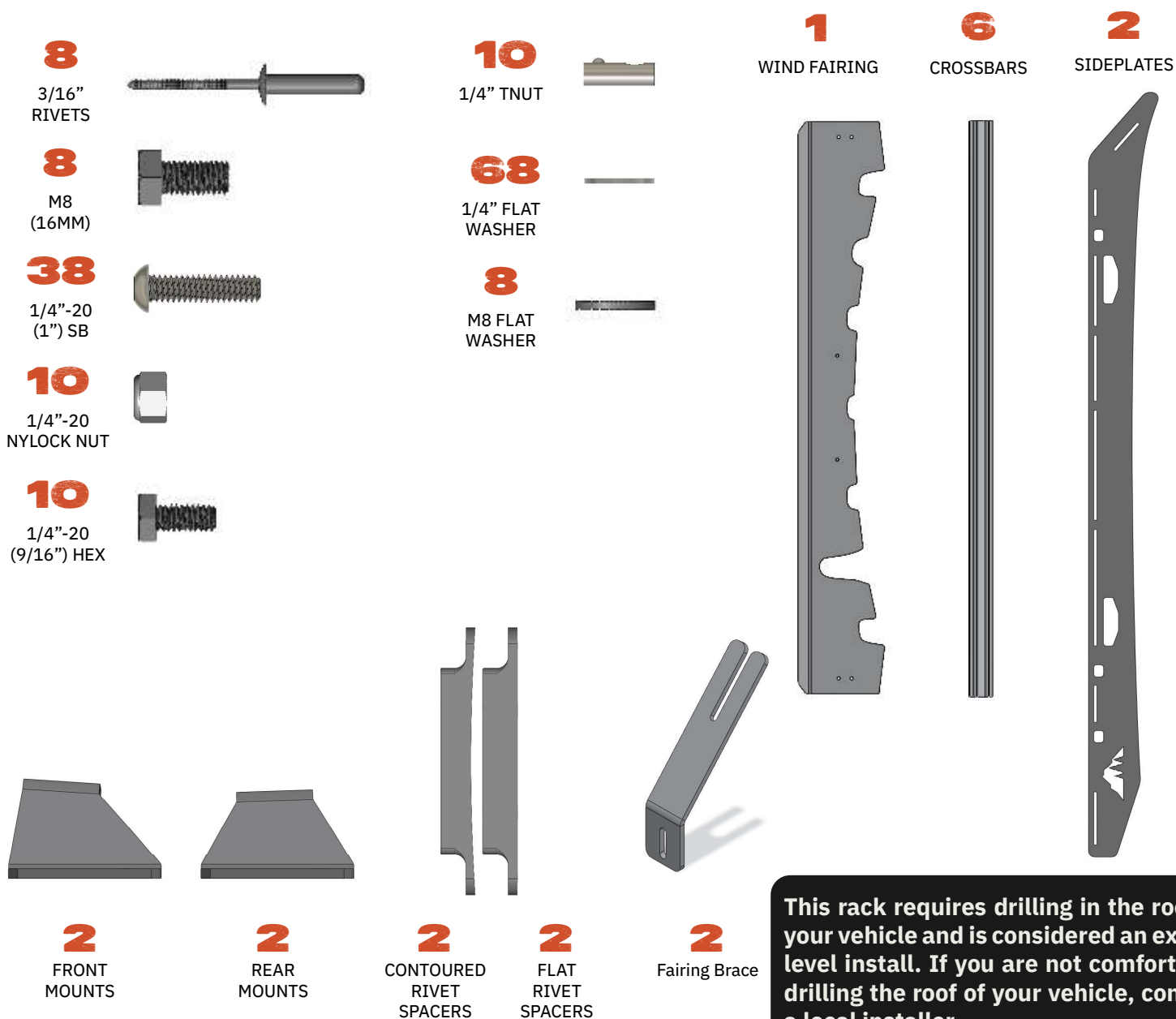

This rack requires drilling in the roof of your vehicle and is considered an expert level install. If you are not comfortable drilling the roof of your vehicle, contact a local installer.

BEFORE YOU START

Remove your stock roof rack (if applicable). Loosen all stock rack bolts before fully removing any of them. This will prevent the capture plates from working loose inside of the roof. Work slowly when removing the stock rack as not to break the plastic sleeves.

The below assembly images may differ slightly in appearance from actual product.

USING TNUTS

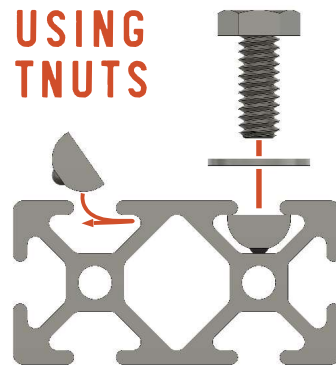

PRE-ASSEMBLY

01 MOUNT ASSEMBLY

Required Components:

- 8 M8 x 16 Hex Bolt
- 8 M8 Flat Washers
- 2 Rivet Spacer - Contour
- 2 Rivet Spacer - Flat

Loosely fasten the supplied rivet spacers to the bottom (longer) flange of the mounting brackets using the supplied M8 hex bolts and M8 flat washers. The **contour** spacers go on the front mounting brackets, and the **flat** spacers go on the rear mounting brackets. The brackets are designated with 'F' and 'R', respectively.

Note the **notch** in the bottom flange of the mounting bracket. The notched corner will face towards the front of the vehicle. You should have two opposing front mounting brackets and two opposing rear mounting brackets.

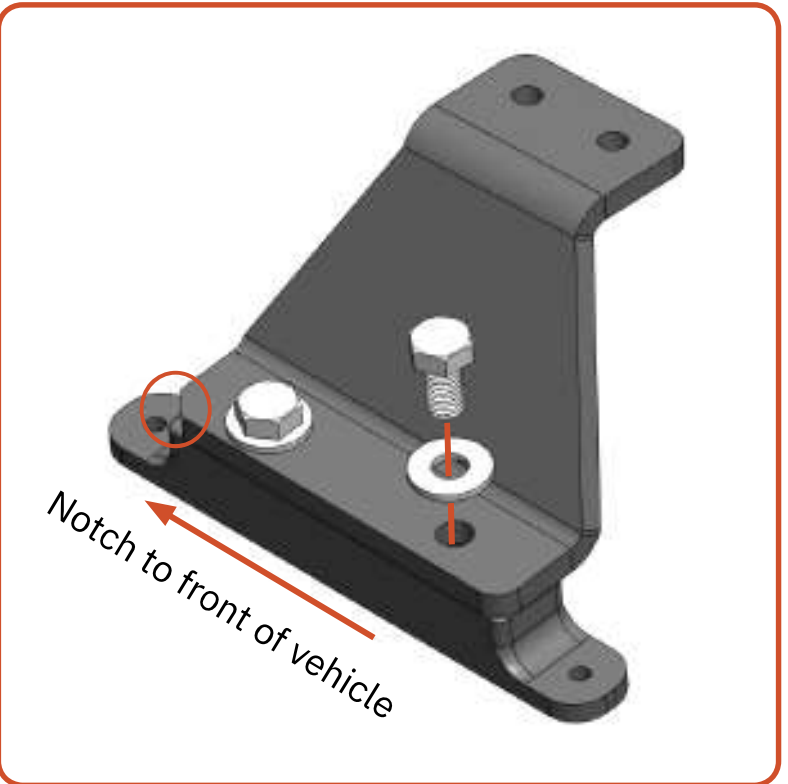
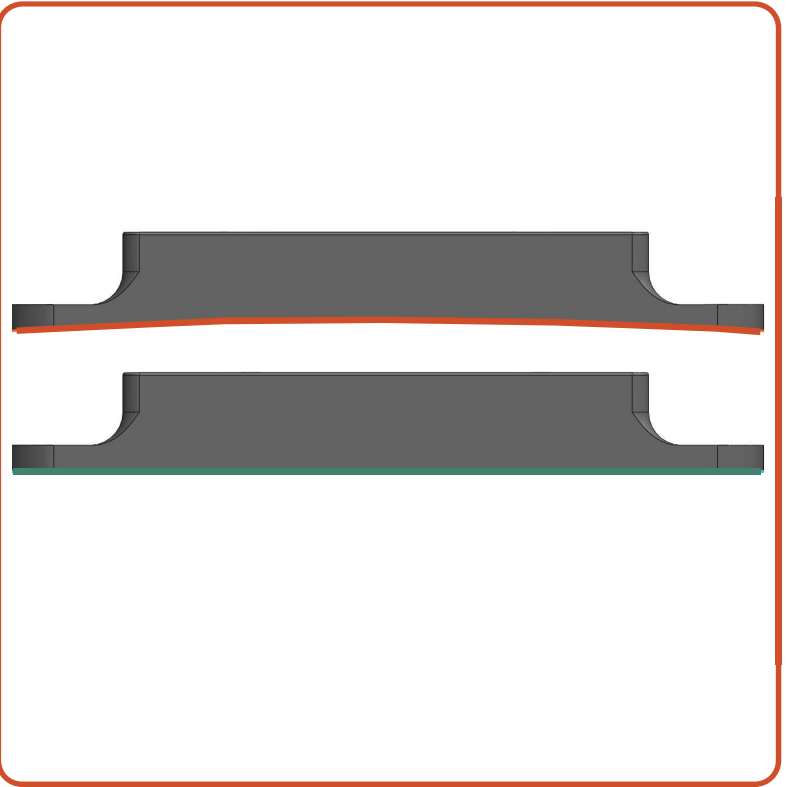

02 MOUNT ASSEMBLY

Required Components:

- 8 1/4"-20 x 9/16"
- 8 1/4" Flat Washers
- 8 1/4" Tnuts

Secure the tops of the mounting bracket pairs to the wide faces of the cross bars using the supplied Tnuts, 9/16" hex bolts, and flat washers.

Leave the hardware that attaches the mounts to the crossbar loose. This will make it easier when placing the rack on the truck later.

Later, the rack can be centered on the roof by measuring the **distance from the ends of the cross member to the inside-edge of the mounting brackets** on either side of the vehicle.

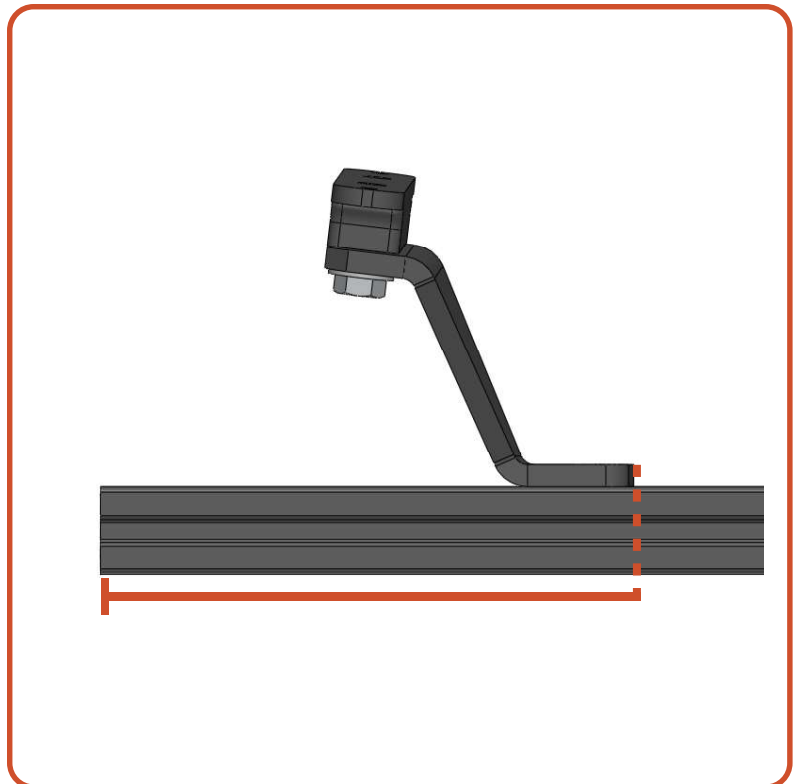
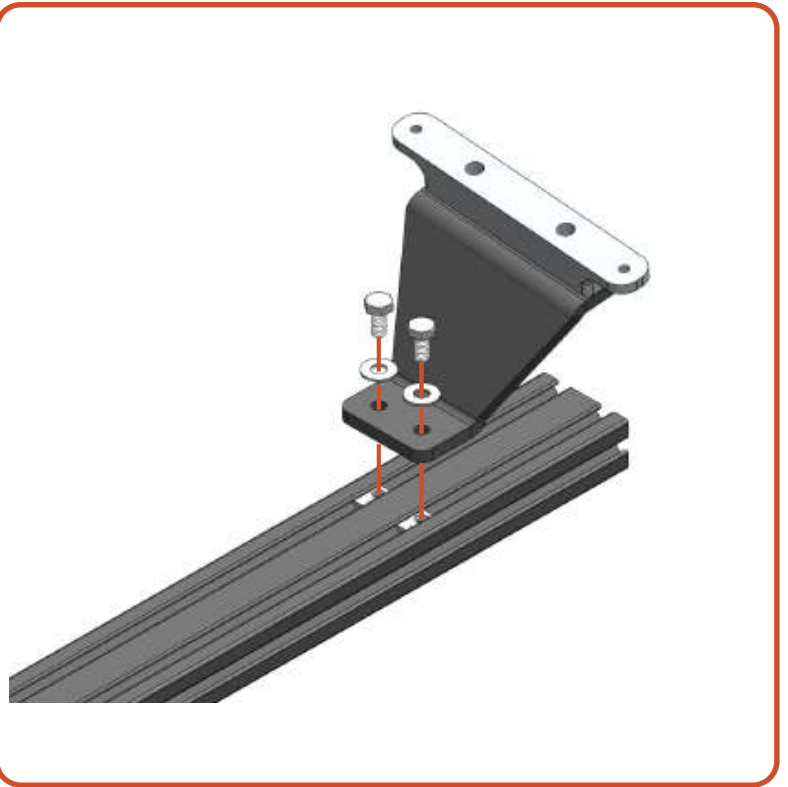

PRE-ASSEMBLY

01 SIDEPLATE ASSEMBLY

Required Components:

8 1/4"-20 x 1" Socket Button

8 1/4"-20 Flat Washers

Fasten the sideplates to the ends of the two mounting-foot crossbars using the supplied 1" socket button screws and flat washers in the **designated mounting slots**. Refer to the diagram below for the locations of the slots.

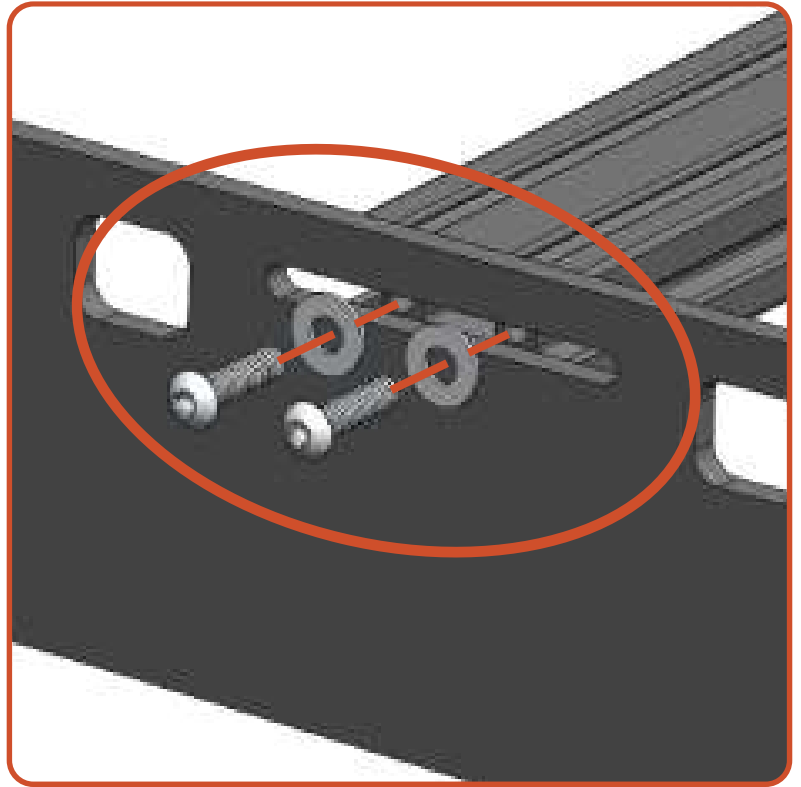

WIND FAIRING

01 INSTALL BRACES

Required Components:

- 2 Braces
- 2 1/4"-20x1" Socket Bolts
- 2 1/4" Flat Washers

Secure braces to the fairing leaving the hardware loose so that it can be adjusted during a later step.

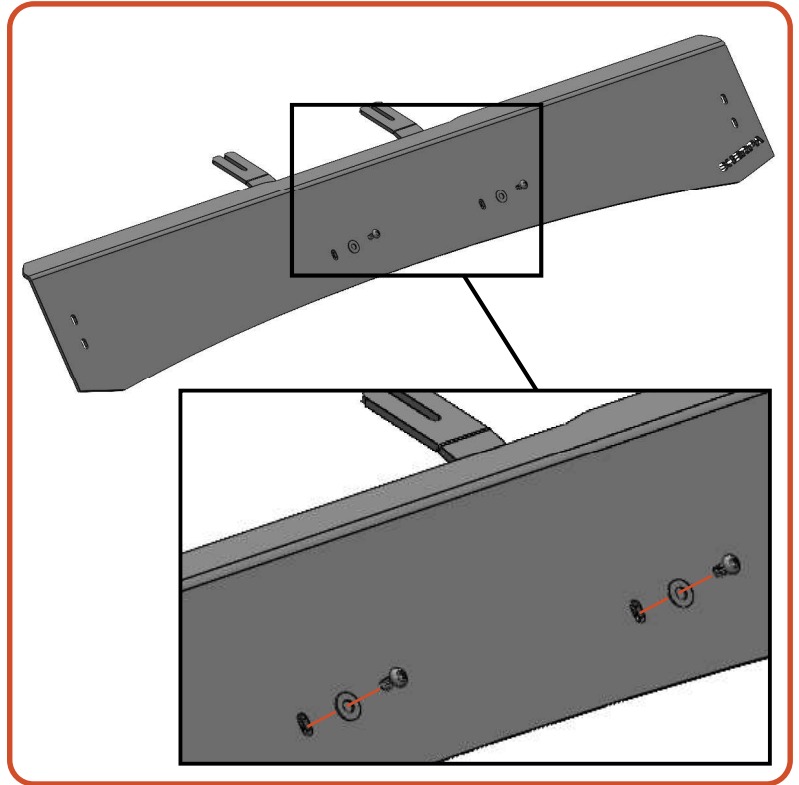

02 FAIRING BRACKETS

Required Components:

- 2 Fairing Brackets
- 4 1/4"-20x1" Socket Bolts
- 8 1/4" Flat Washers
- 4 1/4"-20 Nuts

Secure the fairing brackets to the sideplates leaving the hardware loose so that it can be adjusted during a later step.

Note: Your sideplates may have either holes or slots for this section.

Note: The pressed in nuts face the front of the vehicle as noted by the arrow.

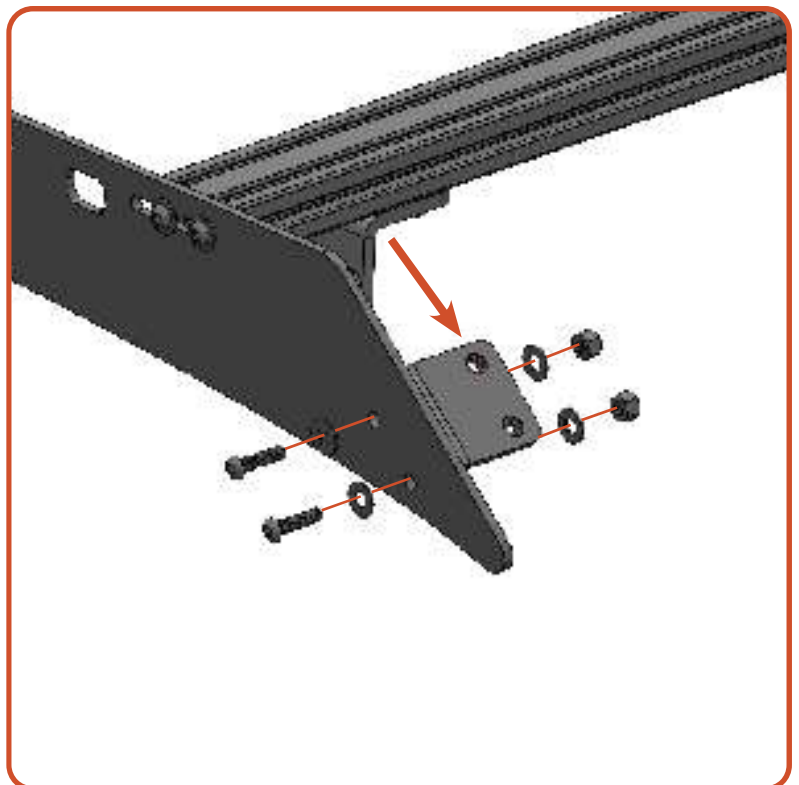

03 CROSSBAR HARDWARE

Required Components:

- 2 Tnuts
- 2 1/4"-20x1/2" Socket Bolts
- 2 1/4" Flat Washers

Insert Tnuts into the bottom of the front crossbar assembly.

Install the screws/washers leaving them loose so that braces can be installed during a later step.

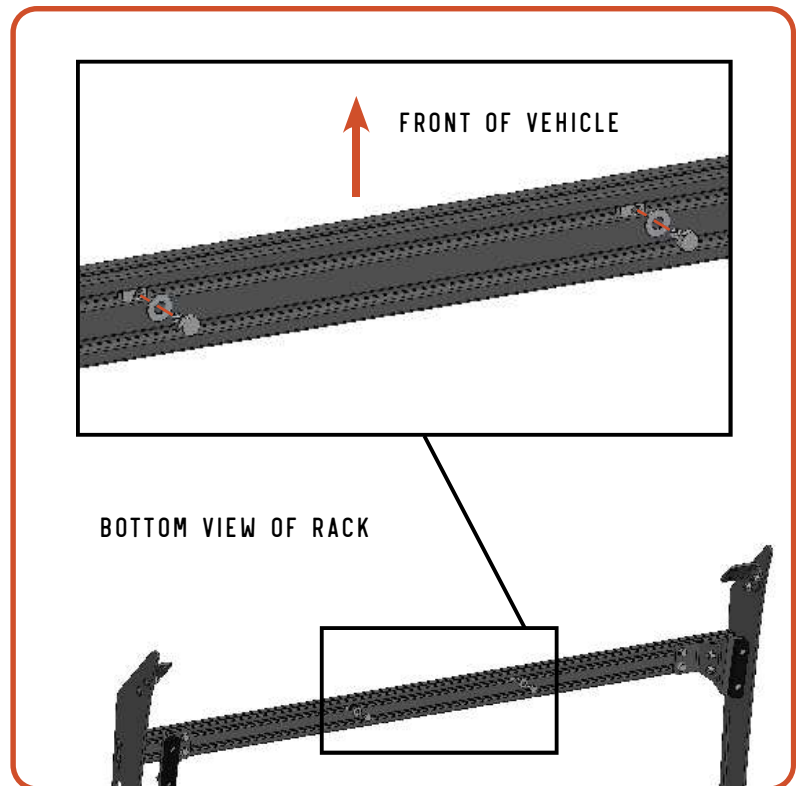

03 ALIGN FAIRING

Position the wind fairing onto the vehicle aligning the braces to the loose screws

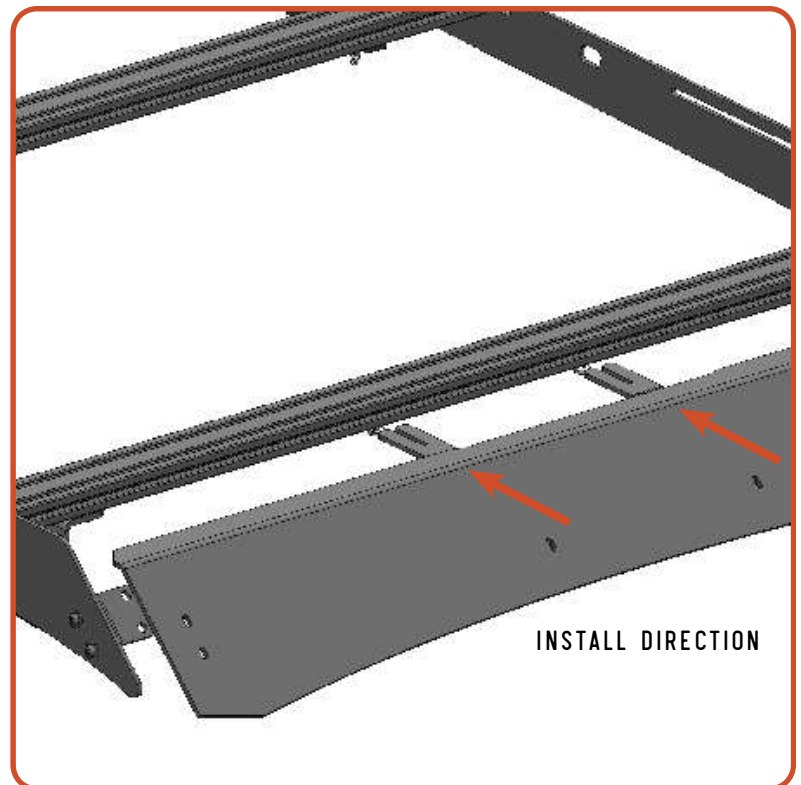

04 MOUNT FAIRING

Required Components:

4 1/4"-20x1" Socket Bolts

4 1/4" Flat Washers

Align the bottom of the fairing with the tip of the roof rack and secure it using bolts and washers.

Tighten all fairing hardware in addition to brace hardware from earlier steps.

The fairing can be adjusted up or down if wind noise is detected. Small adjustments make a big difference here.

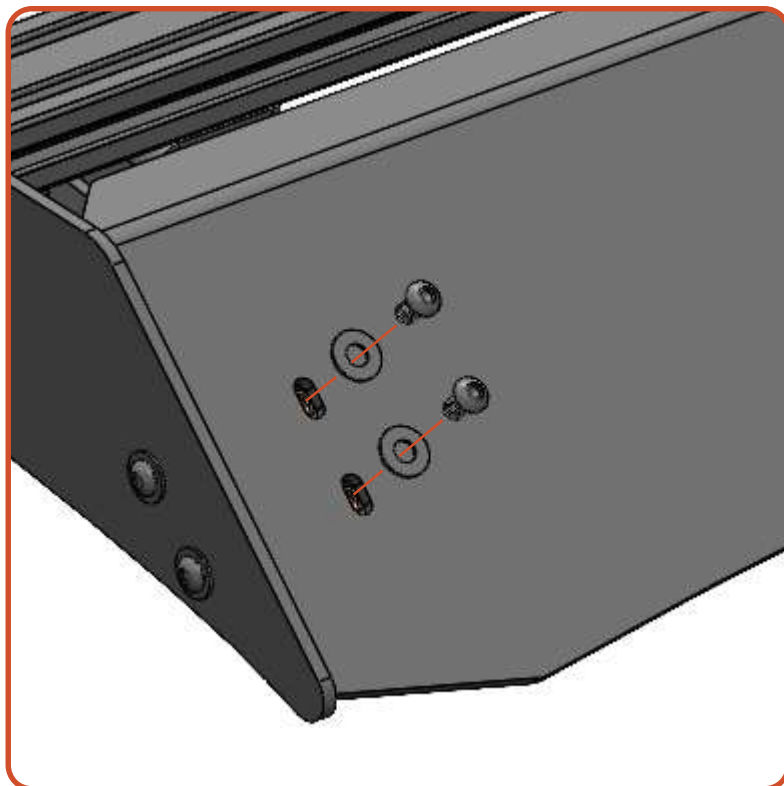

PRE-DRILL FITMENT

01 FITMENT

If mounting brackets do not sit flat in the roof gutter track from the front/rear perspective (pictured to the right), the mounting brackets need to be adjusted along the length of the crossbar. Remember to keep the brackets on each side of the vehicle adjusted the same distance from the end of the crossbar so that the rack is centered.

In the correct image the bracket is moved to the center of the roof gutter ensuring that it sits flush.

REAR VIEW

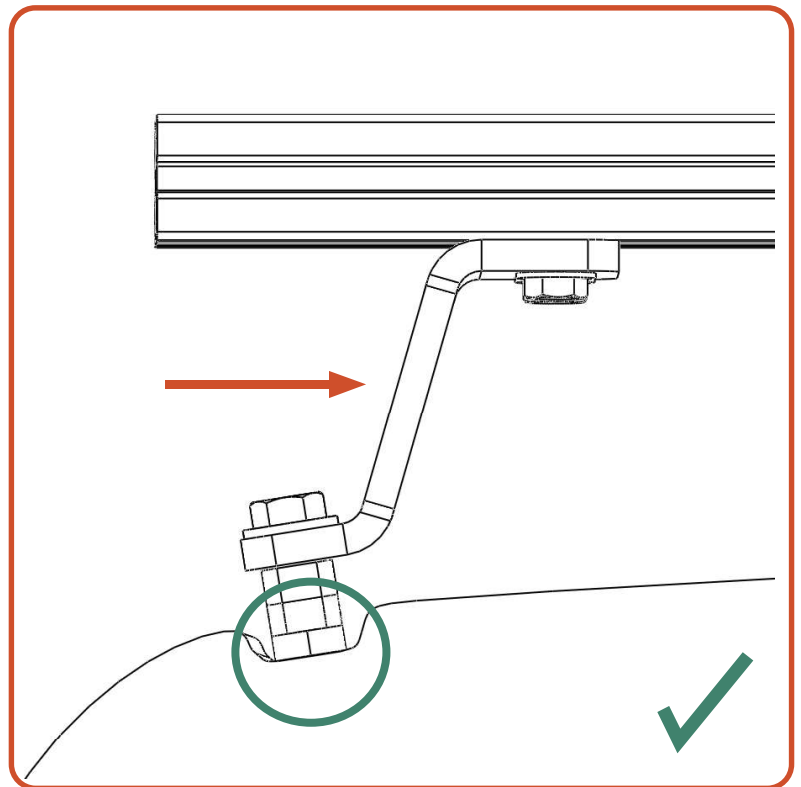
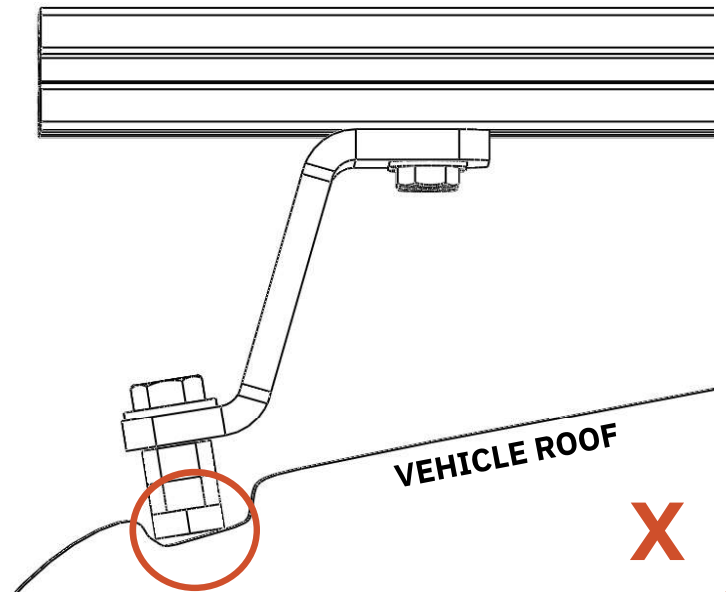

02 FITMENT

If the mounting brackets do not sit flat in the roof gutter from a side perspective, they need to move along the length of the roof gutter (towards or away from the front of the vehicle).

If the sideplates match the curvature of the roof but the mount does not sit flat, then the crossbar should be adjusted in the slot. This allows the mount position to move without changing the placement of the side plate.

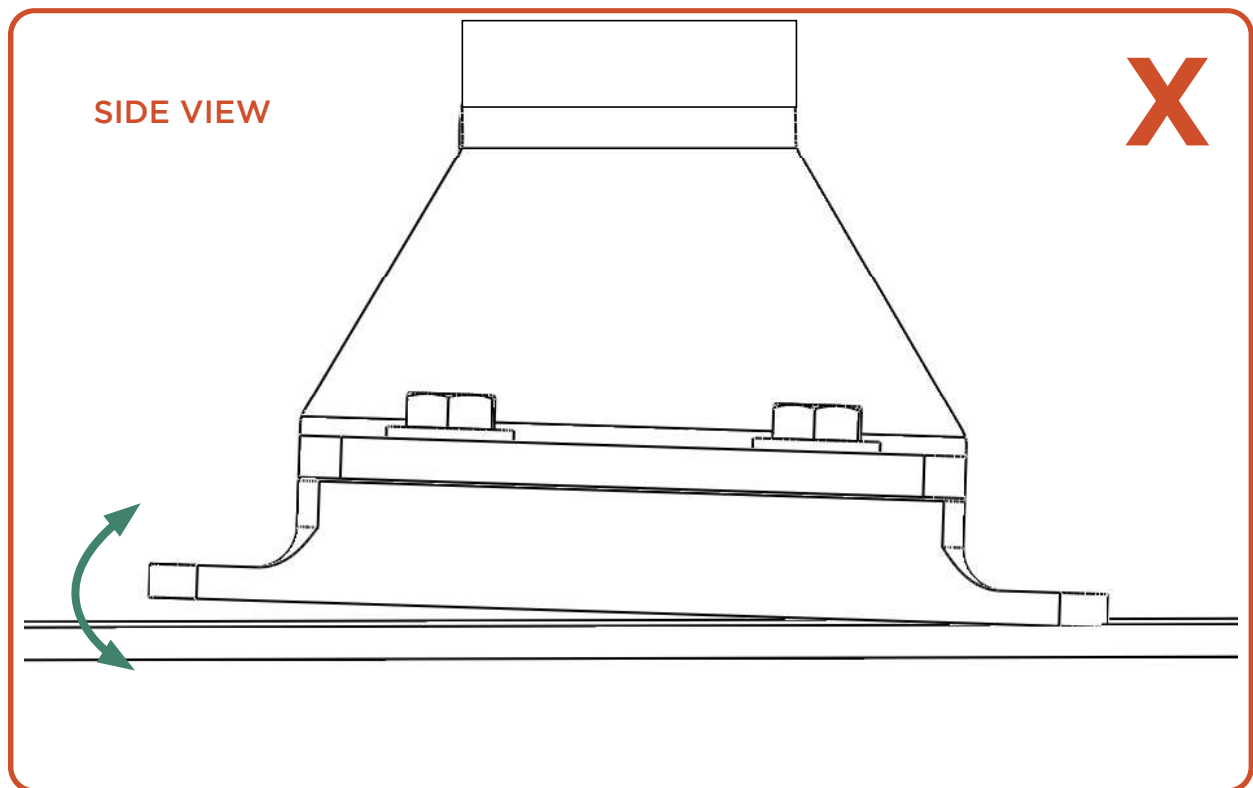

INSTALLATION

01 DRILLING

Required Components:

- 1 13/64" Center Punch
- 1 13/64" or #8 Drill Bit

With the rack on the truck, mark the position for each rivet spacer using a 13/64" center punch. A smaller punch may be used, but there is a higher chance that it will not be centered in the hole. This step is critical because it prevents the drill from walking while drilling your pilot holes. The position of the holes are important as they locate the rack on your vehicle. Measure 3 times and check 4 times. Be extremely careful not to drill through you airbags - using a drill-stop on your drill bit can help prevent this by limiting the travel of the drill bit.

With the holes marked, the rack can be removed from the roof. It is worth double checking that the rack sits in its final configuration before marking, removing, and drilling. The rivet spacers can also be removed from the mounting brackets on the rack to assist the following steps.

Once you have your drilling points marked with the punch, drill the hole using a 13/64" or #8 drill bit. DO NOT allow the drill bit to plunge after the hole is drilled. The headliner is only a small distance below the surface of the roof. Be sure to keep the drill bit as straight as possible while drilling.

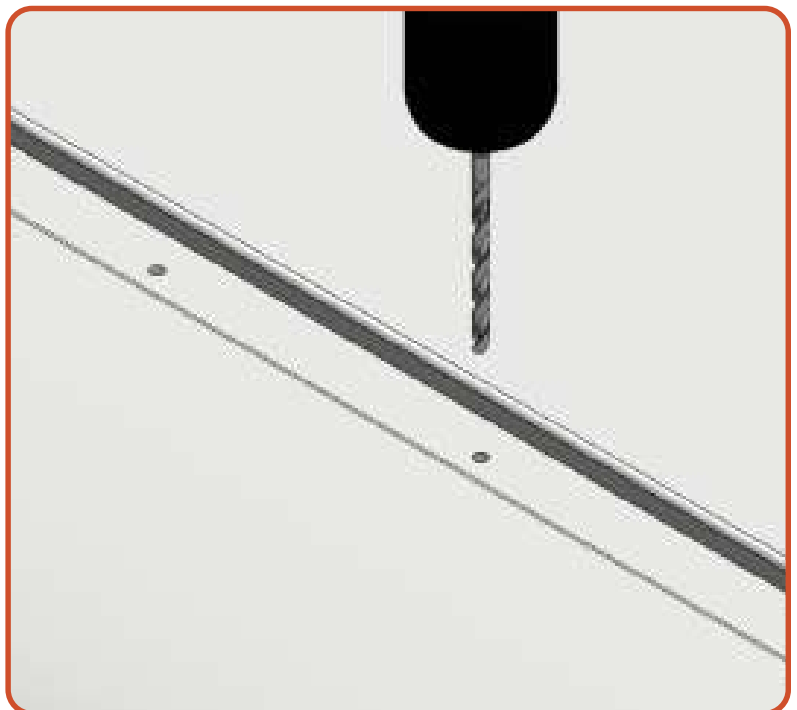
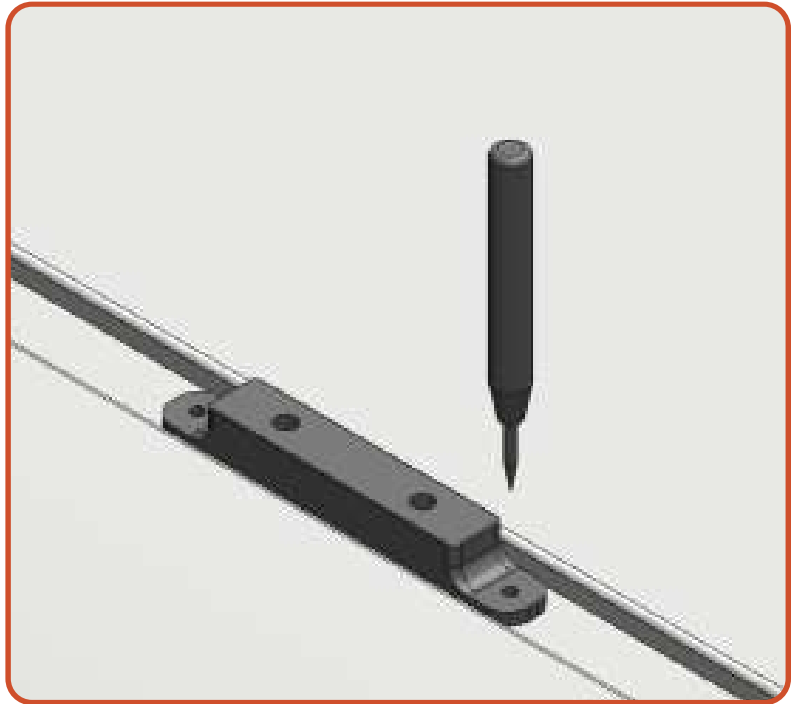

02 DRILLING

Check that the rivets will pass through the rivet spacer and the drilled hole. A tight fit is preferred which strengthens the connection between the vehicle and the rack.

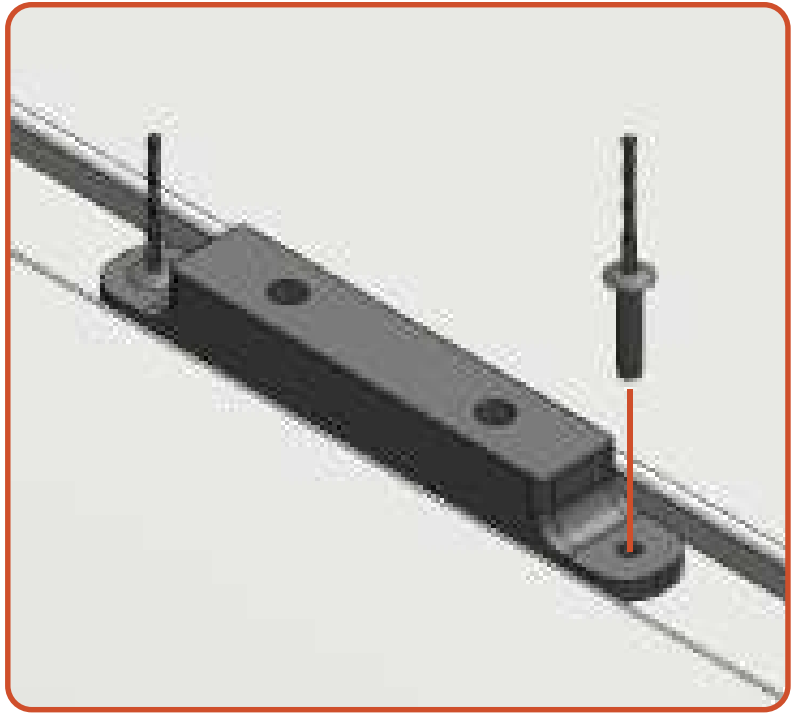

03 RIVETS

Required Components:

8 3/16" Rivets

1 Rivet Tool

Secure the rivet spacers using the holes drilled. It is important that spacer is tight against the roof and free of debris before riveting. **Apply a small amount of silicone in and around the rivet spacer and the rivet to seal the hole in the roof.** Using the rivet tool, clamp down on the rivet as close to the head as possible. The mandrel of the rivet will shear off once it is installed and should be flush with the head.

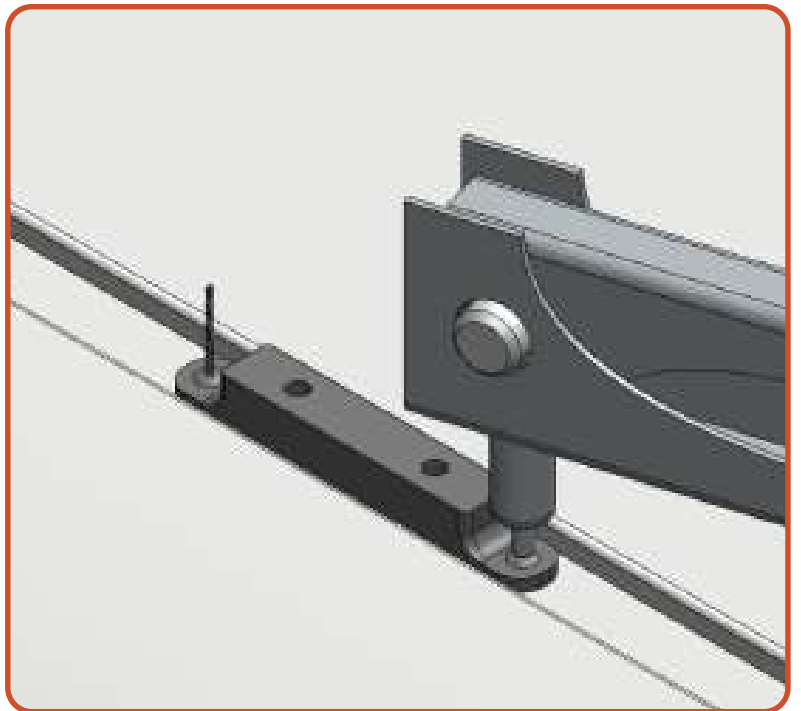

04 MOUNTS

Required Components:

8 M8 x 16mm Bolts

8 M8 Flat Washers

Reinstall the assembled rack on the roof, allowing the mounting brackets to rest on the rivet spacers. If these do not line up, loosen the hardware that secures the mounting bracket to the crossbar and adjust as needed. Fasten the mounting bracket to the rivet spacer using the M8 bolts, M8 washers, and the included blue threadlocker. **The bolts only need a drop of threadlocker.** It will be difficult to remove the bolts in the future if an excessive amount of threadlocker is used.

Once satisfied with the racks placement on the vehicle, tighten the hardware on the crossbars and the mounting brackets.

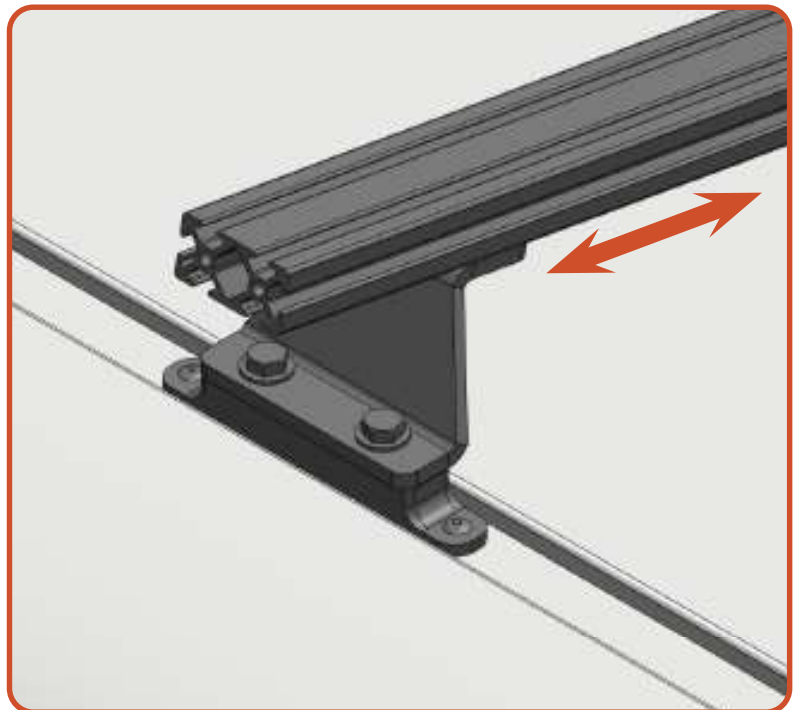
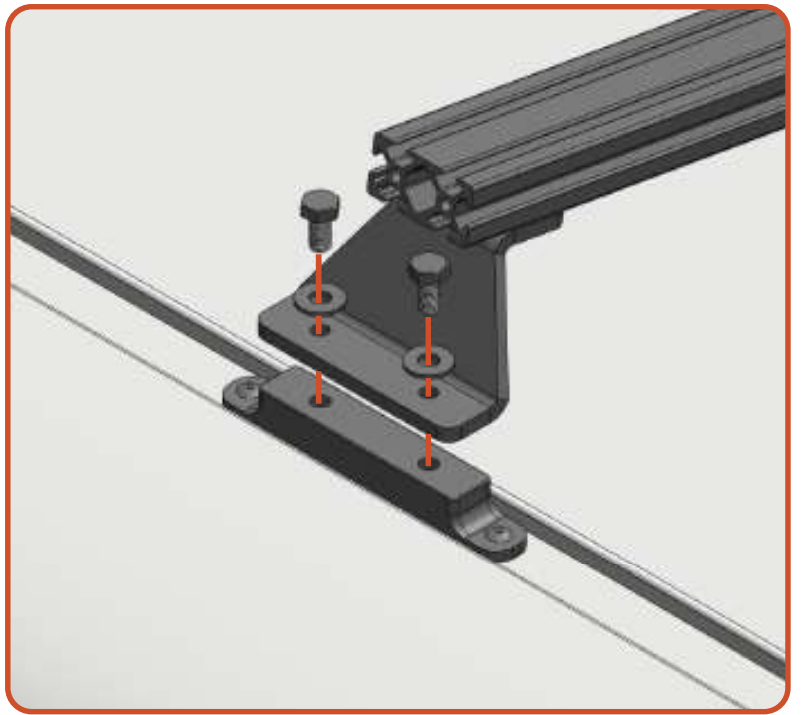

FINAL ASSEMBLY

CROSSBARS

Required Components:

- 16** 1/4"-20 x 1" Socket Buttons
- 16** 1/4" Flat Washers
- 4** 56" Crossbars

Secure the remaining crossbars to the rack using the 1" socket button screws and 1/4" washers.

Warning: Crossbars should not be placed in the third slot (from the front) if the 'tilt' sunroof function is to be used. The crossbar will interfere with the sunroof as it cycles.

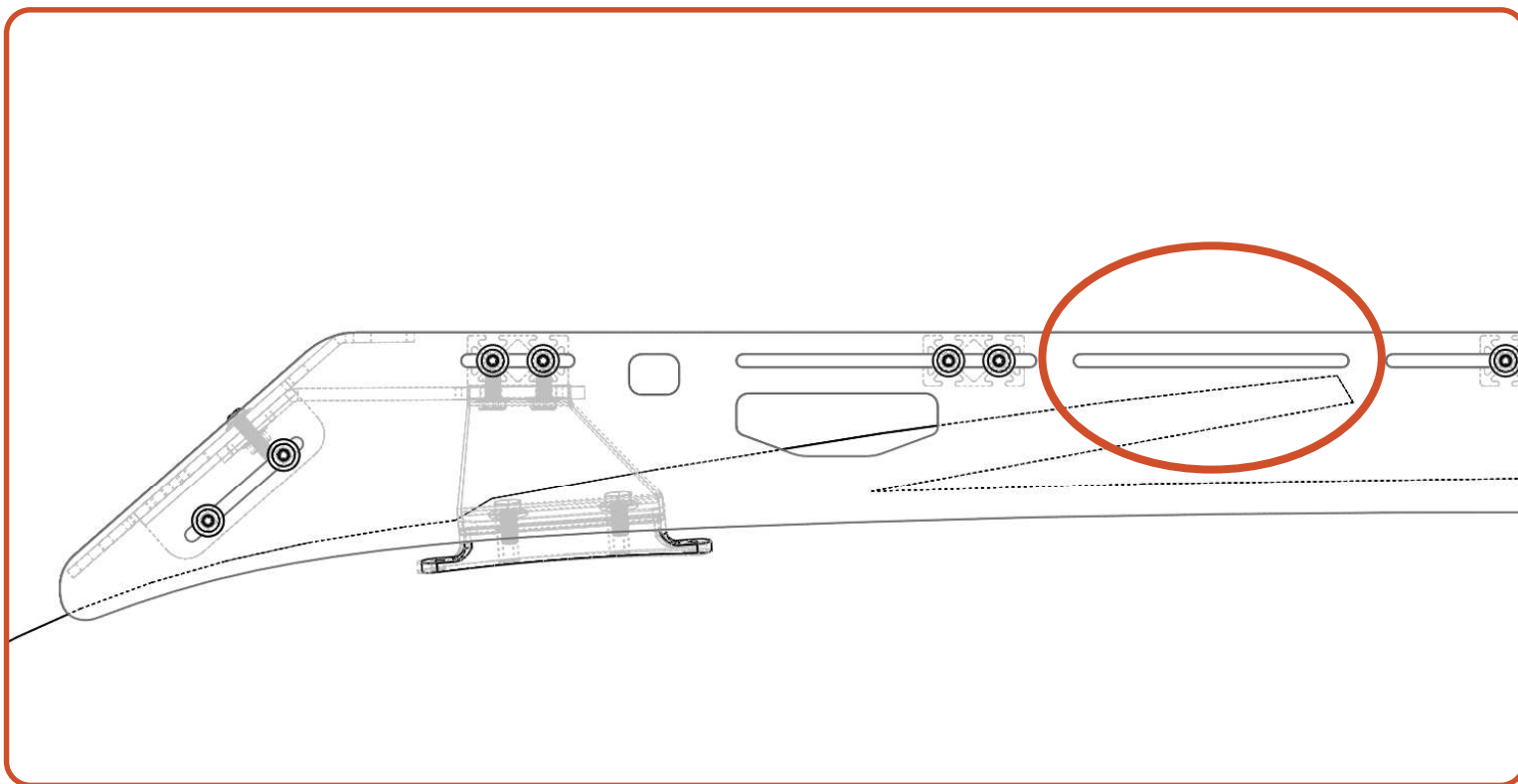

NOW GET OUT THERE AND
EXPLORE.

WELCOME TO THE SHERPA FAMILY!
MAKE SURE TO FOLLOW US ON YOUR SOCIALS AND TAG US IN YOUR ADVENTURES.

All products built and designed by Sherpa Equipment Company are intended for off-road use and should be assembled, installed, and used according to Sherpa Equipment Company's recommendations. Sherpa Equipment Company's products should be used safely with good judgment towards others and surroundings.

By installing Sherpa Equipment Company's products on your vehicle you assume all liability. Sherpa Equipment Company will not be held liable for damages or loss associated with the installation or use of its products. It is recommended that you inspect your roof rack within the first 100 miles of installation and every 500 miles after.