



SHERPA
PREMIUM RACK SYSTEMS

OUTBACK 5G/6G WINDOW PANEL

INSTALL GUIDE

HARDWARE CHECKLIST

1

WINDOW PANEL
(DRIVER OR PASSNGER - VARIES
SLIGHTLY BY GEN)



OUTBACK 5G
2015-2019

6

6

12

OUTBACK 6G
2020-2025+

4

4

8

1/4"-20
NYLOCK NUT

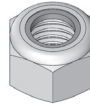

1/4"-20 X 1"
SOCKET BUTTON



1/4" WASHER



2

SUCTION CUPS

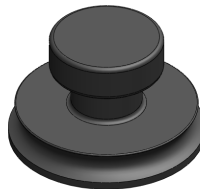

2

RUBBER SPACERS

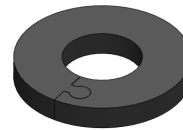

1

SUCTION CUP
STANDOFF

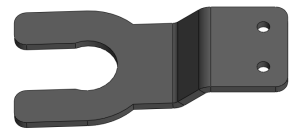

BEFORE YOU START

Installing a window panel can be difficult alone. Getting another person to lend a hand on the install can make the process much easier. The process outlined in these instructions is what Sherpa has found to be the most consistent and direct method for installation. Ensure window is clean prior to installation.

The below assembly images may differ slightly in appearance from actual product.

FOREWARD

The window panel has been designed with a maximum safe load of **15 lbs.** It is the customers responsibility to use discretion when attaching accessories to the window panel so that no damage occurs.

Hardware should be inserted through slots from the glass side of the window panel. When the panel is loaded it will deflect, and hardware that is too close to the window can cause damage.

INSTALL PREP

01 ROTOPAX MOUNT

Note the specific orientation of the Rotopax on your window panel. See the following page on how/where to fasten the mount.

5TH GEN

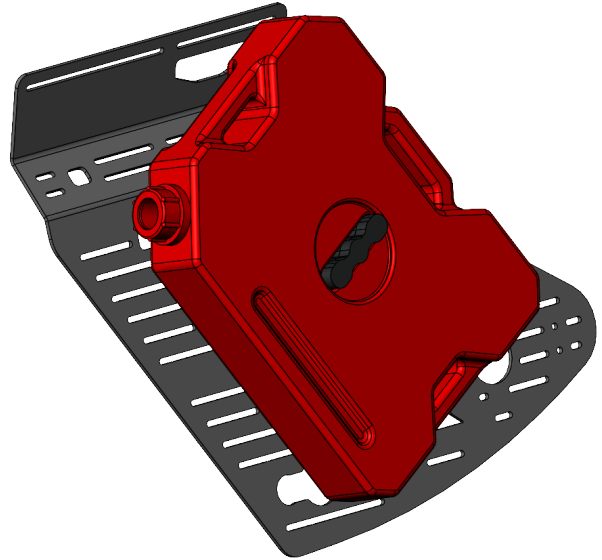

6TH GEN

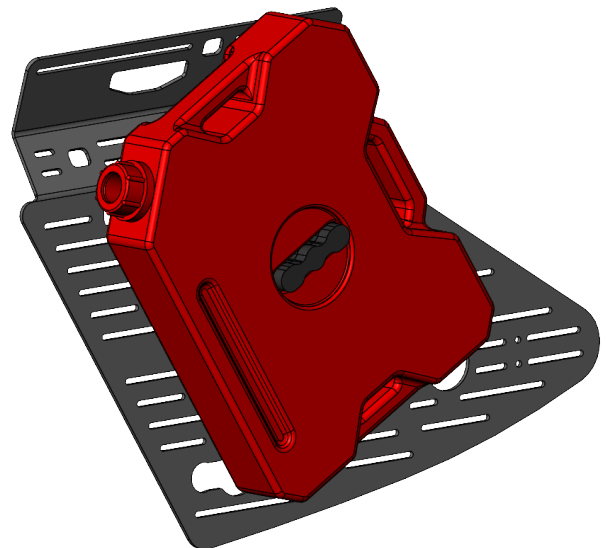

ACCESSORIES

Install all accessories prior to installing the window panel on the rack. Access to the backside of the window panel is limited once it is installed on the vehicle.

All hardware should be installed so that the bolts are inserted from the inside of the window panel and protrude away from the window. Factory rotopax mounts must be removed from baseplate, as shown below, before attaching to window panels. Accessories and hardware shown below are not included.

Instructions for installing other common accessories on the panel can be found on the [Sherpa EC Website](#).

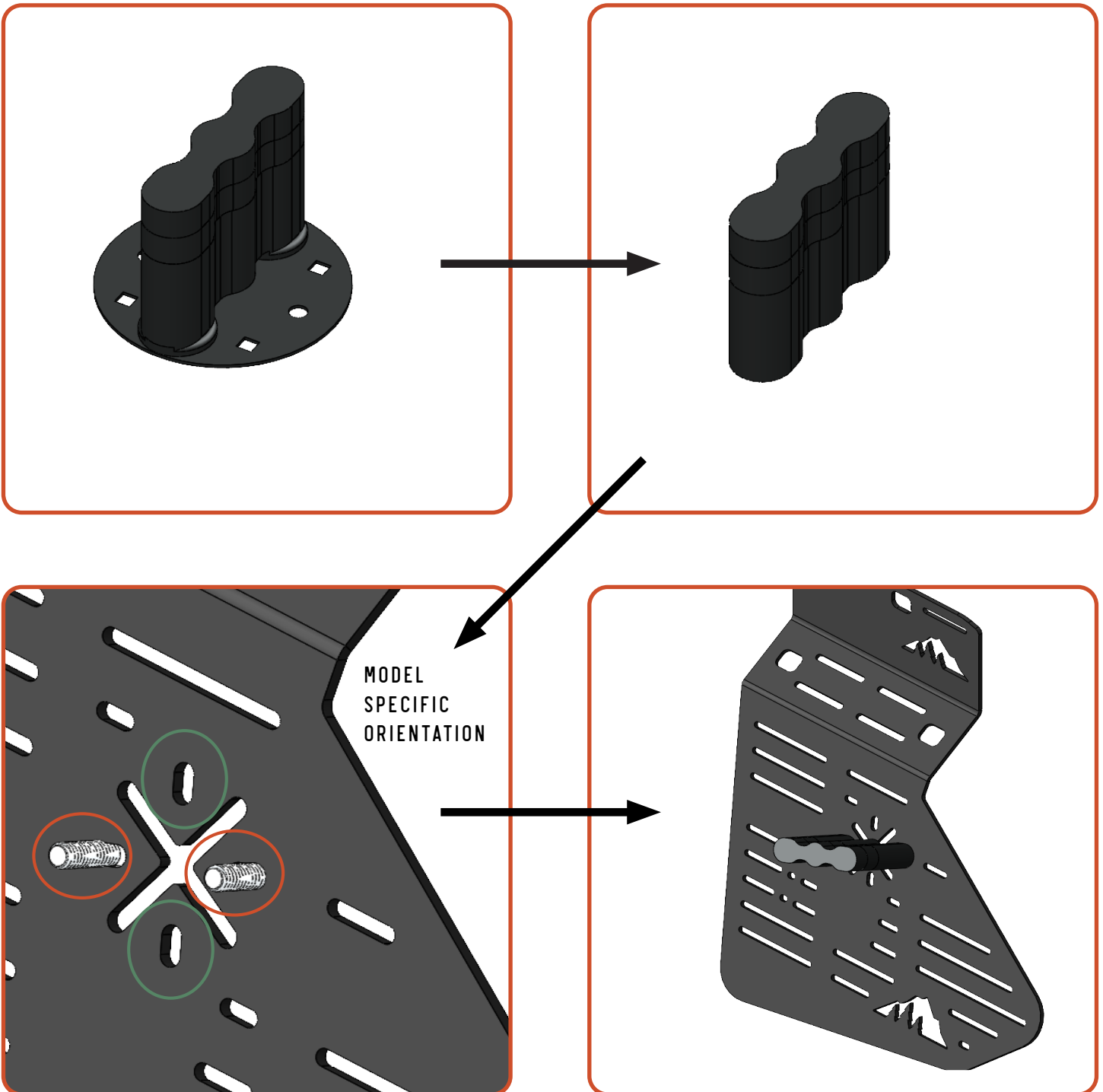

INSTALL PREP

INSTALL PREP 01

Required Components:

- 1 Suction Cup
- 1 Rubber Spacer
- 1 Suction Cup Standoff

Split the ends of the rubber spacer and wrap it around the neck of the suction cup. Insert the neck of the suction cup into the suction cup standoff with the rubber spacer above the standoff.

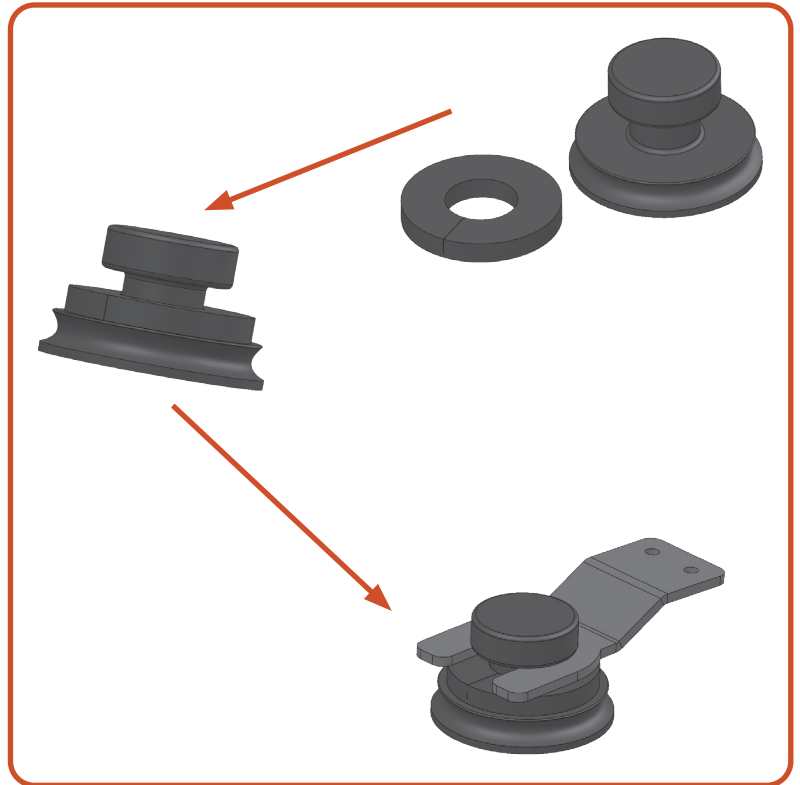

INSTALL PREP 02

Required Components:

- 2 1/4-20 x 1" SB Bolts
- 2 Nylock nuts
- 4 1/4" Flat Washers

Using the two small holes near the large one, fasten the suction cup standoff to the backside of the window panel. The suction cup should be centered in the large hole of the window panel.

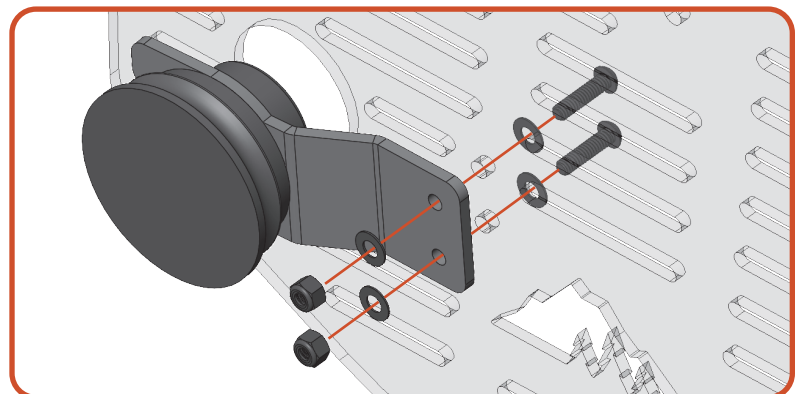
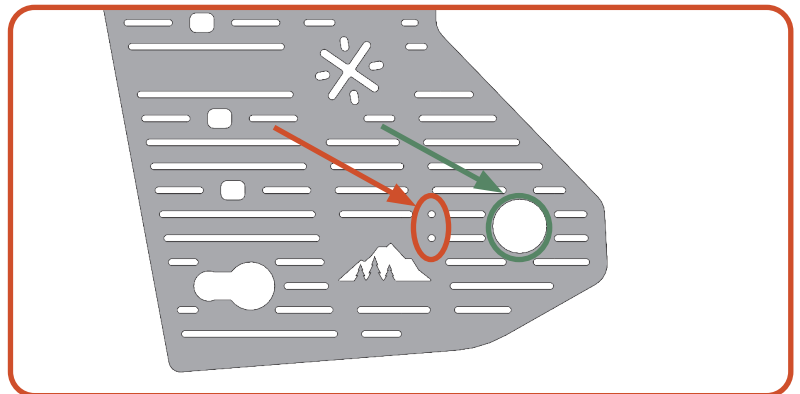

INSTALL PREP 03

Required Components:

All Suction Cup(s)

All Rubber Spacer(s)

Place the rubber spacer on the remaining suction cup(s). Insert the suction cup through the back side of the window panel keeping the rubber spacer on the backside of the window panel. Slide the neck of the suction cup in the slot so that it locks into place.

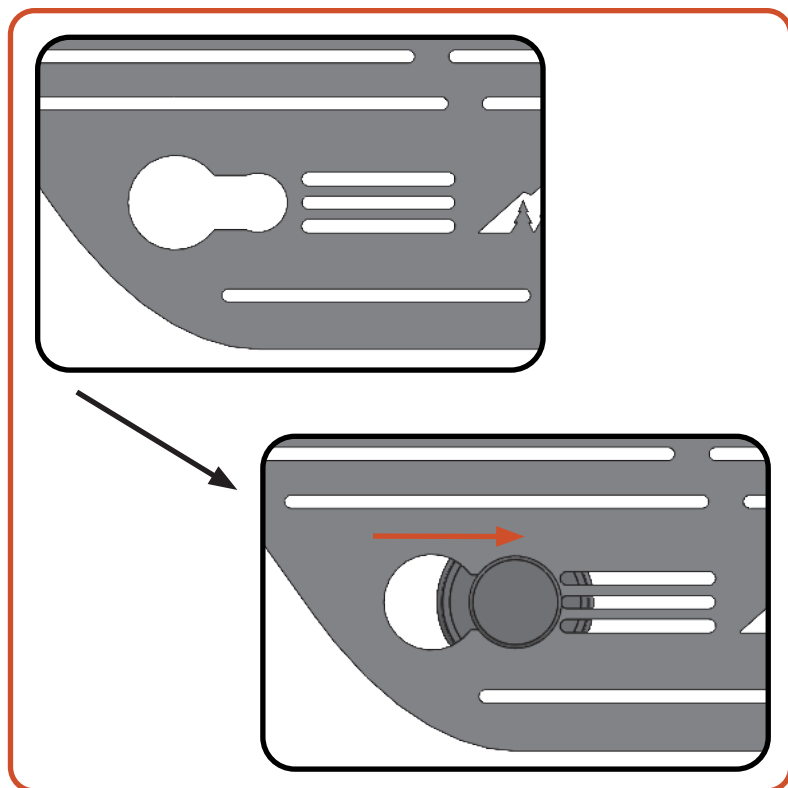

INSTALLATION

INSTALL 01

Required Components:

4 1/4"-20 x 1" SB Bolts (Some may come from rack)

As Needed 1/4"-20 Nylock Nuts

As needed 1/4" Flat Washers

Align the window panel with similar features in the sideplate (grab handle, tie down, etc).

Depending on configuration, the window panel may be attached through the sideplate to a crossbar and/or secured with included nylock nuts.

Note: Use 4x or more total bolts in all installations.

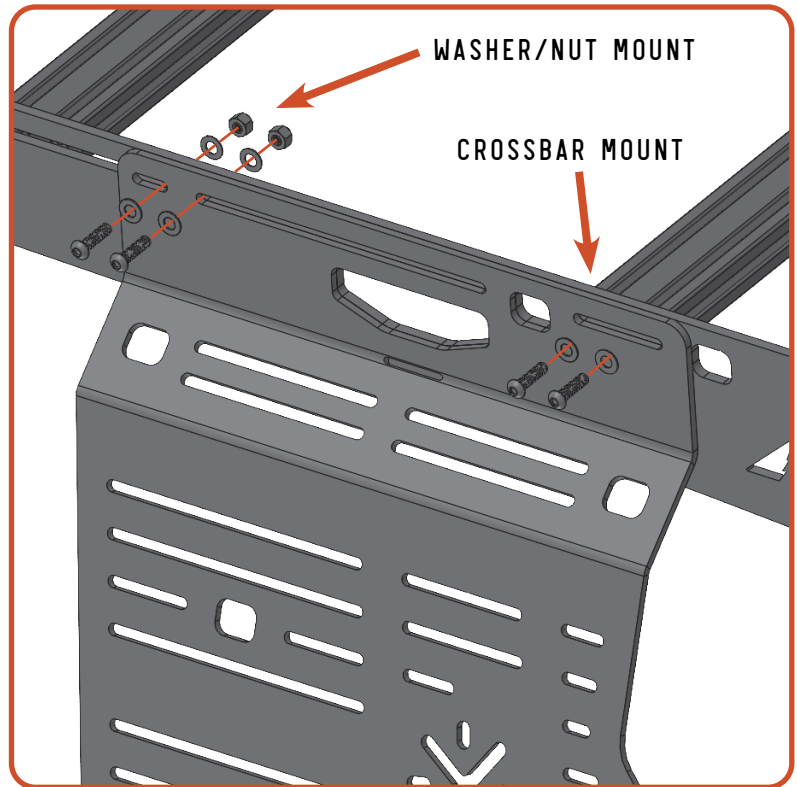

INSTALL 02

Apply pressure to the suction cup area to seal and secure them to the window.

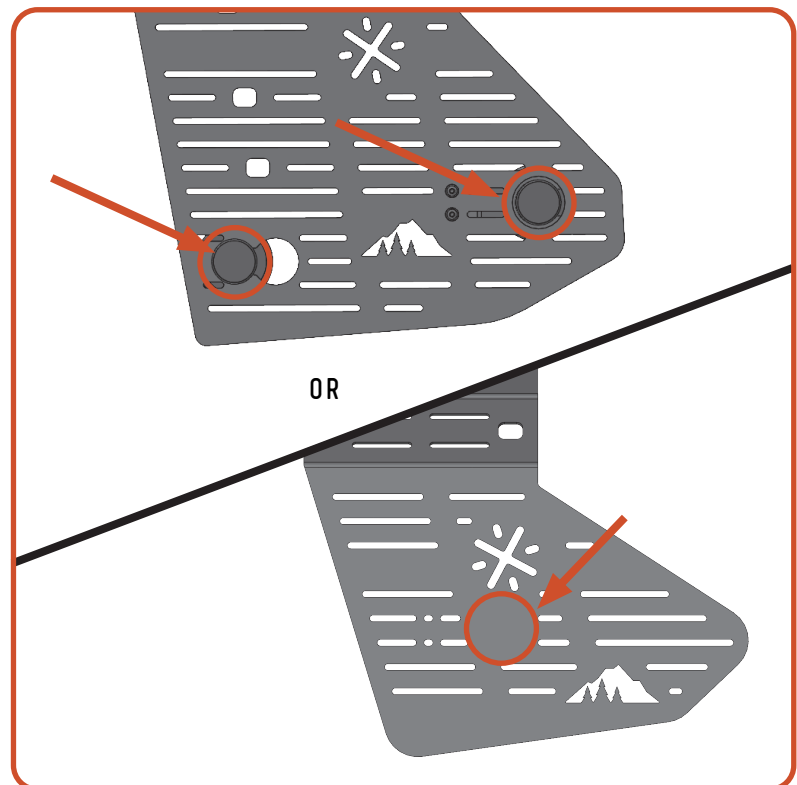

NOW GET OUT THERE AND
EXPLORE.

WELCOME TO THE SHERPA FAMILY!
MAKE SURE TO FOLLOW US ON YOUR SOCIALS AND TAG US IN YOUR ADVENTURES.

All products built and designed by Sherpa Equipment Company are intended for off-road use and should be assembled, installed, and used according to Sherpa Equipment Company's recommendations. Sherpa Equipment Company's products should be used safely with good judgment towards others and surroundings.

By installing Sherpa Equipment Company's products on your vehicle you assume all liability. Sherpa Equipment Company will not be held liable for damages or loss associated with the installation or use of its products. It is recommended that you inspect your roof rack within the first 100 miles of installation and every 500 miles after.