



INSTALLATION GUIDE

SPRINTER 170" REAR PANEL STORAGE LOCKERS

SP1125B + SP1126B



TOOLS REQUIRED (NOT INCLUDED)

- | | |
|-------------------|-------------------------------|
| + TAPE MEASURE | + PAINT |
| + MARKER | + 10MM Wrench |
| + POWER DRILL | + 8MM Wrench |
| + 7/32" DRILL BIT | + 3MM Allen Wrench |
| + CENTER PUNCH | + 2.5MM Allen Wrench |
| + HAMMER | + DIE GRINDER (optional) |
| + STEP BIT | + ANGLE GRINDER or BODY SAW |
| + METAL FILE | + METAL CUTOFF WHEEL or BLADE |
| + MASKING TAPE | |

INSTALL INFO

TIME TO INSTALL THIS PRODUCT: 3-4 HOURS

Additional help is suggested for a few of the install steps.

BEFORE YOU START

Please inspect the product and packaging upon delivery to ensure there are no issues and that all parts and hardware are accounted for.

Contact us ASAP if anything is missing at:
support@flatlinevanco.com

BEFORE YOU START

All Flatline Van Co products must be properly assembled and secured before attaching to your vehicle. Improper attachment could result in an automobile accident, and could cause serious bodily injury or death to you or to others involved. You are responsible for assembling and securing Flatline Van Co products to your vehicle, checking the mounting points and attachments prior to use, and regularly inspecting the products for wear and or damage. We always recommend you use a professional to install any aftermarket accessories to your vehicle. If you have no mechanical experience and are not thoroughly familiar with the installation procedures, you must have the product installed by a professional installer or other qualified persons. The responsibility is yours and must be taken seriously for everyone's safety.



PACKAGE CONTENTS

DRIVER SIDE

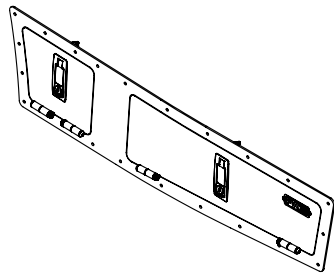

DOOR FRAME ASSEMBLY

QTY: 1

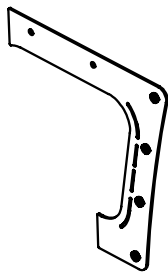

BACKING PLATE 1

QTY: 1

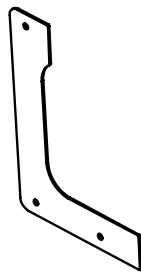

BACKING PLATE 2

QTY: 1

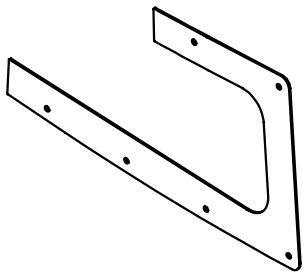

BACKING PLATE 3

QTY: 1

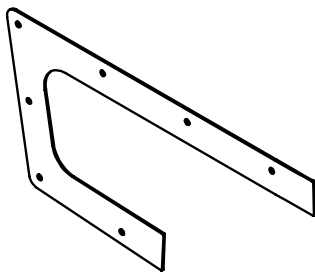

BACKING PLATE 4

QTY: 1

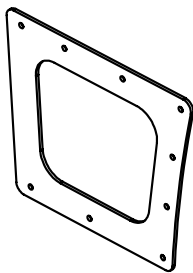

GASKET 1

QTY: 1

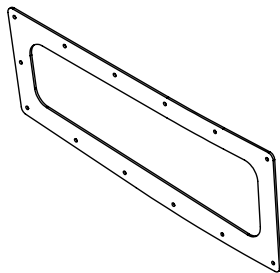

GASKET 2

QTY: 1

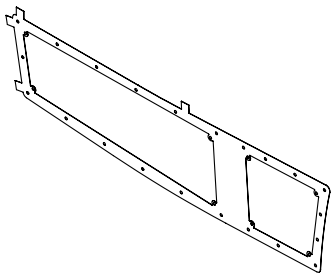

CUT/DRILL TEMPLATE

QTY: 1

PACKAGE CONTENTS

PASSENGER SIDE

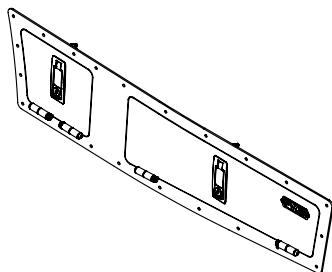

DOOR FRAME ASSEMBLY

QTY: 1

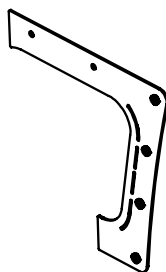

BACKING PLATE 1

QTY: 1

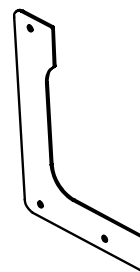

BACKING PLATE 2

QTY: 1

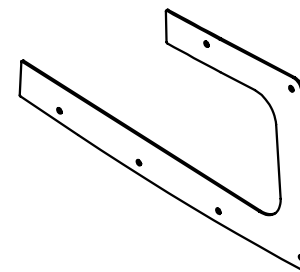

BACKING PLATE 3

QTY: 1

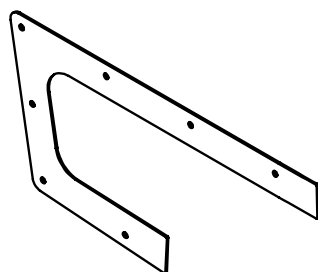

BACKING PLATE 4

QTY: 1

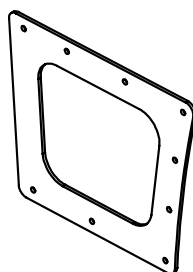

GASKET 1

QTY: 1

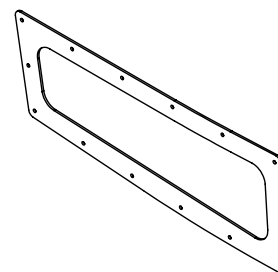

GASKET 2

QTY: 1

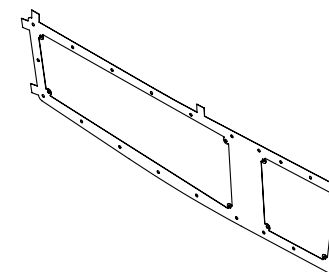

CUT/DRILL TEMPLATE

QTY: 1

HARDWARE



M5 SCREW X 15 O.D. FLAT
WASHER

QTY: 20



M5-0.8 NYLON LOCKNUT

QTY: 20



M5-0.8 X 20 BUTTON HEAD
HEX DRIVE SCREW

QTY: 20

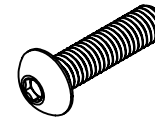

M5-0.8 X 12 BUTTON HEAD
HEX DRIVE SCREW

QTY: 8

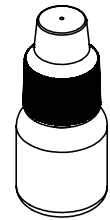

THREADLOCKER

QTY: 2

INSTALL

STEP | 01 LAYOUT AND INSTALL PREP

1.1 Clean Up: Start by cleaning the rear panels of any dirt and debris.

1.2 Template Alignment: Use tape to line up the template tabs to the plastic body panels. Visualize how the locker will fit on the van and make adjustments as necessary (**FIG 1**).

1.3 Tape Perimeter: Tape the perimeter of the template, leaving drill holes exposed. Mark all holes with a sharpie (**FIG 1**).

1.4 Cutting Path: Trace around the inside of the template to mark the cutting paths. Ensure the template is flat against the van (**FIG 2**).

1.5 Remove Template: Carefully remove the template. You should be left with markings as shown in (**FIG 2**).

NOTE - All figures depict driver side installation. The passenger side follows the same steps, just mirrored.

TOOLS REQUIRED FOR THIS STEP: + TAPE MEASURE
+ MARKER
+ MASKING TAPE



FIG 1

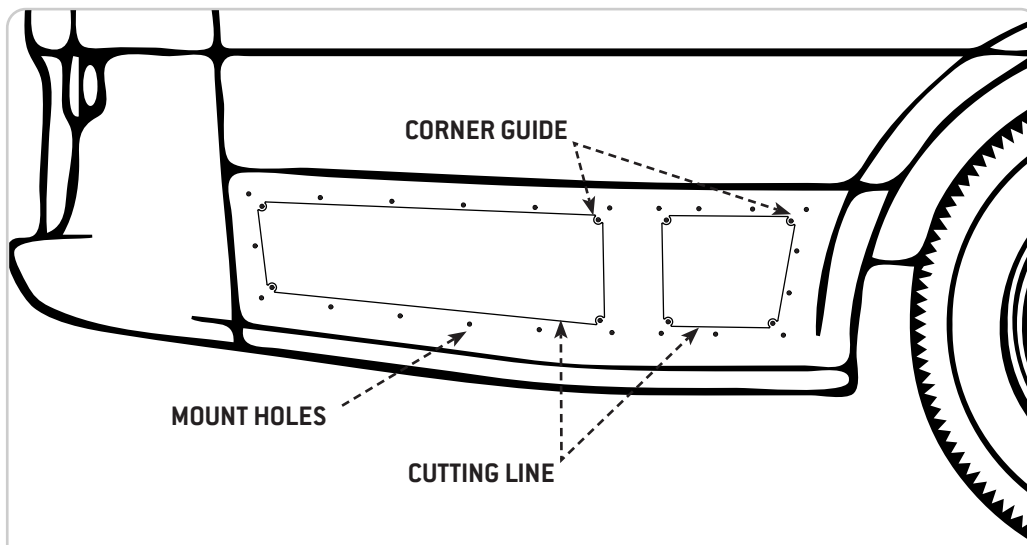

FIG 2

STEP | 02 DRILLING MOUNT HOLES

2.1 Center Punch: Lightly center punch holes using a Center Punch (FIG 3,4).

2.2 Drilling: Drill out holes using a 7/32" Drill Bit (FIG 5).

NOTE - Be sure to only drill through one layer of sheet metal.

TOOLS REQUIRED FOR THIS STEP:

- + POWER DRILL
- + 7/32" DRILL BIT
- + CENTER PUNCH
- + HAMMER



FIG 3



FIG 4

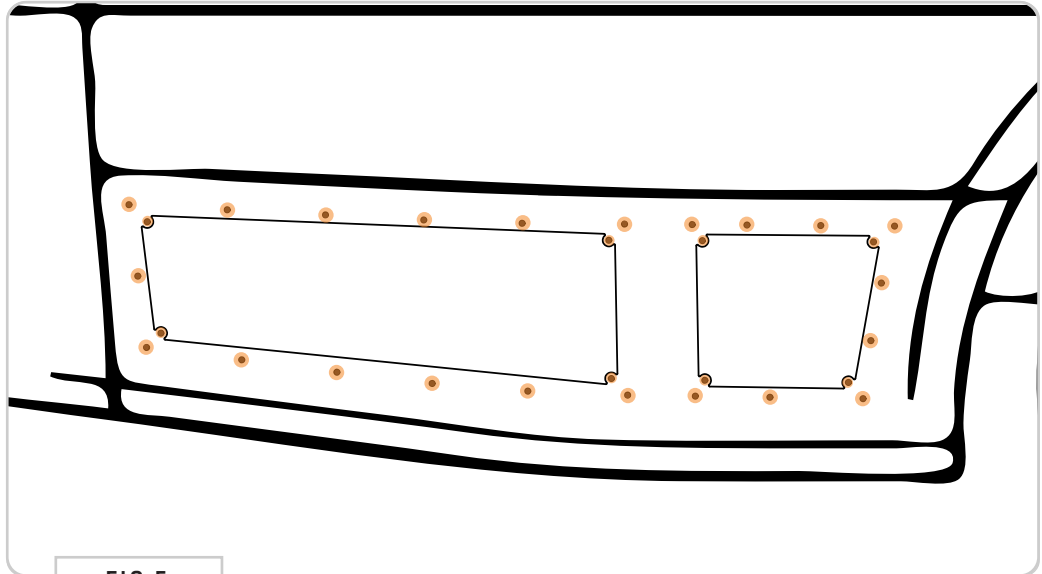

FIG 5

STEP | 03 CUTTING PANELS

3.1 Corner Guides: Drill out corner guide holes with a step bit to 1/2" using the traced arch of the cutting line as a visual guide (**FIG 6,7**). This will serve as your corner guide when cutting out the panels.

3.2 Body Saw: Use a body saw or angle grinder with a metal cutting wheel to cut the top and bottom horizontal lines of the panels first (**FIG 8**). Proceed to cut the left and right sides. Carefully hold the opposite end of metal on the last cut to stabilize.

NOTE - Be sure to only be cutting through one layer of sheet metal during this process. Be extra careful around the center lines as there is a structural pillar that runs through the compartment.

NOTE - We recommend using a pneumatic or electric saw for this step. We like the Astro Pneumatic Tool 930 Air Body Saber Saw, but most saws with metal-cutting blades will work.

TOOLS REQUIRED FOR THIS STEP:

- + POWER DRILL
- + STEP BIT (MARKED AT 1/2")
- + BODY SAW OR ANGLE GRINDER
- + METAL CUTOFF WHEEL OR BLADE



FIG 6



FIG 7

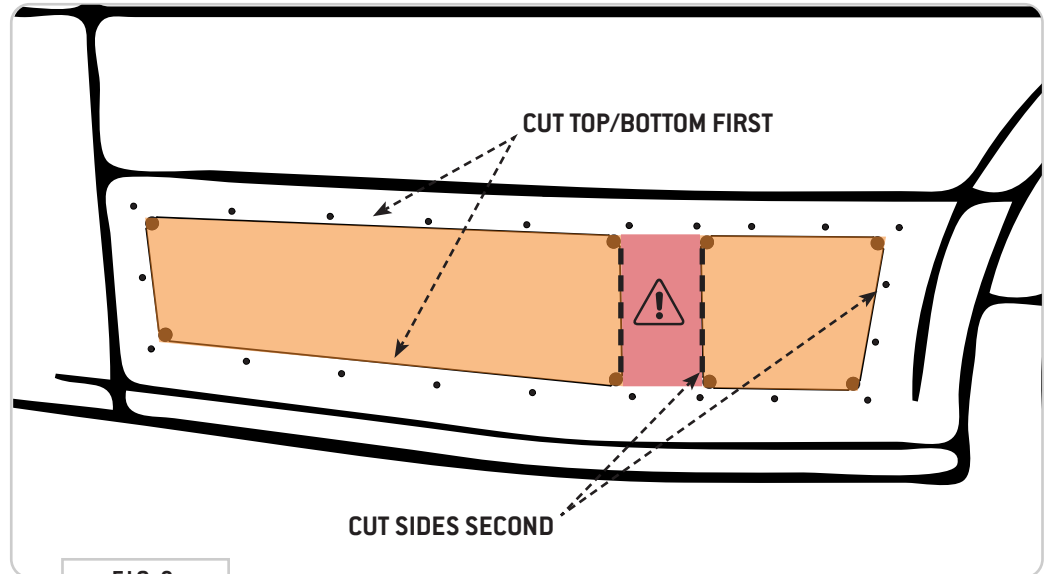

FIG 8

STEP | 04 DEBURR AND CLEANUP

4.1 Deburr and Cleanup: Deburr the newly cut hole and clean up shavings inside compartment (FIG 9).

NOTE - If you find that the cut is uneven, you can clean up the edge with a die grinder.

4.2 Mask Van Body: Remask perimeter with tape (FIG 10).

4.3 Rust Prevention: Paint raw edges of drill holes and cut lines with rust preventative paint (FIG 11).

PRO-TIP: Optionally, wipe down and paint the inner compartment in a well-ventilated area (FIG 12).

TOOLS REQUIRED FOR THIS STEP:

- + METAL FILE
- + MASKING TAPE
- + PAINT



FIG 9



FIG 10



FIG 11



FIG 12

STEP | 05 LOCKER ASSEMBLY

5.1 Gather Components: Gather the face plate, gasket, and backer plates (FIG 13).

5.2 Mount Face Plate: Insert **M5-0.8 X 20 Button Head Hex Drive Screws** along the top edge to hold the door against the van body.

5.3 Gasket Placement: Place the Gasket onto bolts from the *inside compartment* (FIG 14).

5.4 Install Backer Plates: Loosely install backer plates with **Washers And Nuts** (FIG 15).

5.5 Alignment: If there's an alignment issue, drill out holes as needed (avoid backing plates). Use **Loctite** on screws that attach to pem nuts (FIG 16).

5.6 Assembly: Apply pressure to flex the assembly into place when tightening screws. Tighten nuts with an **8mm Wrench** and **2.5mm Allen Wrench** until snug.

TOOLS REQUIRED FOR THIS STEP: + 8MM Wrench
+ 2.5MM Allen Wrench

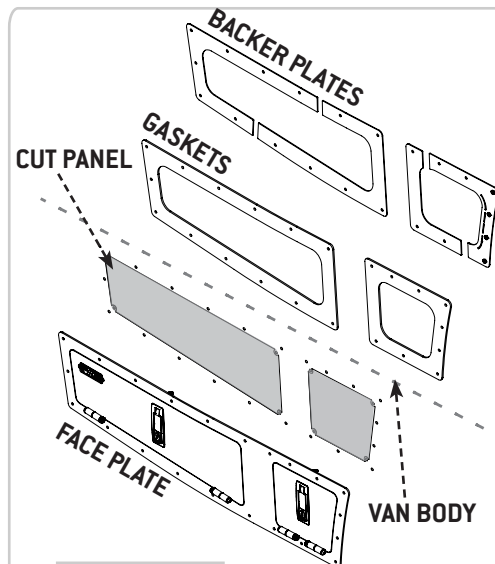

FIG 13



FIG 14

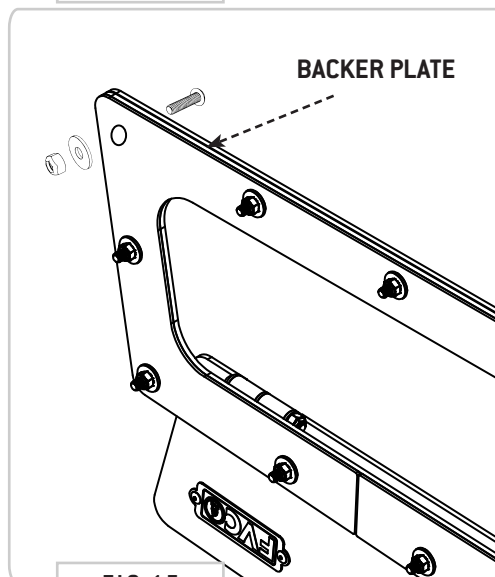

FIG 15

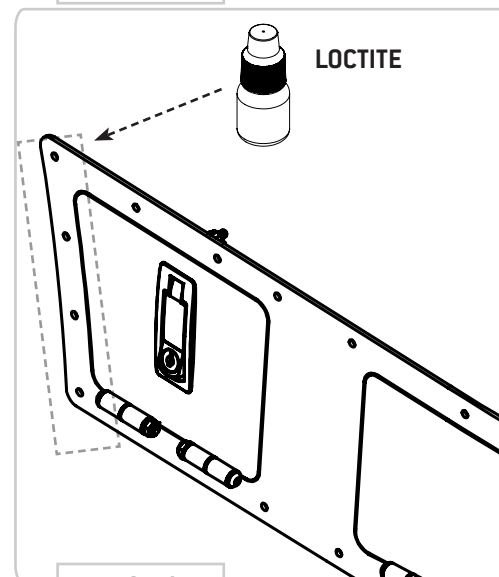

FIG 16

TOOLS REQUIRED FOR THIS STEP: + 10MM Wrench
+ 3MM Allen Wrench

STEP | 06 ADJUSTMENTS AND TUNING

6.1 Latch Compression: Using a **10MM Wrench**, loosen the **Jam Nut** (FIG 17) to adjust the **Compression Bolt** and retighten the nut when adjustment is complete.

NOTE - Screw the bolt out to increase seal compression and screw the bolt in to decrease seal compression.

6.2 Hinge Bolts: The hinges can be adjusted using a **10MM Wrench** and **3MM Allen Wrench**. Tighten the **Hinge Pivot Bolt** to increase torque, loosen **Hinge Pivot Bolt** to decrease torque (FIG 17).

NOTE - Remember to repeat each of these steps for the passenger side install.

Your Rear Storage Locker is now ready for action! Happy travels!

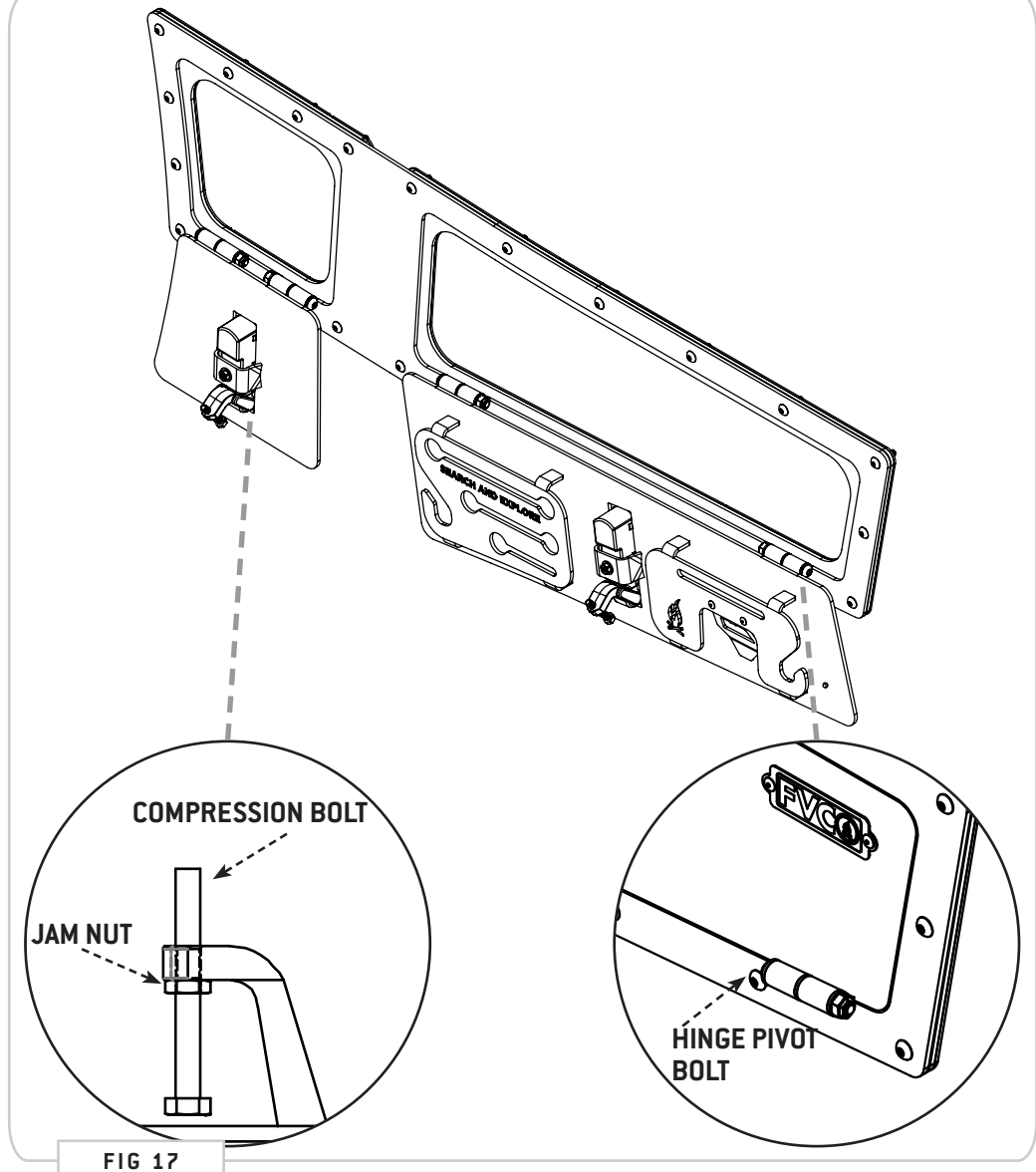

GET OUT AND EXPLORE!

+ LEAVE US A REVIEW

Happy with your new FVC product? We would love to hear (and see) from you! Head to the product page and click "Leave Review." Add a short review and upload a few photos to be showcased on the product page.

+ SHARE YOUR PICS

We love seeing how our customers use their FVC products and following along with your adventures. Tag us in your photos with: @flatlinevanco or send them to us via email. We love posting customer pictures in our feed!

+ NEED ANY HELP?

If you are having any issues with your product, please reach out, and we will make it right. FVC is a company of van and outdoor enthusiasts that design and use our own products, so we want you to be as stoked on your new parts as we are!



@FLATLINEVANCO



INSTALLATION GUIDE

SPRINTER PANEL STORAGE LOCKER

SP1123B + SP1124B



TOOLS REQUIRED (NOT INCLUDED)

- | | |
|-------------------|-------------------------------|
| + TAPE MEASURE | + PAINT |
| + MARKER | + 10MM Wrench |
| + POWER DRILL | + 8MM Wrench |
| + 7/32" DRILL BIT | + 3MM Allen Wrench |
| + CENTER PUNCH | + 2.5MM Allen Wrench |
| + HAMMER | + DIE GRINDER (optional) |
| + STEP BIT | + ANGLE GRINDER or BODY SAW |
| + METAL FILE | + METAL CUTOFF WHEEL or BLADE |
| + MASKING TAPE | |

INSTALL INFO

TIME TO INSTALL THIS PRODUCT: 2 HOURS

Additional help is suggested for a few of the install steps.

BEFORE YOU START

Please inspect the product and packaging upon delivery to ensure there are no issues and that all parts and hardware are accounted for.

Contact us ASAP if anything is missing at:
support@flatlinevanco.com

BEFORE YOU START

All Flatline Van Co products must be properly assembled and secured before attaching to your vehicle. Improper attachment could result in an automobile accident, and could cause serious bodily injury or death to you or to others involved. You are responsible for assembling and securing Flatline Van Co products to your vehicle, checking the mounting points and attachments prior to use, and regularly inspecting the products for wear and or damage. We always recommend you use a professional to install any aftermarket accessories to your vehicle. If you have no mechanical experience and are not thoroughly familiar with the installation procedures, you must have the product installed by a professional installer or other qualified persons. The responsibility is yours and must be taken seriously for everyone's safety.



PACKAGE CONTENTS

DRIVER SIDE

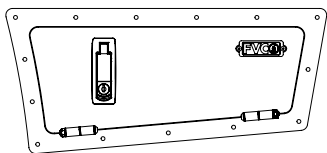

DOOR FRAME ASSEMBLY

QTY: 1

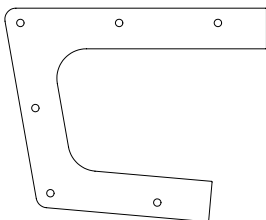

BACKING PLATE 1

QTY: 1

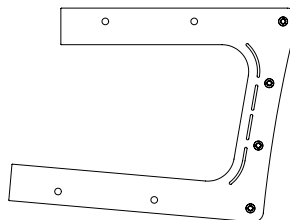

BACKING PLATE 2

QTY: 1

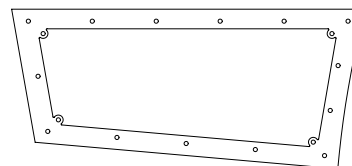

DRILL/CUT TEMPLATE

QTY: 1

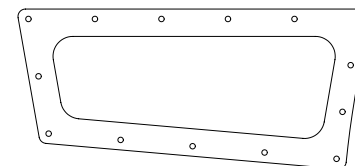

DOOR FRAME GASKET

QTY: 1

PASSENGER SIDE

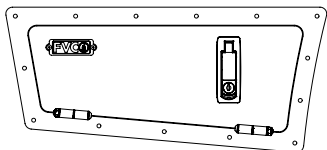

DOOR FRAME ASSEMBLY

QTY: 1

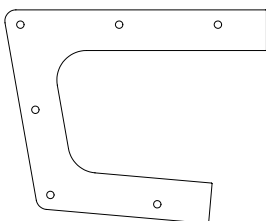

BACKING PLATE 1

QTY: 1

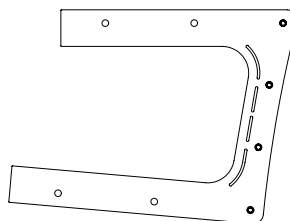

BACKING PLATE 2

QTY: 1

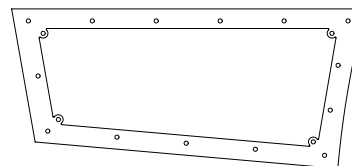

DRILL/CUT TEMPLATE

QTY: 1

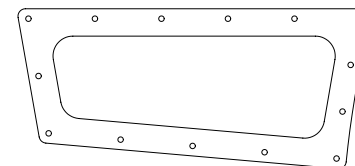

DOOR FRAME GASKET

QTY: 1

HARDWARE



M5 SCREW X 15 O.D. FLAT
WASHER

QTY: 20



M5-0.8 NYLON LOCKNUT

QTY: 20

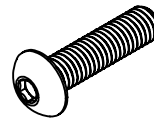

M5-0.8 X 20 BUTTON HEAD
HEX DRIVE SCREW

QTY: 20

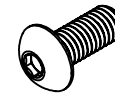

M5-0.8 X 12 BUTTON HEAD
HEX DRIVE SCREW

QTY: 8

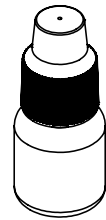

THREADLOCKER

QTY: 2

INSTALL

STEP | 01 LAYOUT AND INSTALL PREP

1.1 Clean Up: Start by cleaning the rear panels of any dirt and debris.

1.2 Marking Points: Measure and mark two spots $\frac{3}{8}$ " from the seam of the upper plastic panel and $\frac{1}{2}$ " from the rear bumper plastic to the metal body panel (**FIG 1**). These marks will help to guide template placement.

1.3 Template Alignment: Use tape to line up the template parallel to the plastic body panels along the marks. Visualize how the locker will fit on the van and make adjustments as necessary (**FIG 2**).

1.4 Tape Perimeter: Tape the perimeter of the template, leaving drill holes exposed. Mark all holes with a sharpie (**FIG 3**).

1.5 Cutting Path: Trace around the inside of the template to mark the cutting path. Ensure the template is flat against the van.

1.6 Remove Template: Carefully remove the template. You should be left with markings as shown in (**FIG 4**).

NOTE - All figures depict driver side installation. The passenger side follows the same steps, just mirrored.

TOOLS REQUIRED FOR THIS STEP: + TAPE MEASURE
+ MARKER
+ MASKING TAPE

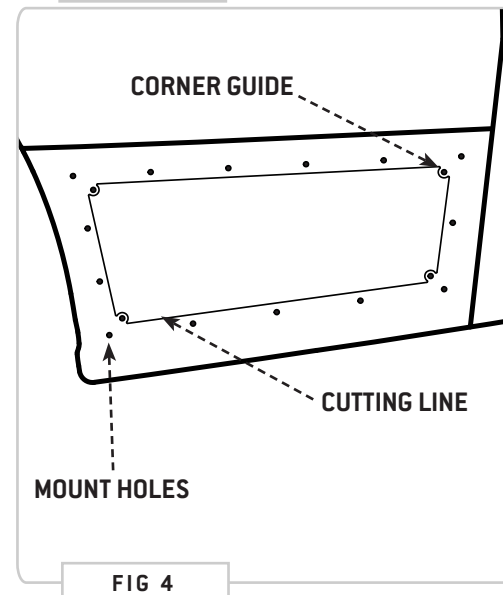
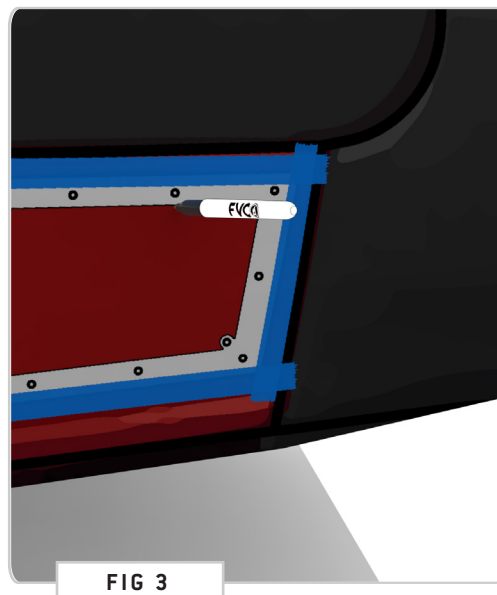
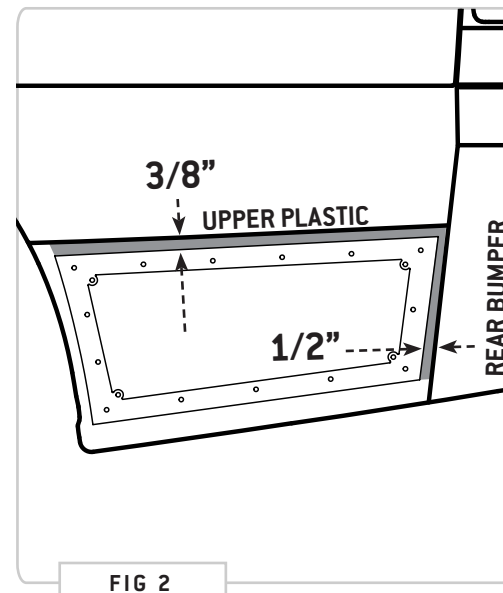

STEP | 02 DRILLING MOUNT HOLES

2.1 Center Punch: Lightly center punch holes using a Center Punch (FIG 5,6).

2.2 Drilling: Drill out holes using a 7/32" Drill Bit (FIG 7,8).

NOTE - When drilling the holes next to the wheel well, be sure to only drill through one layer of sheet metal.

TOOLS REQUIRED FOR THIS STEP:

- + POWER DRILL
- + 7/32" DRILL BIT
- + CENTER PUNCH
- + HAMMER

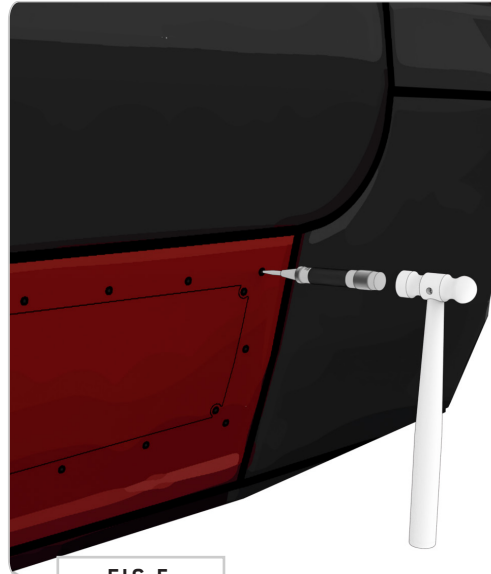

FIG 5



FIG 6



FIG 7



FIG 8

STEP | 03 CUTTING PANEL

3.1 Corner Guides: Drill out corner guide holes with a step bit to 1/2" using the traced arch of the cutting line as a visual guide (FIG 9,10). This will serve as your corner guide when cutting out the panel.

3.2 Body Saw: Use a body saw or angle grinder with a metal cutting wheel to cut the top and bottom horizontal lines of the panel first. Proceed to cut the left and right sides. Carefully hold the opposite end of metal on the last cut to stabilize (FIG 11,12).

NOTE - Be sure to only be cutting through one layer of sheet metal during this process.

NOTE - We recommend using a pneumatic or electric saw for this step. We like the Astro Pneumatic Tool 930 Air Body Saber Saw, but most saws with metal-cutting blades will work.

TOOLS REQUIRED FOR THIS STEP:

- + POWER DRILL
- + STEP BIT (MARKED AT 1/2")
- + BODY SAW OR ANGLE GRINDER
- + METAL CUTOFF WHEEL OR BLADE

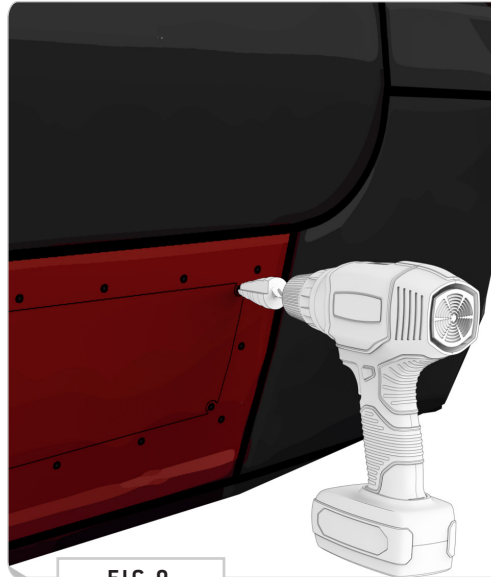

FIG 9



FIG 10

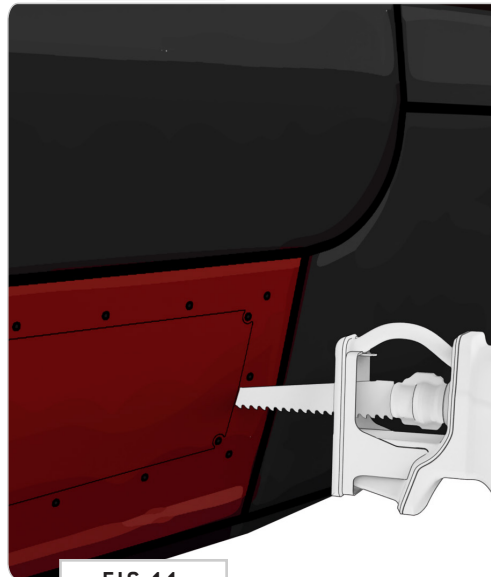

FIG 11



FIG 12

STEP | 04 DEBURR AND CLEANUP

4.1 Deburr and Cleanup: Deburr the newly cut hole and clean up shavings inside compartment (FIG 13,14).

NOTE - If you find that the cut is uneven, you can clean up the edge with a die grinder.

4.2 Mask Van Body: Remask perimeter with tape (FIG 15).

4.3 Rust Prevention: Paint raw edges of drill holes and cut lines with rust preventative paint (FIG 16).

PRO-TIP: Optionally, wipe down and paint the inner compartment in a well-ventilated area.

TOOLS REQUIRED FOR THIS STEP:

- + METAL FILE
- + MASKING TAPE
- + PAINT



FIG 13



FIG 14



FIG 15

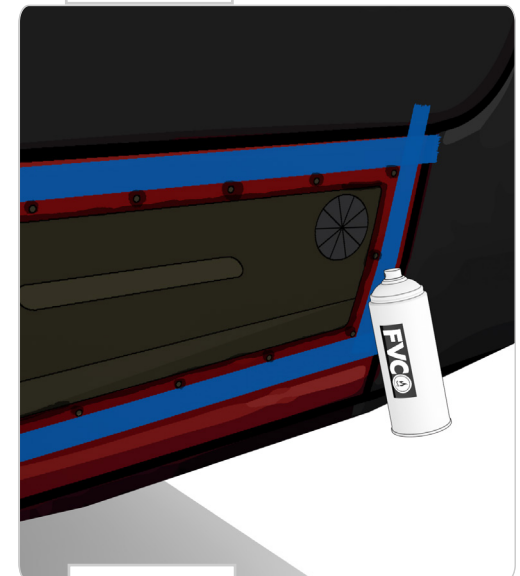

FIG 16

STEP | 05 LOCKER ASSEMBLY

5.1 Gather Components: Gather the face plate, gasket, and backer plates (FIG 17).

5.2 Mount Face Plate: Insert **M5-0.8 X 20 Button Head Hex Drive Screws** in the locations shown in FIG 17 to hold the door against the van body (mirrored for passenger side).

5.3 Gasket Placement: Place the Gasket onto bolts from the *inside compartment* (FIG 18).

5.4 Install Backer Plates: Loosely install backer plates with **Washers And Nuts** (FIG 19).

5.5 Alignment: If there's an alignment issue, drill out holes as needed (avoid backing plates). Use **Loctite** on screws that attach to pem nuts (FIG 20).

5.6 Assembly: Apply pressure to flex the assembly into place when tightening screws. Tighten nuts with an **8mm Wrench** and **2.5mm Allen Wrench** until snug.

TOOLS REQUIRED FOR THIS STEP: + 8MM Wrench
+ 2.5MM Allen Wrench

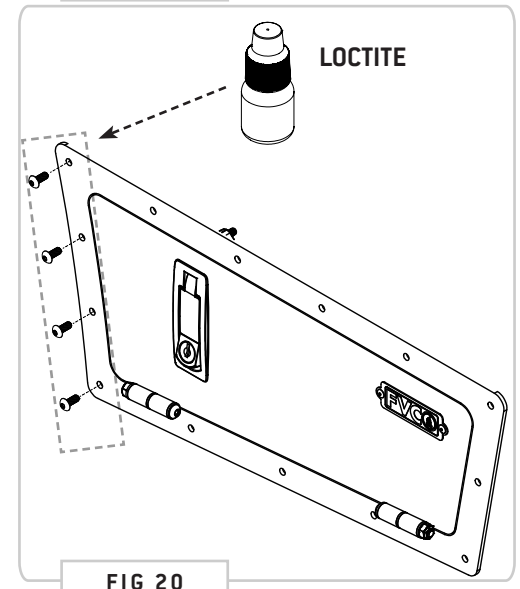
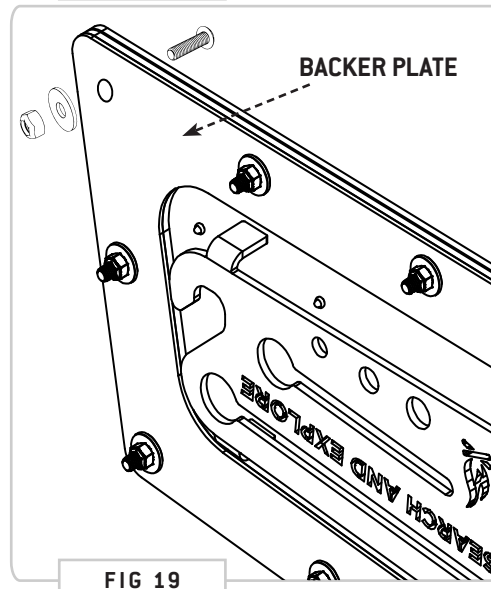
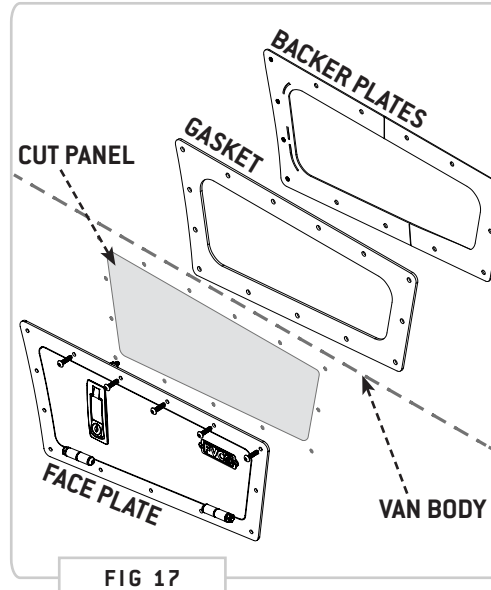

TOOLS REQUIRED FOR THIS STEP: + 10MM Wrench
+ 3MM Allen Wrench

STEP | 06 ADJUSTMENTS AND TUNING

6.1 Latch Compression: Using a **10MM Wrench**, loosen the **Jam Nut** (FIG 21) to adjust the **Compression Bolt** and retighten the nut when adjustment is complete.

NOTE - *Screw the bolt out to increase seal compression and screw the bolt in to decrease seal compression.*

6.2 Hinge Bolts: The hinges can be adjusted using a **10MM Wrench** and **3MM Allen Wrench**. Tighten the **Hinge Pivot Bolt** to increase torque, loosen **Hinge Pivot Bolt** to decrease torque (FIG 21).

Your Rear Storage Locker is now ready for action! Happy travels!

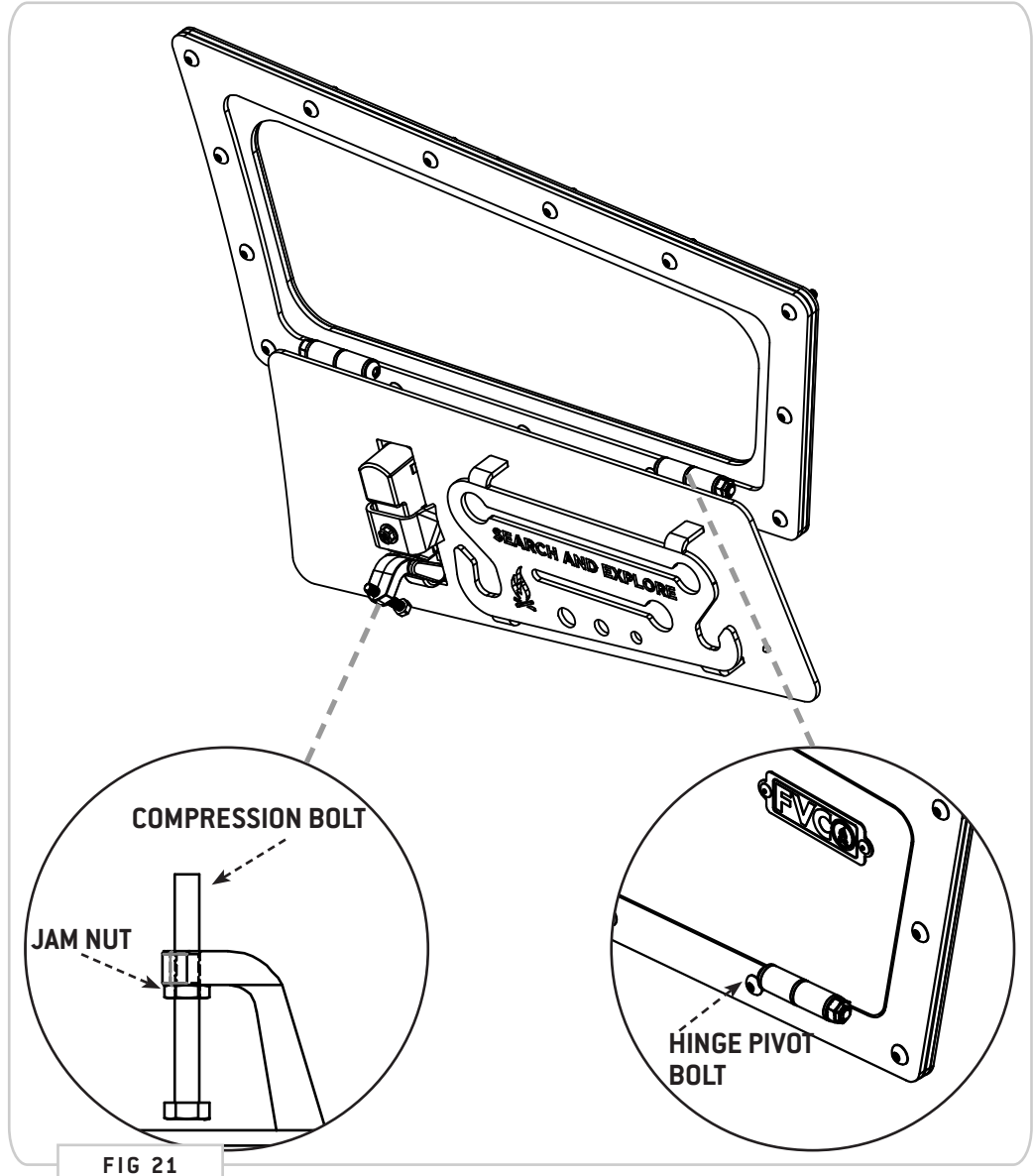

GET OUT AND EXPLORE!

+ LEAVE US A REVIEW

Happy with your new FVC product? We would love to hear (and see) from you! Head to the product page and click "Leave Review." Add a short review and upload a few photos to be showcased on the product page.

+ SHARE YOUR PICS

We love seeing how our customers use their FVC products and following along with your adventures. Tag us in your photos with: @flatlinevanco or send them to us via email. We love posting customer pictures in our feed!

+ NEED ANY HELP?

If you are having any issues with your product, please reach out, and we will make it right. FVC is a company of van and outdoor enthusiasts that design and use our own products, so we want you to be as stoked on your new parts as we are!



@FLATLINEVANCO