



INSTALLATION GUIDE

SPRINTER VAN SURF POLE

SP1110B



TOOLS REQUIRED (NOT INCLUDED)

- + TAPE MEASURE
- + IMPACT DRIVER
- + 9/16" SOCKET
- + 3/8" SOCKET
- + 7/32" ALLEN WRENCH
- + 5/32" ALLEN WRENCH

INSTALL INFO

TIME TO INSTALL THIS PRODUCT: 1 HOUR

Additional help is suggested for a few of the install steps.

BEFORE YOU START

Please inspect the product and packaging upon delivery to ensure there are no issues and that all parts and hardware are accounted for.

Contact us ASAP if anything is missing at:
support@flatlinevanco.com

BEFORE YOU START

All Flatline Van Co products must be properly assembled and secured before attaching to your vehicle. Improper attachment could result in an automobile accident, and could cause serious bodily injury or death to you or to others involved. You are responsible for assembling and securing Flatline Van Co products to your vehicle, checking the mounting points and attachments prior to use, and regularly inspecting the products for wear and or damage. We always recommend you use a professional to install any aftermarket accessories to your vehicle. If you have no mechanical experience and are not thoroughly familiar with the installation procedures, you must have the product installed by a professional installer or other qualified persons. The responsibility is yours and must be taken seriously for everyone's safety.



PACKAGE CONTENTS

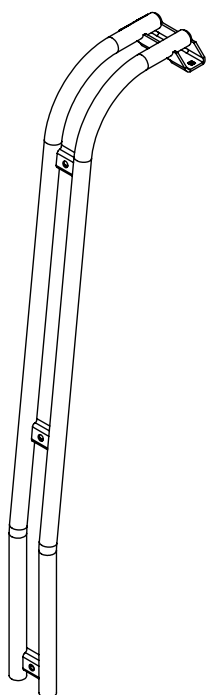

TOP WELDMENT

QTY: 1

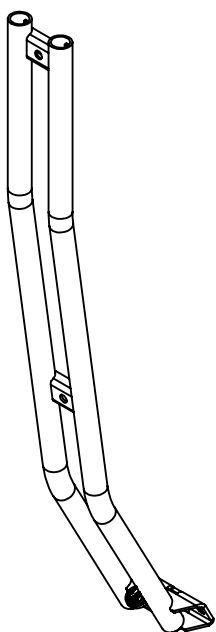

BOTTOM WELDMENT

QTY: 1

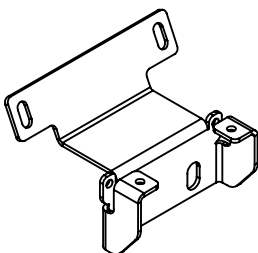

SURF POLE HANGAR
BRACKET

QTY: 1



BAYONET

QTY: 2

HARDWARE

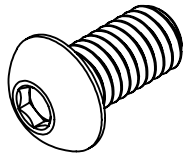

3/8-16 X 0.75 BUTTON HEAD
HEX DRIVE SCREW

QTY: 2

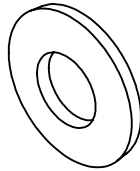

3/8 SCREW BELLEVILLE
SPRING LOCK WASHER

QTY: 2

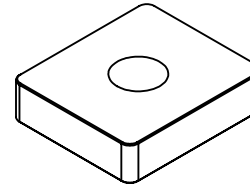

SPRINTER RAIL NUT

QTY: 2

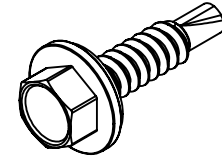

1/4 X 1 HEX HEAD WITH
SEALING WASHER DRILLING
SCREW

QTY: 4

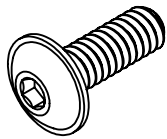

1/4-20 X 0.75 FLANGED
BUTTON HEAD HEX DRIVE

QTY: 2

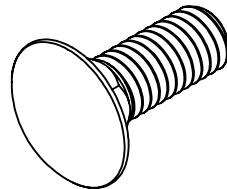

3/8-16 X 1 SQUARE NECK
CARRIAGE BOLT

QTY: 2



3/8 SCREW FLAT
WASHER

QTY: 2

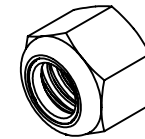

3/8-16 NYLON INSERT
LOCKNUT

QTY: 2

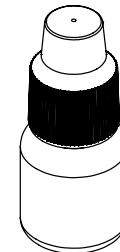

5ML THREADLOCKER
BOTTLE

QTY: 1

INSTALL

STEP | 01 LAYOUT AND INSTALL PREP

1.1 Identify Van Configuration: There could be any number of accessories mounted to your van that may inform the way you approach the install of your **Surf Pole** (Roof Racks, Side Steps, Water Tanks, etc.) See **FIG 1** for key areas that will need accessed.

1.2 FVC Products Compatibility: The **Surf Pole** is designed to be mounted alongside our **Side Steps** (**FIG 2**) and is compatible with each of our roof racks (**FIG 3**) *except* the **Standard Rack**.

1.3 Layout Location of Surf Pole: Take the time to dry-fit the surf pole to your van, consider the needs of your application and mark the desired location of your install with tape or a marker.

NOTE - The van pictured is a 144" High Roof Sprinter, but the same principles apply to the 170"

NOTE - You may need to loosen or temporarily remove mounted accessories to gain sufficient access to the Roof Rail and Pinch Seam of your van.

TOOLS REQUIRED FOR THIS STEP: + TAPE MEASURE
+ MASKING TAPE

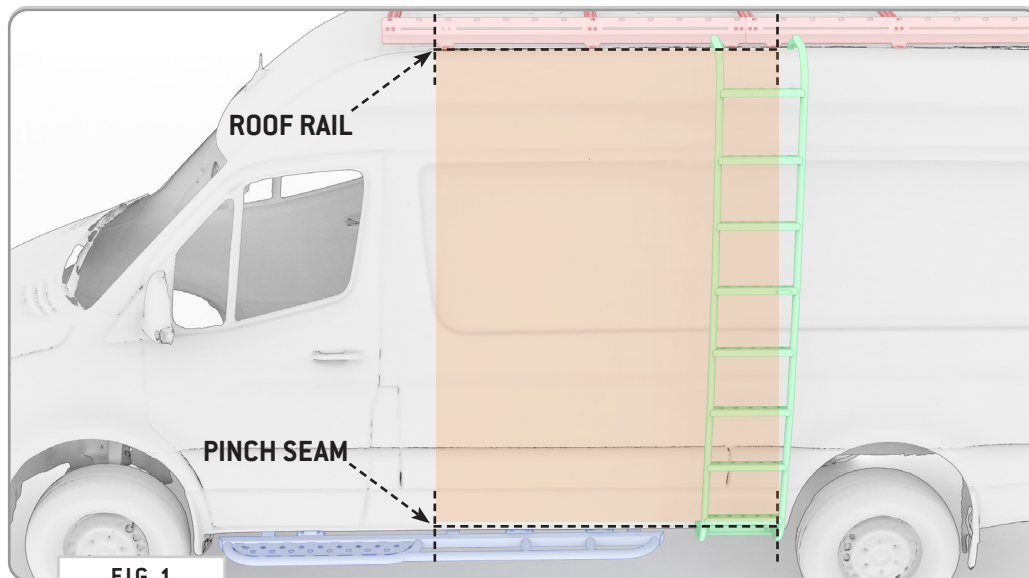

FIG 1

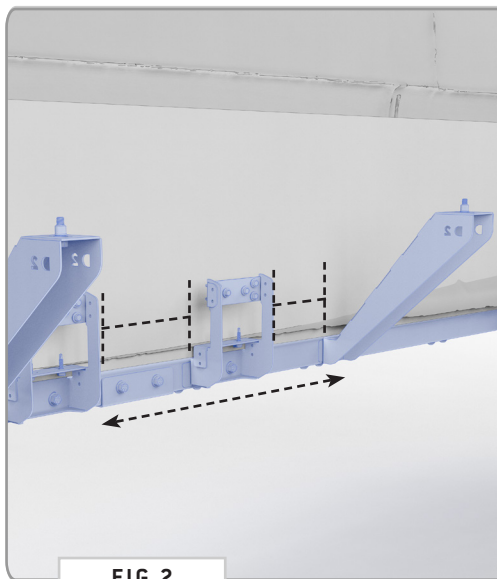

FIG 2

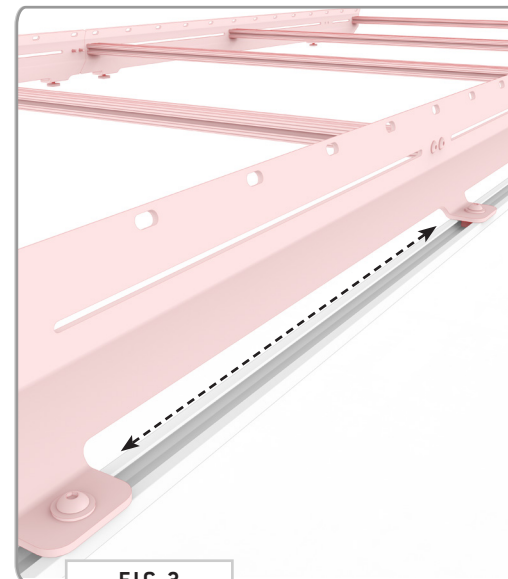

FIG 3

TOOLS REQUIRED FOR THIS STEP: + 5/32" ALLEN WRENCH

STEP | 02 SURF POLE ASSEMBLY

2.1 Install Bayonets to Bottom Weldment: Find the **Bottom Weldment** and insert **Bayonets** as shown in FIG 4. Secure using **(4) 1/4-20 x 0.75 Flanged Button Head Hex Drive Screws and Loctite**.

2.2 Attach Top Weldment: Find the **Top Weldment** and attach to protruding Bayonets using **(4) 1/4-20 x 0.75 Flanged Button Head Hex Drive Screws and Loctite** as shown in FIG 5-7.

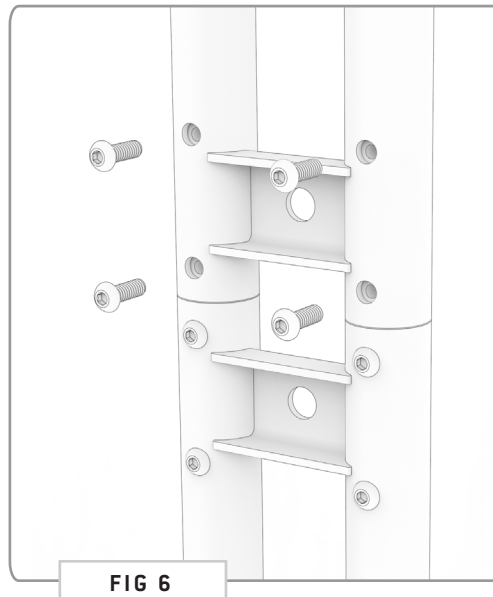
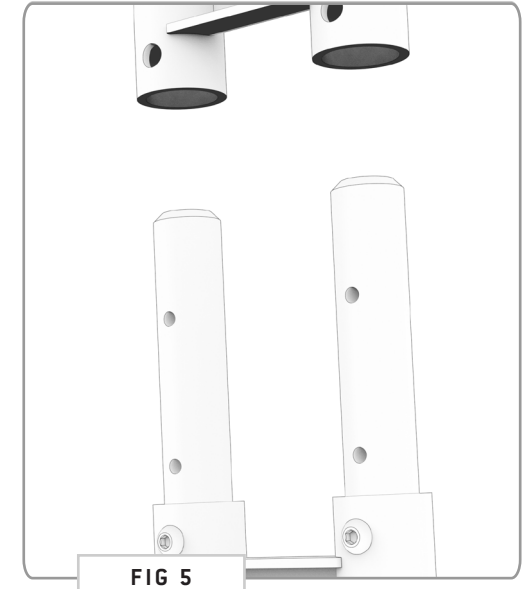
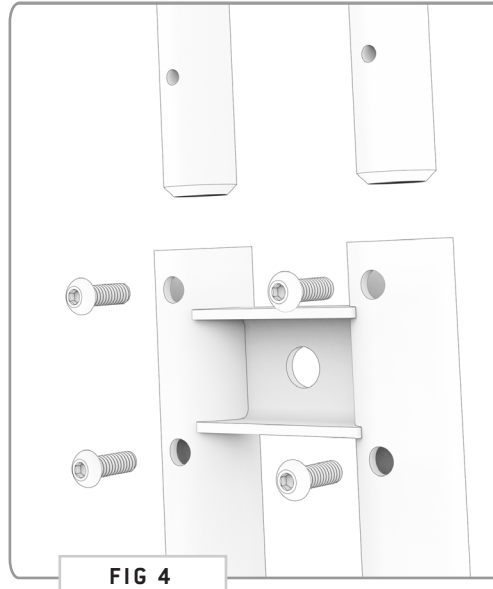

TOOLS REQUIRED FOR THIS STEP: + 7/32" ALLEN WRENCH

STEP | 03 SURF POLE FITTING

3.1 Roof Rail Nuts: Slide in Rail Nuts to desired location of install along the Roof Rail (**FIG 8+9**).

3.2 Attach Surf Pole: Loosely secure Surf Pole to Rail Nuts using (2) 3/8-16 x 0.5" Button Head Hex Screws and Washers (**FIG 10+11**).

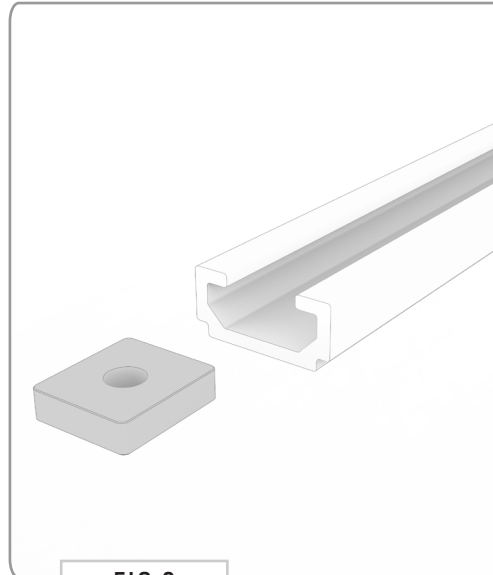

FIG 8

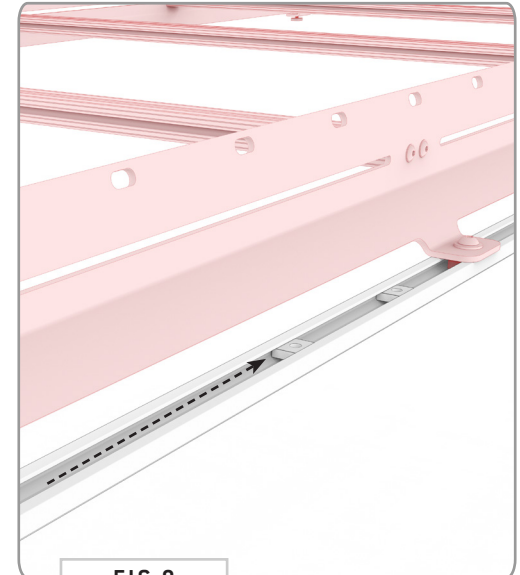

FIG 9

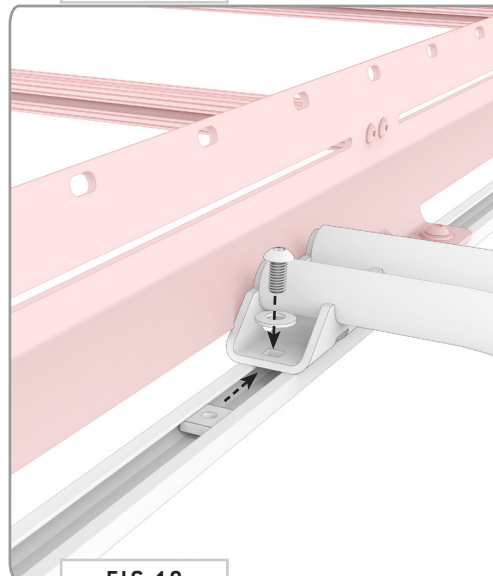

FIG 10

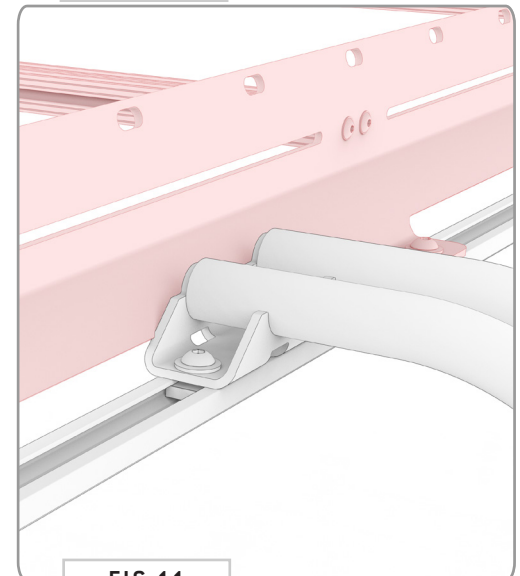
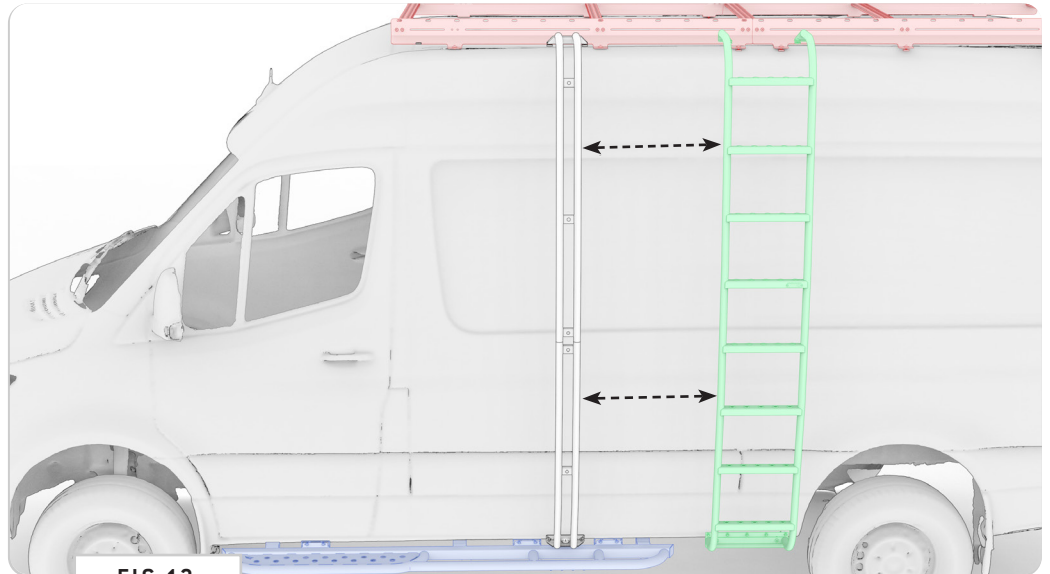

FIG 11

STEP | 04 SURF POLE ALIGNMENT

4.1 Align Pole to Secondary Mounting Point: Whether you are using an **FVC Side Ladder (FIG 12)** or a secondary **Surf Pole (FIG 13)**, measure to ensure that the distance between mounting points is square from the top to the bottom.

TOOLS REQUIRED FOR THIS STEP: + TAPE MEASURE



STEP | 05 SURF POLE INSTALL

5.1a Direct Mount to FVC Side Steps: Loosen the 3/8-16" Bolts holding the **Driver Side Step Weldment** to your **Hangar Brackets** and **Side Braces** (FIG 14). Remove the Bolts holding the **Joining Plate** to the **Weldment** and replace using the supplied **Surf Pole Hangar Bracket** and existing hardware (FIG 15).

TOOLS REQUIRED FOR THIS STEP:

- + IMPACT DRIVER
- + 3/8" SOCKET
- + 9/16" SOCKET



FIG 14



FIG 15

STEP | 05 SURF POLE INSTALL

5.1b Mount to Pinch Seam: Loosen the 3/8-16" Bolts holding the **Driver Side Step Weldment** to your **Hangar Brackets** and **Side Braces** (FIG 16). Slide in the **Surf Pole Hangar Bracket** into place and drive (2) 1/4-20" Self Tapping Screws into the body sheet metal from the bottom (FIG 16) and two more screws into the **Pinch Seam** from the front (FIG 17).

TOOLS REQUIRED FOR THIS STEP:

- + IMPACT DRIVER
- + 3/8" SOCKET
- + 9/16" SOCKET



FIG 16



FIG 17

STEP | 05 SURF POLE INSTALL

5.3 Surf Pole to Hangar Bracket Mount: Attach your **Surf Pole** to the installed **Surf Pole Hangar Bracket** as shown (**FIG 18**) using the provided **3/8-16" Carriage Bolts, Flat Washers and Nylon Locknuts**.

5.4 Tighten All Hardware: Once you have ensured alignment, go back and tighten down all fasteners (**FIG 19**).

TOOLS REQUIRED FOR THIS STEP: + IMPACT DRIVER
+ 9/16" SOCKET
+ 7/32" ALLEN WRENCH

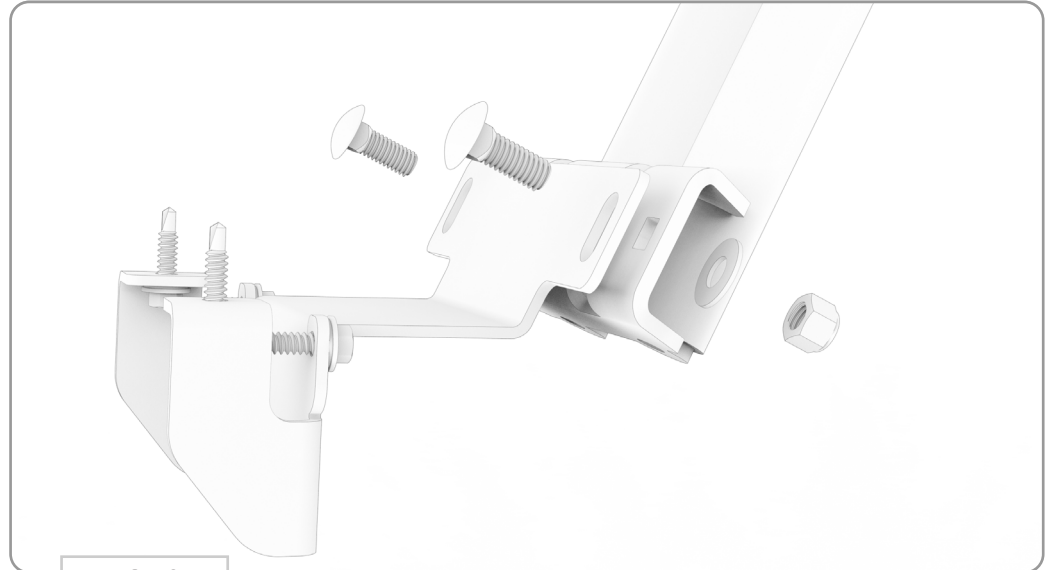

FIG 18



FIG 19

GET OUT AND EXPLORE!

+ LEAVE US A REVIEW

Happy with your new FVC product? We would love to hear (and see) from you! Head to the product page and click "Leave Review." Add a short review and upload a few photos to be showcased on the product page.

+ SHARE YOUR PICS

We love seeing how our customers use their FVC products and following along with your adventures. Tag us in your photos with: @flatlinevanco or send them to us via email. We love posting customer pictures in our feed!

+ NEED ANY HELP?

If you are having any issues with your product, please reach out, and we will make it right. FVC is a company of van and outdoor enthusiasts that design and use our own products, so we want you to be as stoked on your new parts as we are!



@FLATLINEVANCO