



SHERPA
PREMIUM RACK SYSTEMS

THE MINERAL

RACK SYSTEM INSTALL GUIDE

HARDWARE CHECKLIST

24

1/4"-20
(1") CARRIAGE BOLTS

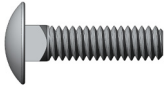

40

1/4"-20
(1") SOCKET BOLTS



6

1/4"-20
(1/2") SOCKET BOLTS



16

1/4"-20
(9/16") HEX BOLTS

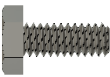

22

1/4" TNUTS



86

1/4" FLAT WASHER



24

1/4"-20
NUTS



1

WIND FAIRING



10

CROSSBARS



2

SIDEPLATES



2

FRONT
MOUNTS
PN: LS F L/R

4

MIDDLE
MOUNTS
PN: LS M

2

REAR
MOUNTS
PN: LS R L/R

8

OUTER
MOUNTS

BEFORE YOU START

The below assembly images may differ slightly in appearance from actual product.

**USING
TNUTS**

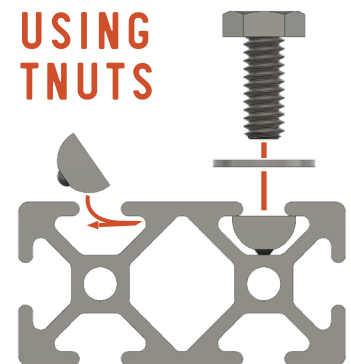

MOUNTS

01 FRONT MOUNT ASSEMBLY

Required Components:

- 1 Crossbar
- 2 Front Mounts
- 4 1/4"-20x9/16" Hex Bolts
- 4 1/4" Flat Washers
- 4 Tnuts

Drop 4 tnuts into the slots on the crossbar and line them up with the holes in mounts. Secure top of the mounting bracket to the crossbar leaving the hardware loose so that it can be adjusted during a later step.

Note: Front mounts have the "F" designation toward the end.

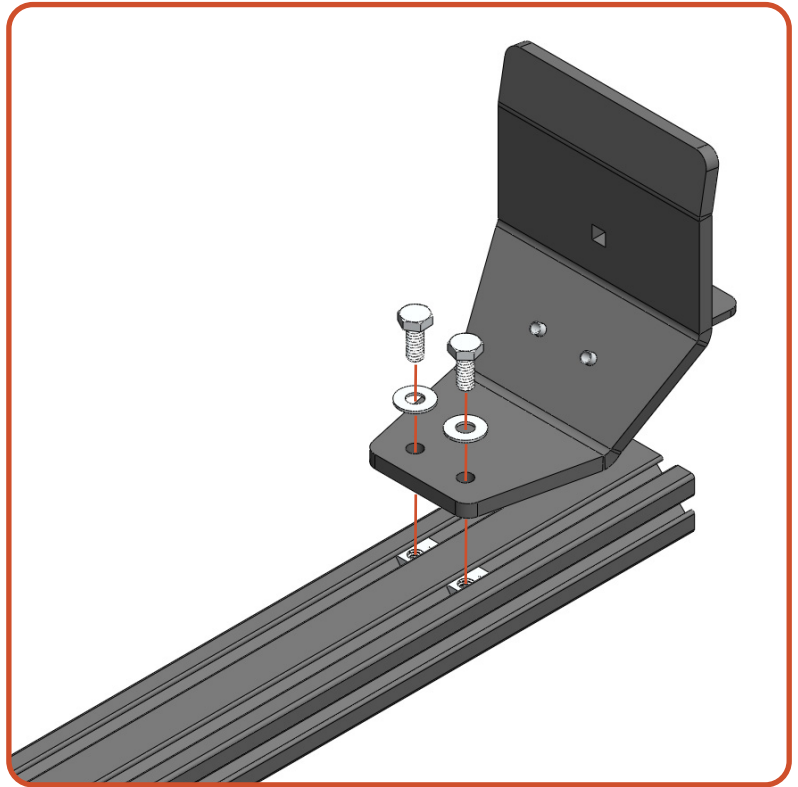

02 REAR MOUNT ASSEMBLY

Required Components:

- 1 Crossbar
- 2 Rear Mounts
- 4 1/4"-20x9/16" Hex Bolts
- 4 1/4" Flat Washers
- 4 Tnuts

Repeat assembly.

Note: Rear mounts have the "R" designation toward the end.

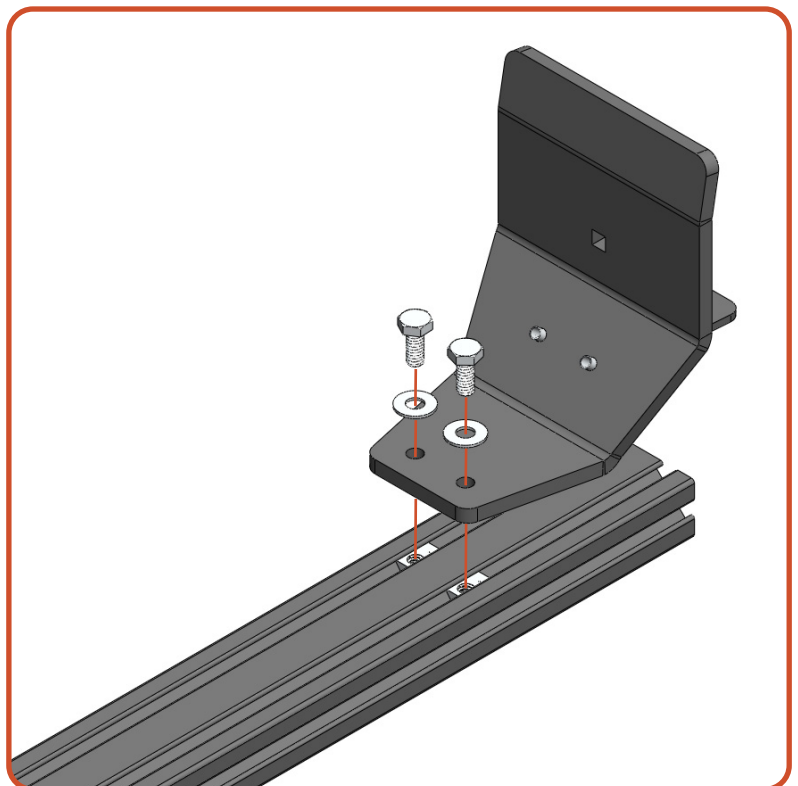

Ø3 MID MOUNT ASSEMBLY

Required Components:

- 1 Crossbar
- 2 Rear Mounts
- 4 1/4"-20x9/16" Hex Bolts
- 4 1/4" Flat Washers
- 4 Nuts

If your rack comes with a middle mount(s), repeat assembly as needed.

Note: Middle mounts have the "M" designation at the end.

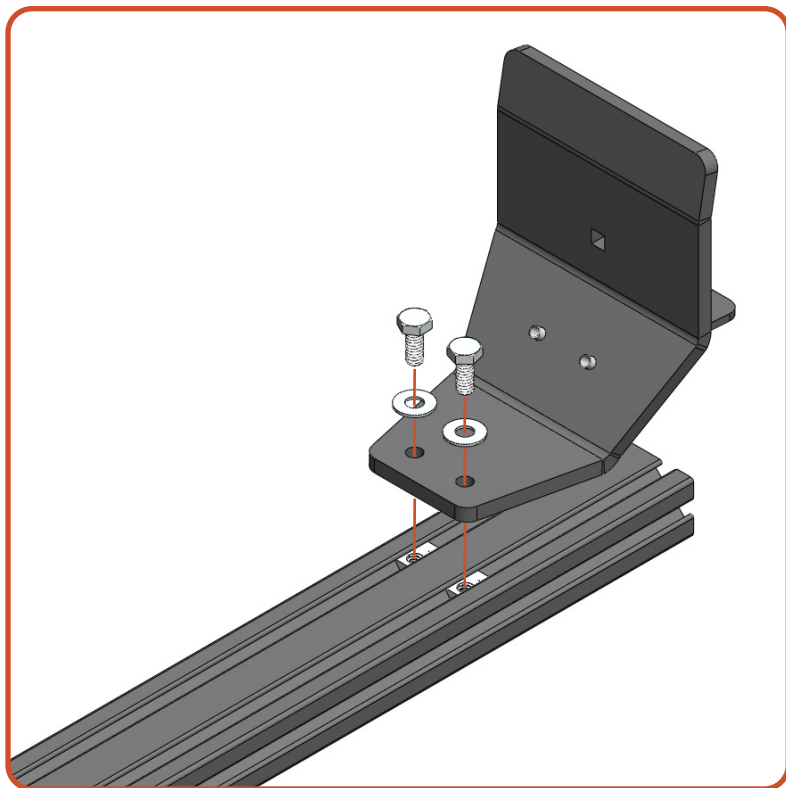

MOUNT INSTALL

01 INSTALL ON VEHICLE

Required Components:

All Mount Assemblies

Position the mount assemblies on the vehicle spacing them out roughly according to the notches in the sideplates.

Note: Front and rear mounts are labeled with an "L" or "R" based on position. Middles are universal.

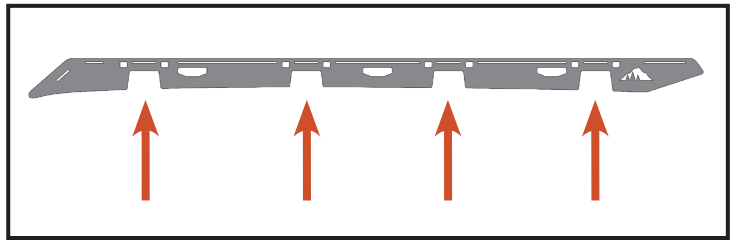
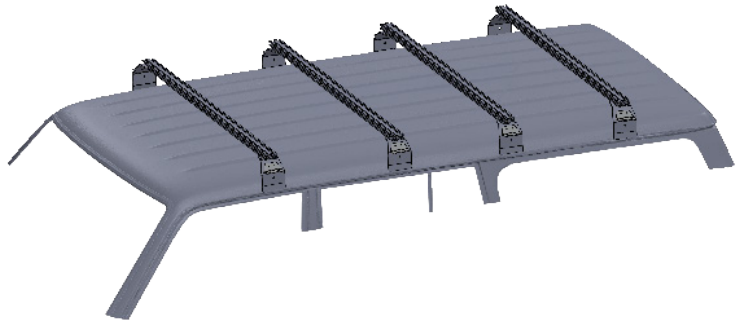

02 CENTER THE MOUNTS

Use a tape measure and center all of the bars on the vehicle. Measure from the inside edge of the mount to the outside face of the crossbar and make these equal side-to-side. Tighten the hardware to the crossbar.

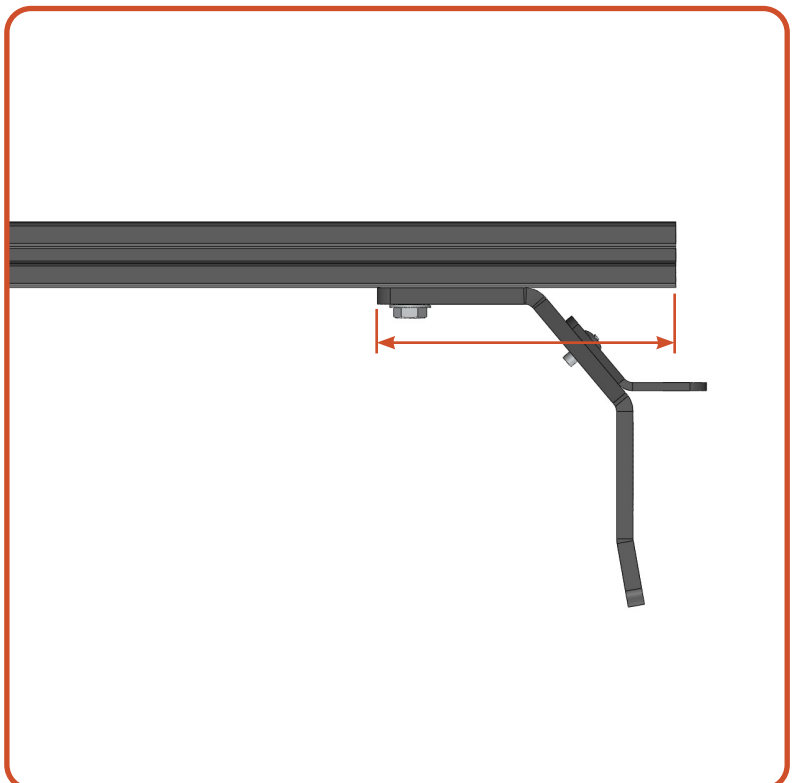

SIDEPLATES

01 SIDEPLATES

Required Components:

- 2** Sideplates
- 4** 1/4"-20 x 1" SB
per mount assembly
- 4** 1/4" Washers
per mount assembly

Next, align the small slots in the sideplates with the ends of the main support crossbars. Secure them using bolts and washers with the mounts centered in the sideplate cutouts. Tighten all hardware.

Slide the sideplate, with the attached crossbar assemblies, to the position that matches the curvature of the vehicle.

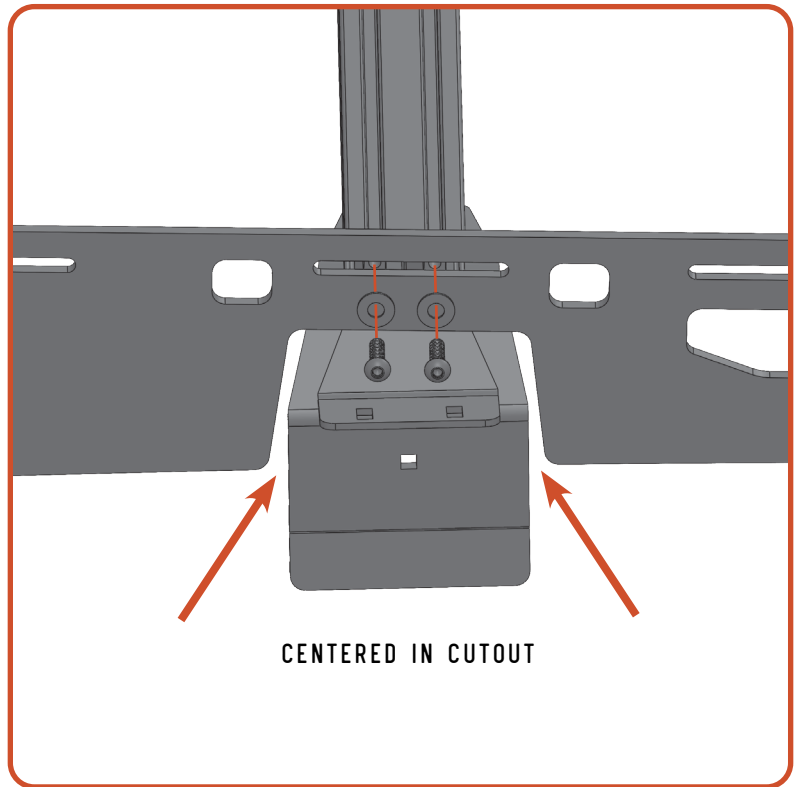

02 INSTALL MOUNT OUTERS

Required Components:

- 2** 1/4"-20 x 1" Carriage
per mount assembly
- 2** 1/4" Washers
per mount assembly
- 2** 1/4"-20 Nuts
per mount assembly

Secure the outer mount brackets with the horizontal holes using the screws, washers, and nuts. Leave slightly loose.

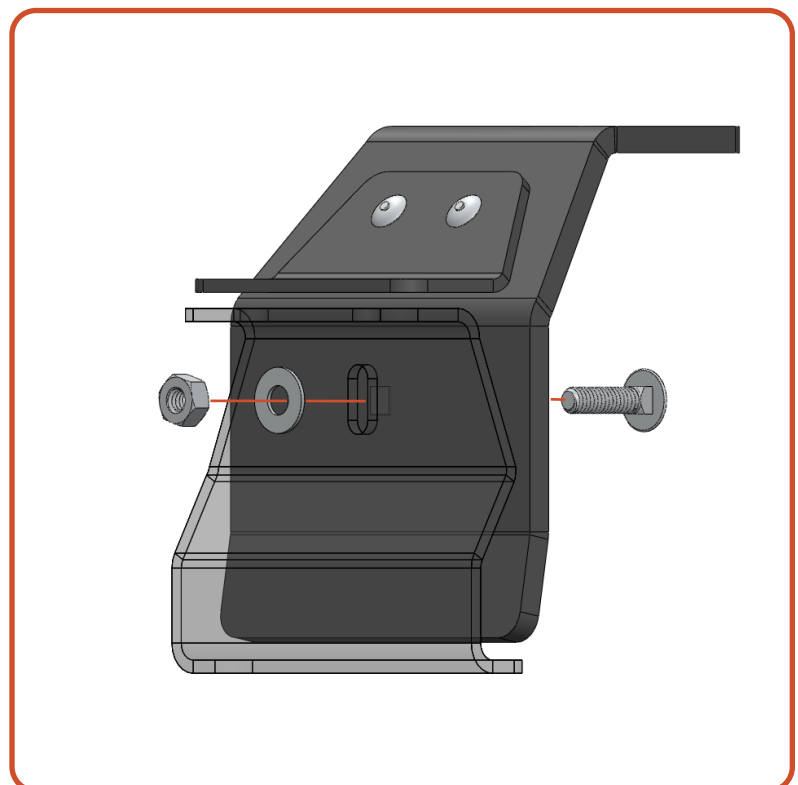

Ø3 TIGHTEN MOUNT OUTERS

Required Components:

4 1/4"-20x1" Carriage Bolts
per mount assembly

4 1/4" Washers
per mount assembly

4 1/4"-20 Nuts
per mount assembly

Next, secure the brackets through the vertical holes with the hardware. Tighten until the gap pinches tight.

Lastly, tighten the horizontal bolt left loose in previous step.

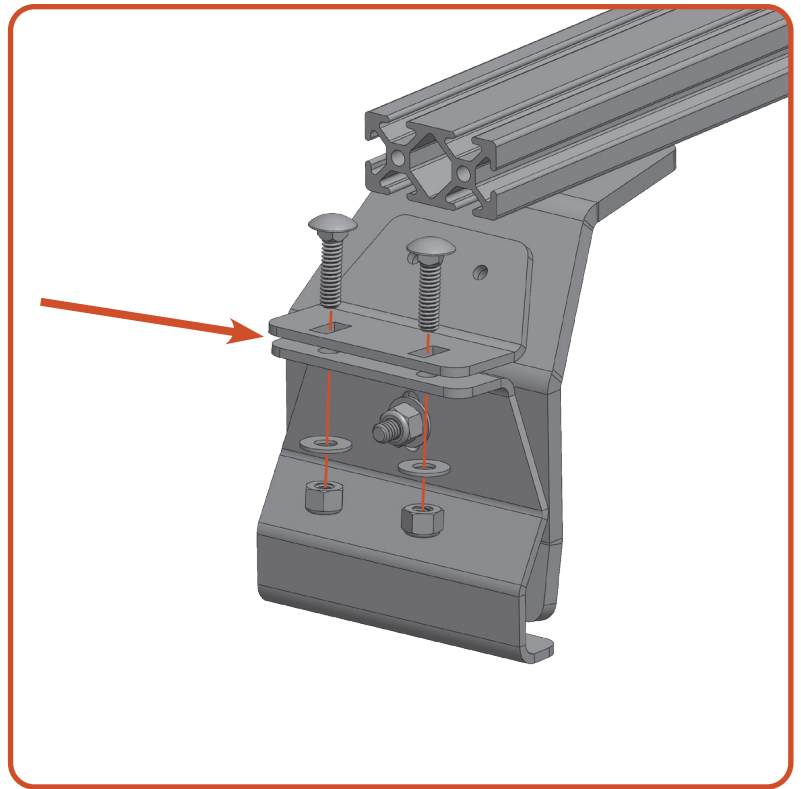

WIND FAIRING

01 FAIRING ASSEMBLY

Required Components:

- 1 Crossbar
- 6 1/4"-20x1/2" Socket Bolts
- 6 1/4" Flat Washers
- 6 Tnuts

Drop 6 tnuts into the slots on the crossbar and line them up with the holes in the fairing. Secure with 6 bolts and washers.

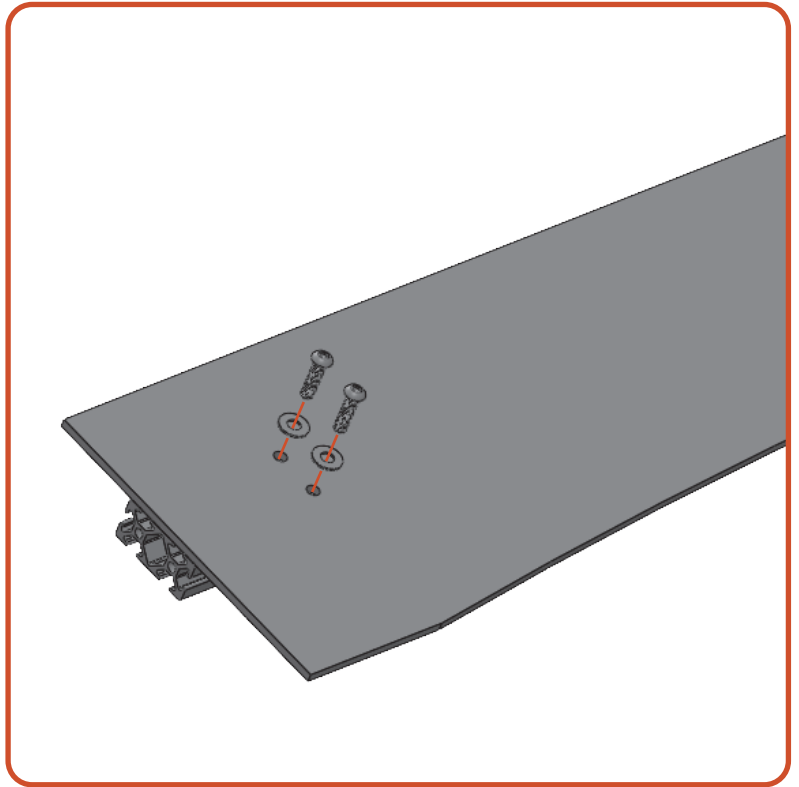

02 FAIRING INSTALLATION

Required Components:

- 4 1/4"-20x1" Socket Bolts
- 4 1/4" Flat Washers

Position the wind fairing in line with the diagonal slot at the front of the rack. Align the bottom of the fairing with the tip of the roof rack and secure it using bolts and washers.

The fairing can be adjusted up or down if wind noise is detected. Small adjustments make a big difference here.

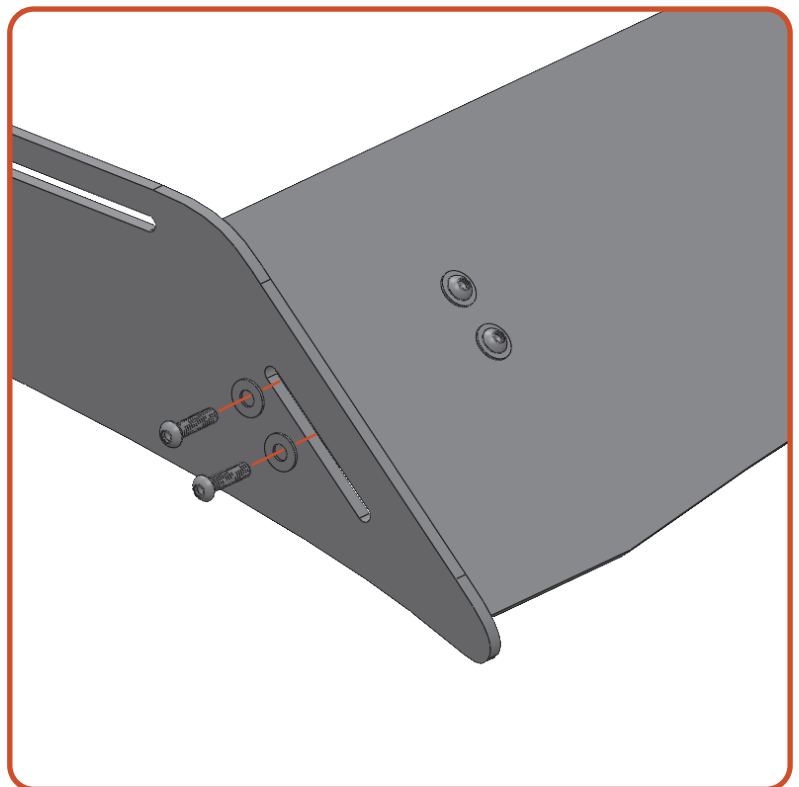

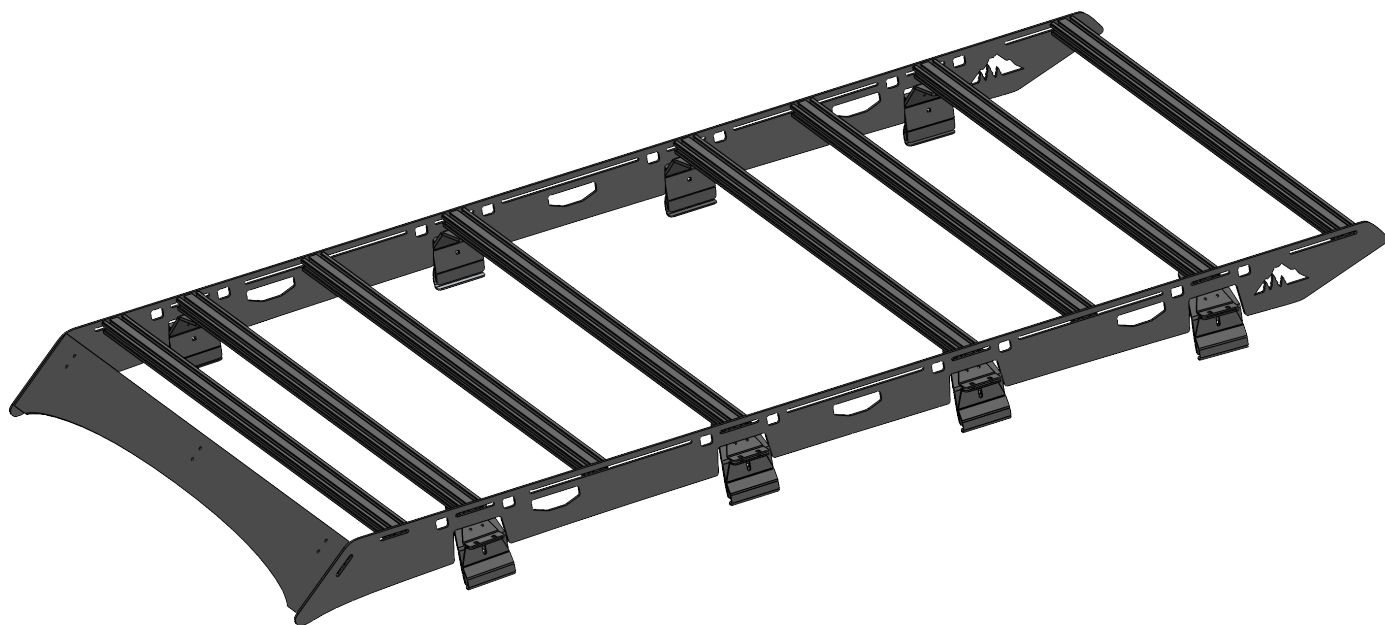

04 INSTALL CROSSBARS

Required Components:

Remaining Crossbars

4 1/4"-20 x 1" Socket Bolts
per crossbar

4 1/4" Flat Washers
per crossbar

Secure all of the remaining crossbars to the rack system. Space evenly or position according to your load requirements.

NOW GET OUT THERE AND
EXPLORE.

WELCOME TO THE SHERPA FAMILY!
MAKE SURE TO FOLLOW US ON YOUR SOCIALS AND TAG US IN YOUR ADVENTURES.

All products built and designed by Sherpa Equipment Company are intended for off-road use and should be assembled, installed, and used according to Sherpa Equipment Company's recommendations. Sherpa Equipment Company's products should be used safely with good judgment towards others and surroundings.

By installing Sherpa Equipment Company's products on your vehicle you assume all liability. Sherpa Equipment Company will not be held liable for damages or loss associated with the installation or use of its products. It is recommended that you inspect your roof rack within the first 100 miles of installation and every 500 miles after.