

DK-815993 INSTRUCTIONS



PARTS INCLUDED

Quantity	Item Description	Part #
1	Driver Upper Control Arm	DK-815993-A1300
1	Passenger Upper Control Arm	DK-815993-A1400
1	Washer Pack	DK-815711
2	Line Clamps	AF-330061



1. RAISE THE VEHICLE AND PREPARE FOR INSTALL

- a. Safely support the vehicle.
- b. Remove the front wheels.
- c. Remove the wheel aprons to the left and right of the upper control arm.



2. REMOVE UPPER CONTROL ARM

- a. Remove the ABS line bracket attached to the upper control arm.
- b. Remove the cotter pin and loosen the castle nut from the upper control arm.
- c. Separate the upper control arm from the steering knuckle using a ball joint puller.
- d. Remove the pivot bolt at the rear of the upper control arm.
- e. Remove the upper control arm from the chassis.



3. INSTALL DIRT KING UPPER CONTROL ARM

- a. Note: Aftermarket shocks are required for the additional drop and proper alignment with the new upper control arm.
- b. Insert the new upper control arm using the OEM rear pivot bolt. Ensure the supplied washers are positioned on the outside of the bushings. Torque the nut to 173 ft-lbs.
- c. Install the ball joint to the steering knuckle and torque the nut to 81 ft-lbs.
- d. Attach the ABS line to the control arm using the supplied line clamp.



4. INSPECT WORK

- a. Inspect all components to ensure they are correctly installed.
- b. Confirm that the ABS line has enough slack.
- c. Ensure all fasteners are properly tightened.



5. REINSTALL WHEELS AND ALIGN THE VEHICLE

- a. Reinstall the wheels and torque the lug nuts to your wheel manufacturer's specifications.
- b. Have the vehicle aligned at a certified shop. If equipped with Advanced Driver Assistance Systems (ADAS), ensure recalibration is performed.



**FOR WARNINGS AND DISCLAIMERS, VISIT DIRT KING DISCLAIMER
([HTTPS://DIRTKING.COM/PAGES/DISCLAIMER](https://DIRTKING.COM/PAGES/DISCLAIMER)).**







Parts Included

Quantity	Item Description	Part#
2	IFP Smooth Body Shock	DK-815885R-A1200

Please check that all items are present before installation. If for any reason, there is an item or items missing send an email to sales@dirtking.com with proof of purchase and a picture of parts received.



Before installing, read all instructions. Only certified mechanics should install Dirt King products. Mandatory wheel alignment and ADAS calibration at certified facilities are required after suspension modifications. Failure to do so can lead to handling problems and safety risks. Dirt King is not responsible for damages from improper installation or misuse. Adhere to your vehicle manufacturer's recommendations. For more information, visit <https://dirtking.com/pages/disclaimer>

Step 1: Disassembly

Start by raising the vehicle and placing jack stands under the frame rails. Lower the axle to release tension off the suspension. Remove lower shock absorber mounting hardware (**Image 1**). Remove upper shock absorber mounting hardware (**Image 2**).

Image 1

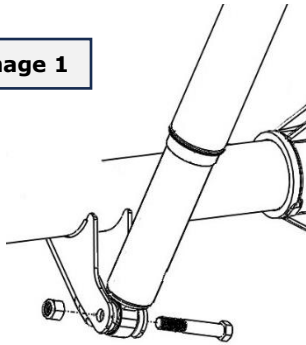
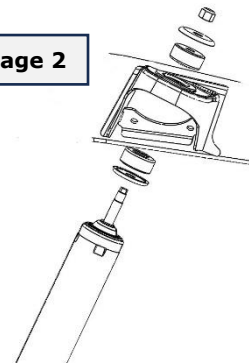

Image 2



Step 2: Assembly

Install Dirt King shock to upper frame mount (**Image 3**) and loosely install the nut. Insert the shock into the lower axle mount and loosely install the OEM hardware (**Image 4**). Lower the vehicle so it's sitting on its own weight. Press down on the vehicle several times to stabilize the suspension.

Image 3

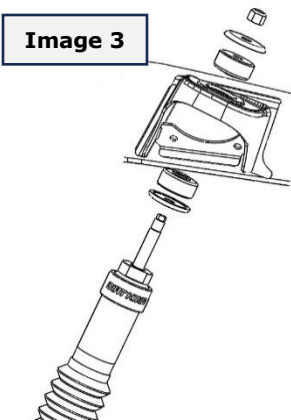
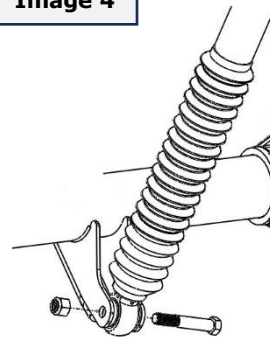

Image 4



Step 3: Torque Hardware

With the vehicle on its own weight torque all hardware to following specs:

Rear shock upper stem nut: 21ft lbs.

Rear shock lower axle mount bolt: 66ft lbs.



Parts Included

Quantity	Item Description	Part#
2	Coil-Over Shock	DK-815985F-A1200
1	Spanner Wrench	DK-SW001
1	Allen Key	N/A

Please check that all items are present before installation. If for any reason, there is an item or items missing send an email to sales@dirtking.com with proof of purchase and a picture of parts received.



Before installing, read all instructions. Only certified mechanics should install Dirt King products. Mandatory wheel alignment and ADAS calibration at certified facilities are required after suspension modifications. Failure to do so can lead to handling problems and safety risks. Dirt King is not responsible for damages from improper installation or misuse. Adhere to your vehicle manufacturer's recommendations. For more information, visit <https://dirtking.com/pages/disclaimer>

Step 1: Disassembly

Start by raising the vehicle and placing jack stands under the frame rails. Next remove the front wheels. Disconnect the brake hose bracket and wheel speed sensor to prevent damage during shock removal. Loosen the upper control arm ball joint nut. Strike the side of the knuckle to loosen the ball joint taper (**Image 1**). Rotate the upper control arm upward. Remove the sway bar link nut from lower control arm (**Image 2**). **Note:** Aftermarket upper control arms are required with these shocks. Remove the upper and lower shock bolts. Now remove the shock from the vehicle.

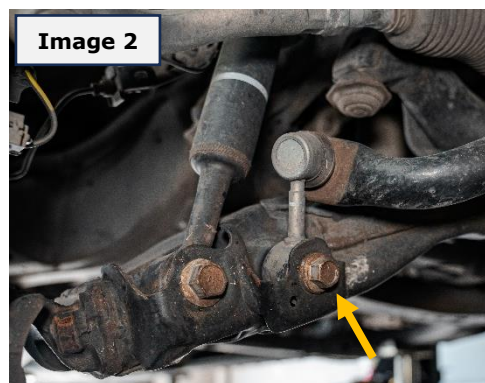
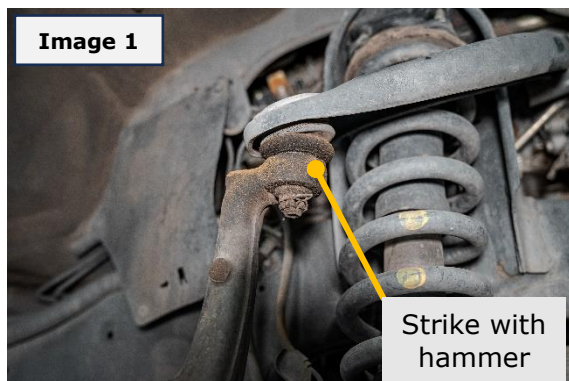

Step 2: Assembly

Install the Dirt King shock by lowering the bottom mount into position.

NOTE: If you are not using Dirt King lower control arms, you will need to grind the factory lower control arms to ensure proper clearance between the shock eyelet and the mounting pocket (**Image 3 & 4**).

Apply blue thread locker and torque lower shock bolts to 114ft lbs. Align the top of shock to the coil bucket. Apply blue thread locker to the top shock mounting bolts and torque to 35ft lbs. Insert the upper arm ball joint into the knuckle and torque to manufacturer's specs. Lastly install the sway bar link using the OE hardware and torque to 89ft lbs.

