



**SHERPA**  
PREMIUM RACK SYSTEMS

# THE CROW'S NEST

RACK SYSTEM INSTALL GUIDE

# HARDWARE CHECKLIST

**2**

SIDEPLATES

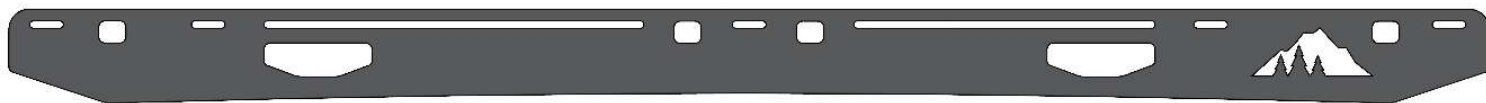

**5-9**

CROSSBARS



**1**

Name Plate



**4**

SETS OF MOUNTS

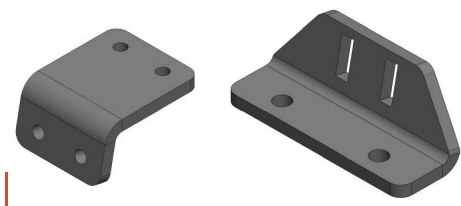

## SHORT BED

**8**

1/4"-20  
1" CARRIAGE



**20**

1/4"-20  
1" SB



**10**

1/4"-20  
9/16" BOLTS



**8**

M6-1.00  
16MM BOLTS



**8**

M8-1.25  
16MM BOLTS



**10**

1/4"-20  
TNUTS



**8**

M8 FLAT  
WASHERS



**44**

1/4" FLAT  
WASHERS



**8**

1/4"-20  
NUT



## LONG BED

**8**

1/4"-20  
1" CARRIAGE



**24**

1/4"-20  
1" SB



**10**

1/4"-20  
9/16" BOLTS



**8**

M6-1.00  
16MM BOLTS



**8**

M8-1.25  
16MM BOLTS



**10**

1/4"-20  
TNUTS



**8**

M8 FLAT  
WASHERS



**48**

1/4" FLAT  
WASHERS



**8**

1/4"-20  
NUT



## BEFORE YOU START

Make sure you have 8 capture nuts available in your aftermarket roof track. These capture nuts can be sourced through the track provider

The below assembly images may differ slightly in appearance from actual product.

USING  
TNUTS

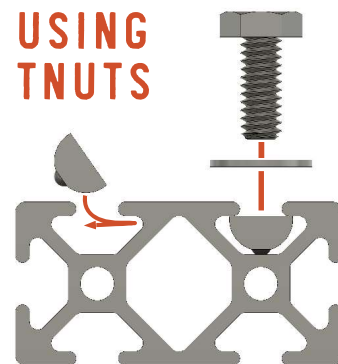

# MOUNTS

Note: The Crow's Nest rack will arrive with two mounting foot options. Utilize the set of bottom brackets with the angle that best allows the top bracket to sit level with the ground based on your specific truck topper.

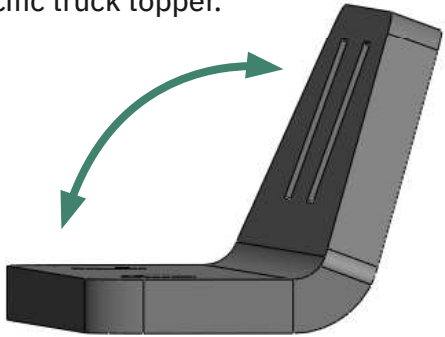

Bottom Bracket 1

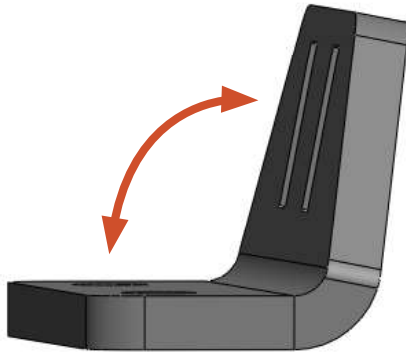

Bottom Bracket 2



Top Bracket

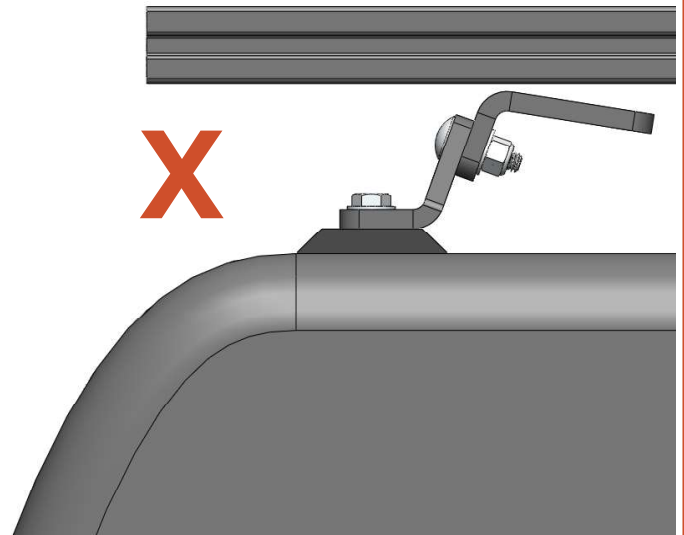
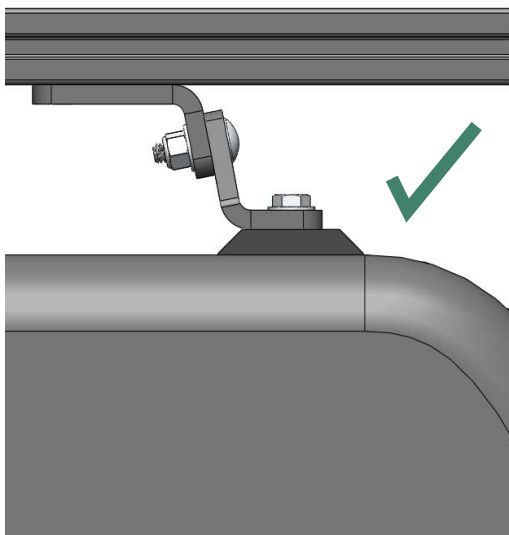

## 01 PRE ASSEMBLY

Required Components:

**2** 1/4"-20x1" Carriage Bolts

**per mount assembly**

**2** 1/4" Washers

**per mount assembly**

**2** 1/4"-20 Nylock Nuts

**per mount assembly**

Determine which configuration of the top brackets that will be used. If your rack system requires more height, assemble them in the "tall" configuration. If the height is not required, assemble them in the "short" configuration.

Tall

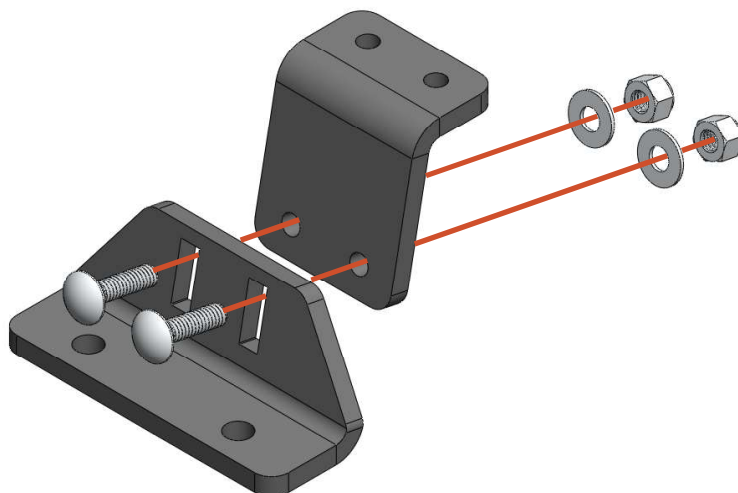

Short

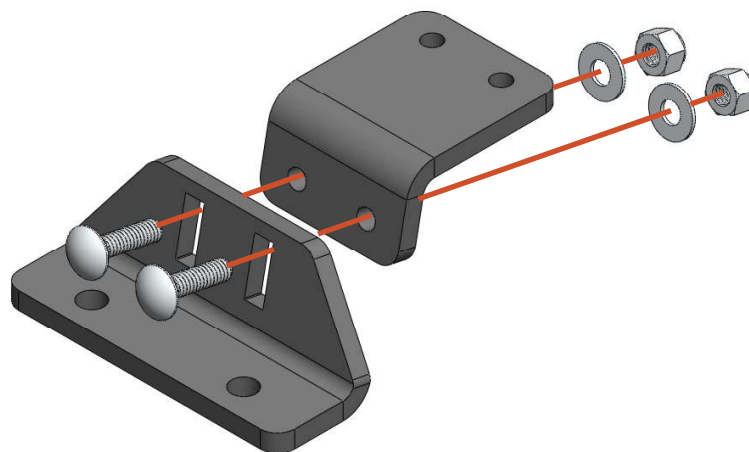

## 02 PRE ASSEMBLY

Required Components:

**2** 1/4"-20x9/16" Hex Bolts

**per mount assembly**

**2** 1/4" Washers

**per mount assembly**

**2** 1/4"-20 Tnuts

**per mount assembly**

Drop two tnuts into the slots on the broad side of the crossbar, one in each track. Bolt the top of the mounting bracket assembly from the previous step to the crossbar. Leave this hardware loose so that it can be adjusted once the crossbars are placed on the vehicle.

Repeat this process on the other end of the crossbar with the mounting bracket facing the opposite direction.

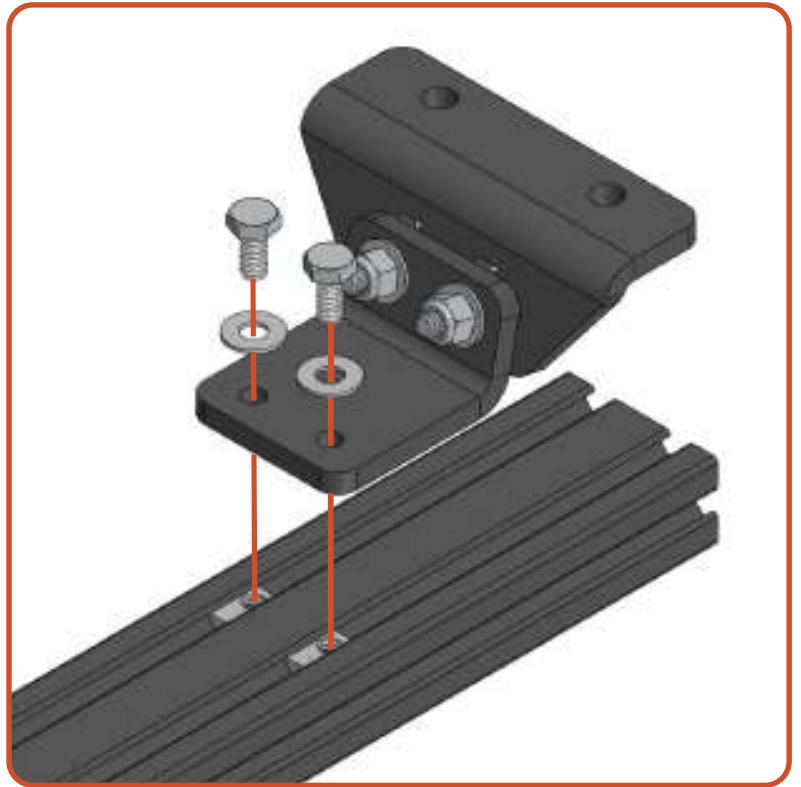

# MOUNT INSTALL

## 01 INSTALL ON VEHICLE

Required Components:

**2** M6-1.00 x 16 Hex Bolts

**per mount assembly**

**2** M6 Bonded Washers

**per mount assembly**

**2** M6 Track Nuts

**per mount assembly**

With the two main support crossbars assembled, flip them over and align the mounting brackets with the OEM roof tracks. Secure them to the vehicle using the M6 bolts, washers, and track nuts. Leave this hardware loose so that it can be adjusted once the sideplates are attached.

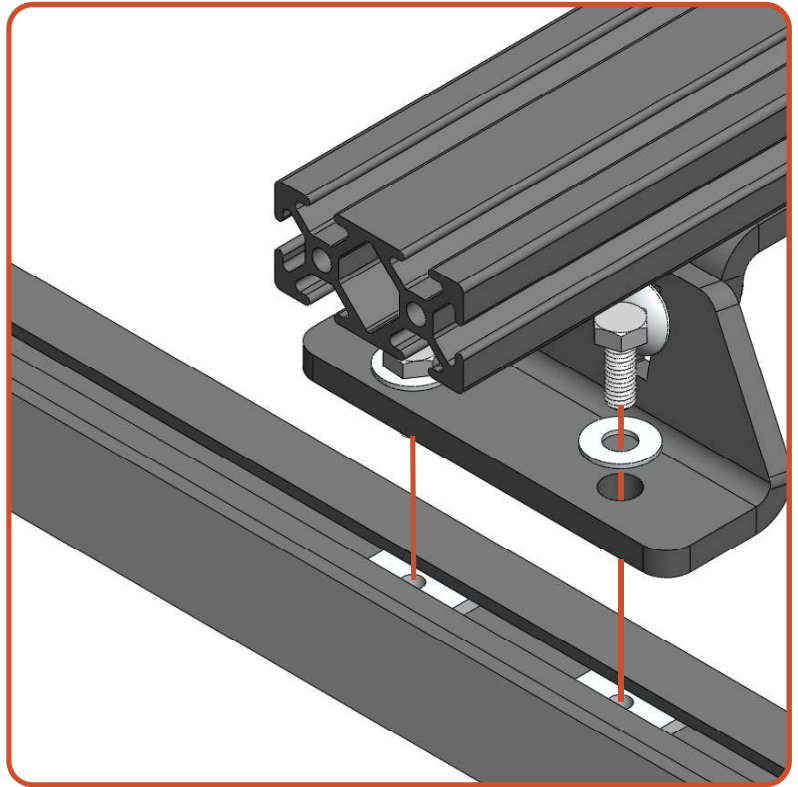

## 02 CENTER THE MOUNTS

Center the crossbars on the vehicle using a tape measure. Measure the distance from the ends of the crossbar to the inside edge of the mounting bracket on both sides of the vehicle. (shown to the right)

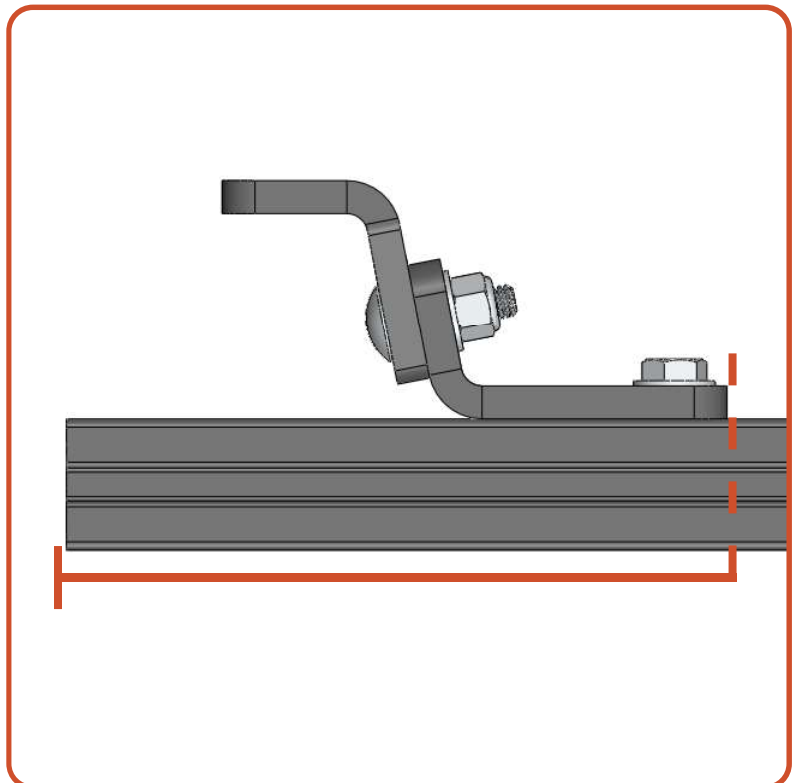

# SIDEPLATES

## 01 SIDEPLATE INSTALL

Required Components:

- 2** Sideplates
- 4** 1/4"-20x1" Socket Bolts  
**per mount assembly**
- 4** 1/4" Washers  
**per mount assembly**

Align the small slots in the sideplates with the ends of the main support crossbars. Secure them using bolts and washers. Leave the bolts loose enough to move the sideplate to the position that matches the curvature of the vehicle.

Once the rack is positioned correctly, tighten down all of the hardware for the sideplates.





## 04 INSTALL CROSSBARS

Required Components:

**Remaining** Crossbars

**4** 1/4"-20 x 1" Socket Bolts  
**per crossbar**

**4** 1/4" Flat Washers  
**per crossbar**

Secure all of the remaining crossbars to the rack system. Space evenly or position according to your load requirements.



## SHERPA NAME PLATE

### Required Components:

- 2 1/4"-20 x 9/16" Hex Bolts
- 2 1/4"-20 Nuts
- 2 1/4" Flat Washers
- 1 Sherpa Name Plates
- 1 Name Plate Backers

Place the nuts into the rear most crossbar on the rack. Using the 1/4"-20 x 0.75" socket buttons, and 1/4" flat washers attach the name plate and name plate backer to the cross bar.

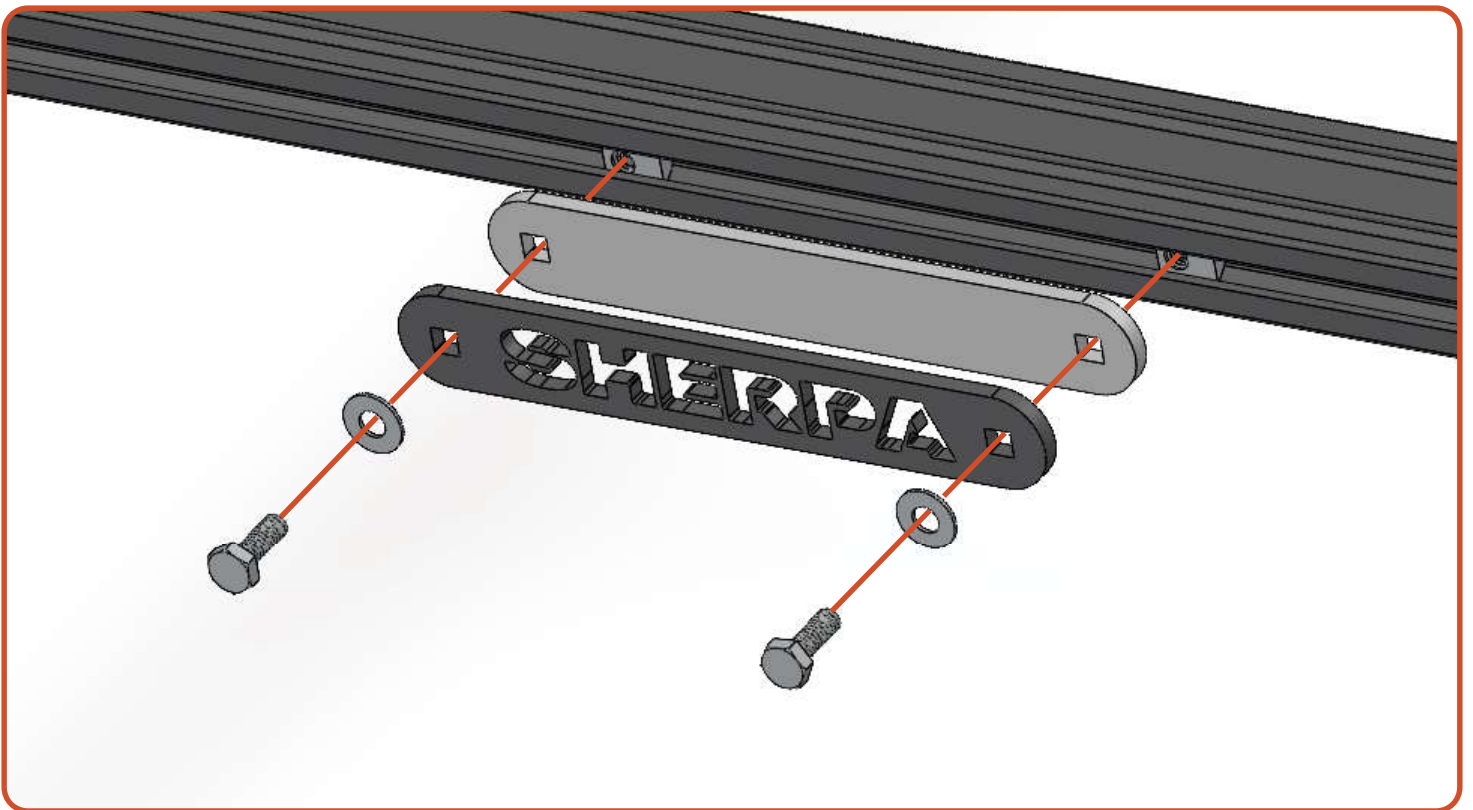

NOW GET OUT THERE AND  
**EXPLORE.**

**WELCOME TO THE SHERPA FAMILY!**  
MAKE SURE TO FOLLOW US ON YOUR SOCIALS AND TAG US IN YOUR ADVENTURES.

All products built and designed by Sherpa Equipment Company are intended for off-road use and should be assembled, installed, and used according to Sherpa Equipment Company's recommendations. Sherpa Equipment Company's products should be used safely with good judgment towards others and surroundings.

By installing Sherpa Equipment Company's products on your vehicle you assume all liability. Sherpa Equipment Company will not be held liable for damages or loss associated with the installation or use of its products. It is recommended that you inspect your roof rack within the first 100 miles of installation and every 500 miles after.