

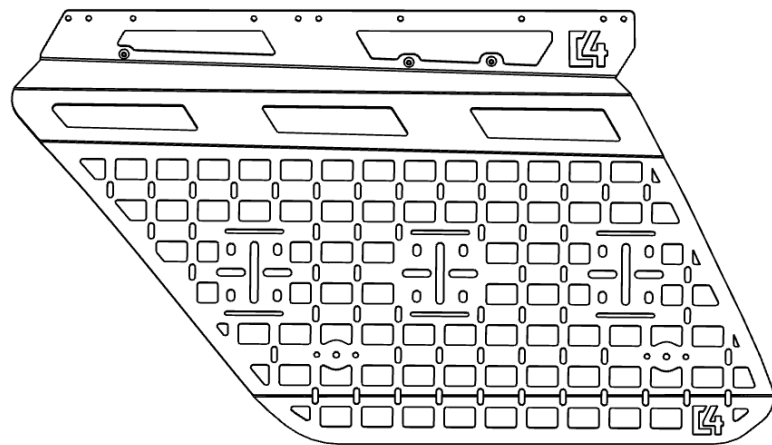

# INSTALLATION GUIDE

## 2025-UP | TOYOTA 4RUNNER

[ E-MSP FOR C4 ROOF RACK ]  
1125-70200

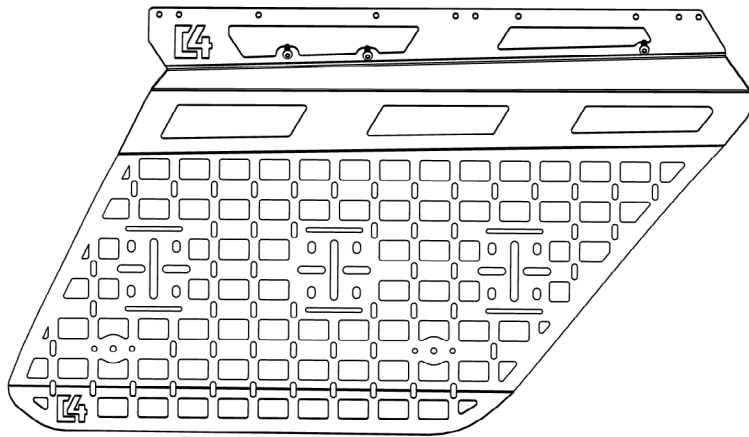

### TOOLS REQUIRED

- 7/16 Wrench
- 5/32 Hex
- Philips Head Screwdriver

### SKILL LEVEL

- Easy

### TIME REQUIRED

- Approximately 30 minutes **(This installation guide covers the installation of the product only. It does not include instructions and time for wiring)**

## ⚠ WARNINGS/CAUTIONS BEFORE STARTING INSTALLATION ⚠

-BEFORE YOU INSTALL THIS KIT-

**Read and understand all instructions,** warnings, cautions, & notes contained in this installation instruction guide. Consult your vehicle owner's manual for proper disconnection of electrical and lifting of vehicle if required for installation of this product.

This install may require some technical skills and knowledge of basic mechanical work. If you do not feel that you are capable of performing this install please take this product to a trained professional.

After reading this guide please contact us with any questions or concerns before installing product.

Customer Service: 1-605-721-2911  
C4 Fabrication is **not** responsible for any bodily injury or harm to you or your vehicle as a result of an improper install.

Proper installation of this kit required knowledge of the factory recommended procedures for removal and installation of original equipment components.

We recommend that the factory shop manual and any special tools needed to service your vehicle be on hand during the installation. Installation of this kit without proper knowledge of the factory recommended procedures may affect the performance of these components and the safety of the vehicle.

Inspect all contents of this package to make sure product is not damaged and all installation hardware has been included. If parts are missing from kit, please be prepared to provide the following information:

1. Name of purchase location
2. Bar Code on side of box
3. Date above bar code
4. Date inside box cover

**\*ALWAYS WEAR EYE PROTECTION WHEN OPERATING POWER TOOLS\***

[ A. ]  
6x

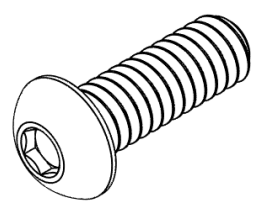

1/4-20 X 1" BUTTON HEAD BOLT  
**5/32 ALLEN**

[ A1. ]  
6x

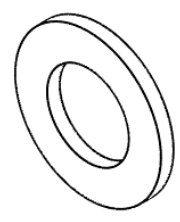

M6 WASHER

[ B . ]

4x

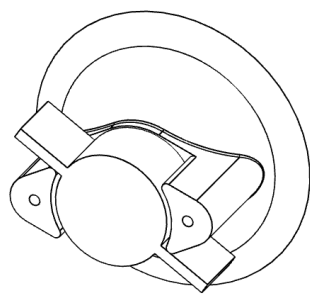

Ram Suction Cup

# INSTALL

## STEP 1

Using a philips head screwdriver, install the provided suction cup mounts (B) to the backside of the E-MSP as shown below.

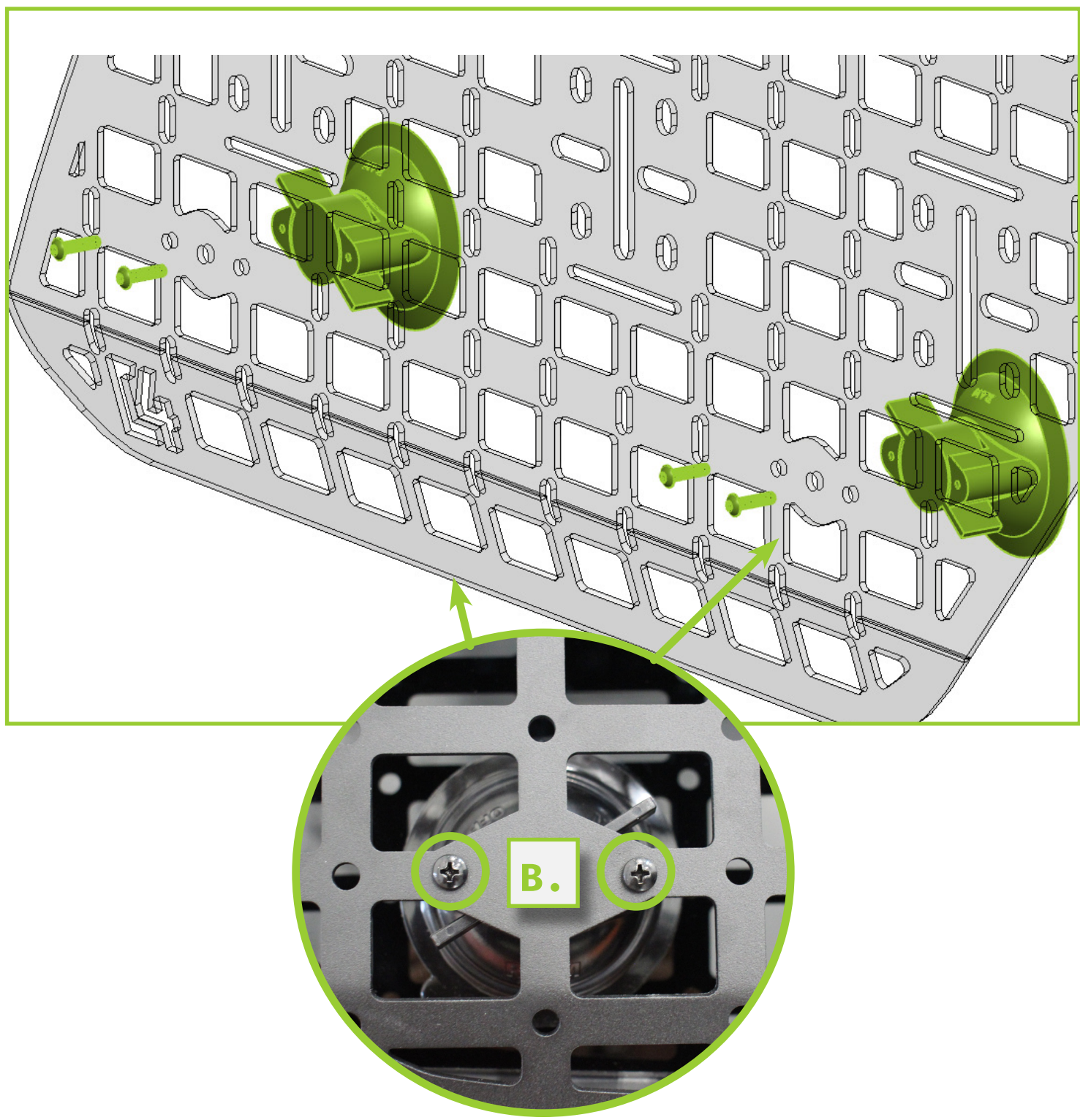

# INSTALL

## STEP 2

Using a 5/32 allen, 7/16 wrench and the provided hardware [A, A1] along with the existing hardware holding the extrusions to the roof rack, mount the E-MSP where indicated below. Rotate the suction cup tabs to engage to the rear window.

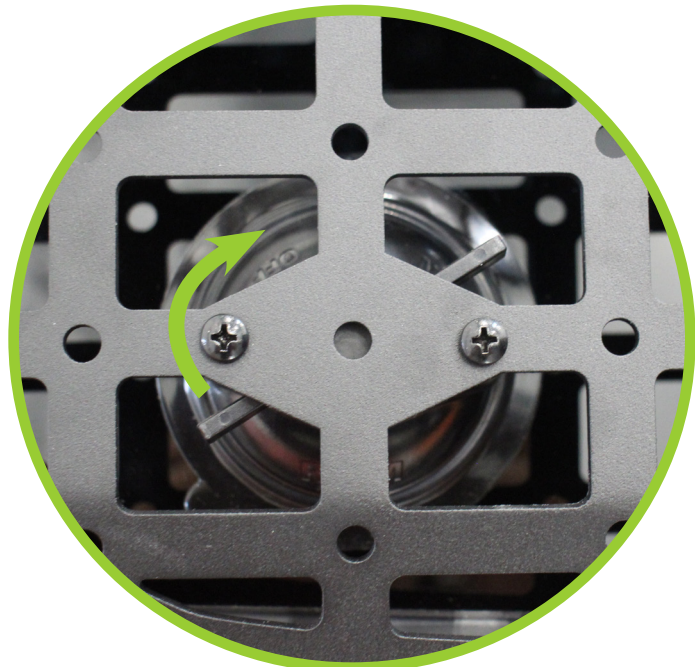
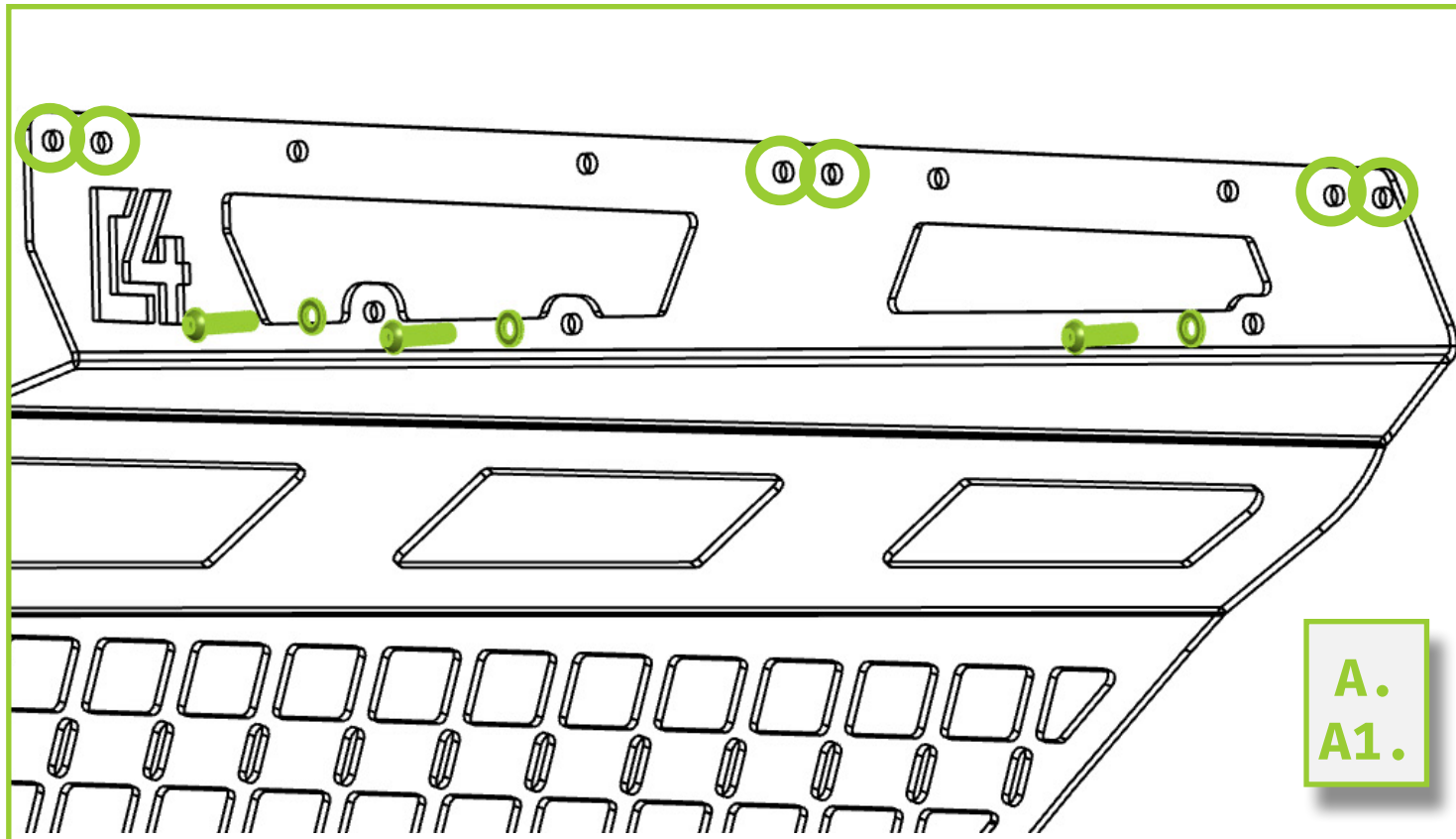



**FOR ASSISTANCE OR PRODUCT INQUIRES**

**CALL: 1-605-721-2911 OR EMAIL: [sales@c4fabrication.com](mailto:sales@c4fabrication.com)**