

TIME FOR INSTALLATION

2 HOURS

# RCI OFFROAD

MODERATE



SOME EXPERIENCE  
RECOMMENDED

## 18+ Jeep JL, JLU, JT Wrangler/Gladiator Arapaho Front Bumper Installation Guide

Contact RCI: [SALES@RCIOFFROAD.COM](mailto:SALES@RCIOFFROAD.COM)  
(970) 797-3089

Part Number	Description	Qty:
*	18+ JLU Front Bumper	1
SM-01304	JLU Spacer Plate	2
HK-00182	JLU Front Bumper HW Kit:	1
HW-00057	M12-1.75 x 40mm Hex Flange	8
HW-00022	1/2 USS Flat Washer Thru Hard	16
HW-00084	M12-1.75 Hex Nylon Insert Hex Nut	8

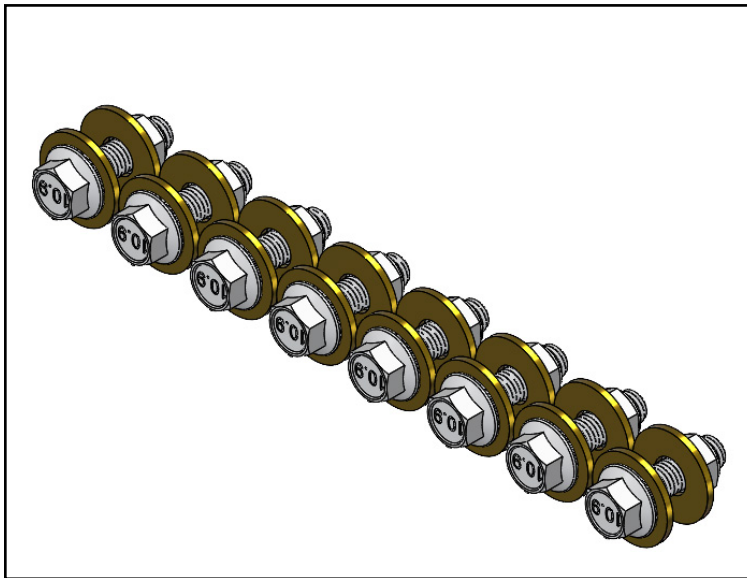

**Caution:** Use hand tools, impact wrenches may cause damage if over torqued.

**Read the entire notes and instructions before installation.**

## DISCLAIMER:

The products sold by RCI Metalworks are intended for off-road use only, should not be modified, and are for use only on the vehicle(s) specifically stated. RCI Metalworks makes no warranties express or implied, including of fitness for a particular purpose or merchantability. RCI Metalworks will not be liable for any damages arising out of the use or misuse of its products. It is the customers' responsibility to ensure the products are safely and properly attached to the vehicle, and all products should be installed by trained professionals. We strive to maintain extremely high-quality standards; however, all RCI Metalworks products are individually handcrafted, may vary slightly, and may contain minor imperfections. Due to the nature of raw aluminum, the material may have minor scratches and other blemishes caused by the manufacturing process, especially on the back side of the product. RCI Metalworks is constantly seeking to improve its products and reserves the right to make changes to any product.

Installation of an RCI bumper requires removal of factory-installed components such as crash bars and foam impact absorbers. These components are designed for vehicle safety and impact absorption, and their removal may negatively impact occupant protection in a crash. RCI is not responsible for the removal of these components, and the owner/installer assumes all risks associated with their removal and any resulting consequences. It is the owner/installer's sole responsibility to understand the implications of removing these components before proceeding with installation. The installation of this RCI bumper, improper installation of this RCI bumper, and use or misuse of this RCI bumper with other components or failure to use it in conjunction with other components, could result in or cause serious personal injury, property damage or death.

RCI bumpers are not crash-tested and are intended for off-road use only. Vehicle owners are responsible for testing and recalibrating any affected sensors after bumper installation. While RCI may conduct preliminary sensor functionality checks during product development, this does not constitute testing to Original Equipment Manufacturer (OEM) specifications. RCI is not responsible and does not accept liability, for breakage or failure of parts as a result of rugged off-road use or reckless and/or improper installation. Modifications to your vehicle are done at your own risk and RCI does not accept liability or responsibility arising from damage caused by installing parts or doing modifications.

RCI performs off-road testing on its bumpers, including winch pulls, static and dynamic recovery pulls, and general off-road use. However, RCI is not liable for any damages arising from the use or misuse of its products. Customers are responsible for ensuring products are safely and properly attached to their vehicle, and professional installation is strongly recommended. After installing any off-road product, customers should test and recalibrate all safety sensors to ensure proper functionality. Do not rely on any safety sensor functionality until this verification is complete.

RCI Offroad bumpers with receiver hitches are not load rated. Using a receiver hitch for towing or other heavy-duty tasks is not recommended unless explicitly stated by the manufacturer. The bumper and receiver hitch are intended for off-road recovery use and not designed for sustained towing or load-bearing applications. Any misuse, such as towing or overloading, may result in bumper failure, vehicle damage, or personal injury. RCI is not responsible for any damages or injuries resulting from the use of the bumper with a receiver hitch beyond its intended purpose.

If an RCI product is purchased by a third party, such as a dealer, wholesaler, or installer, it is the third party's responsibility to inform the end customer of this disclaimer.

# Installation Notes

## Installation Notes:

**RH** refers to the passenger side of the vehicle.

**LH** refers to the driver side of the vehicle.

Always use the proper torque specifications.

If applicable to this installation, torque specifications will be listed throughout the document.

Please read all of these instructions and familiarize yourself with the complete process **BEFORE** you begin.

## General Safety:

Park your car in a safe, well lit, level area.

Shut the engine off and remove the key from the ignition switch.

Make sure any remote start devices are properly disabled.

**ALWAYS** wear safety glasses.

Make sure the parking brake is applied until the vehicle is safely lifted and supported.

Whether lifting a vehicle using an automotive lift or a hydraulic jack, utilize the factory specified lift points.

Lifting a vehicle in an incorrect location can cause damage to the suspension/running gear.

**ALWAYS** support the vehicle with properly rated jack stands.

**ALWAYS** read and follow all safety information and warnings for the equipment you are using.

## Required Tools:

1/4", 3/8" & 1/2" Socket Sets & Ratchets

Floor Jack

Jack Stands

Combination Wrench Set

Plier Set

Torque Wrenches

## Installation Overview:

Before installation, remove all components and hardware from their packaging and verify that all the components are present.

## Section 1: Removing the Stock Components

### Step #1

Remove all components and hardware from their packaging and verify that all the components are present.



### Step #2

Remove the plastic clips (arrows) that secure the plastic panel (highlighted in **RED**) to the front bumper, and remove it from the vehicle.

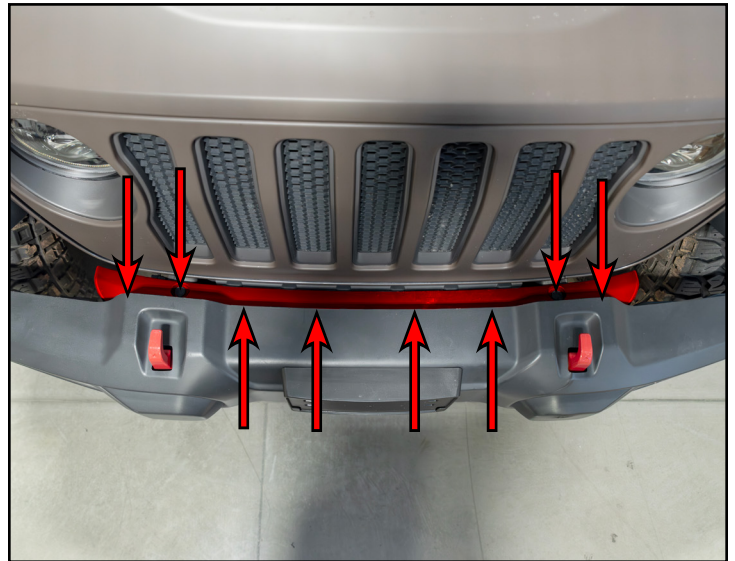

## Section 1: Removing the Stock Components

### Step #3

Disconnect the wiring harness (highlighted in **RED**) for the front fog lights.



### Step #4 7mm, 8mm Sockets & Ratchet

Remove the 7mm screws (circled in **RED**), then the 8mm screws (arrows) and remove the front splash shield from the vehicle.

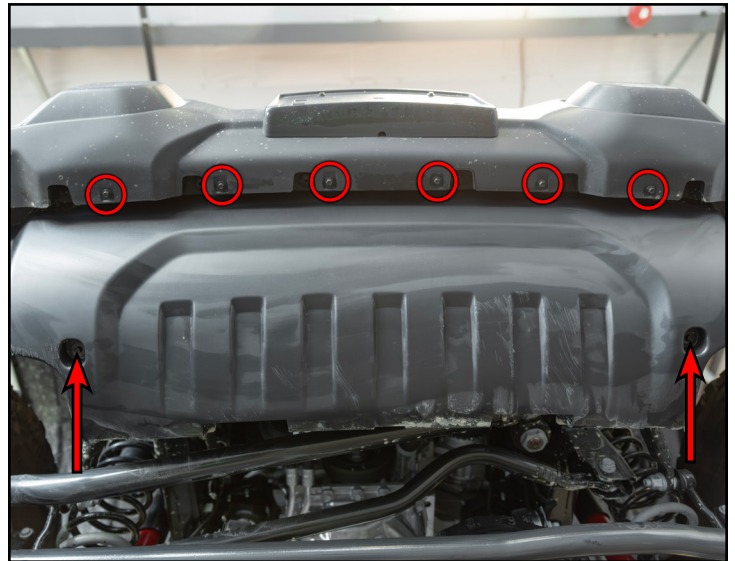

## Section 1: Removing the Stock Components

### Step #5 | 18mm Socket & Ratchet

Remove the eight (8) nuts (circled in **RED** as shown below) that secure the front bumper to the front of the vehicle, then remove the bumper.

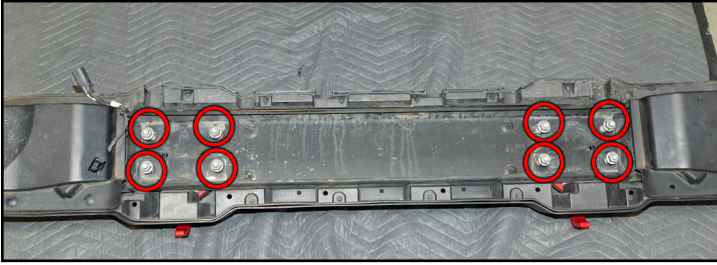

### Step #6 | 16mm Socket & Ratchet

Remove the bolts (circled in **RED**) that secure the sway bar disconnect shield and remove the shield.

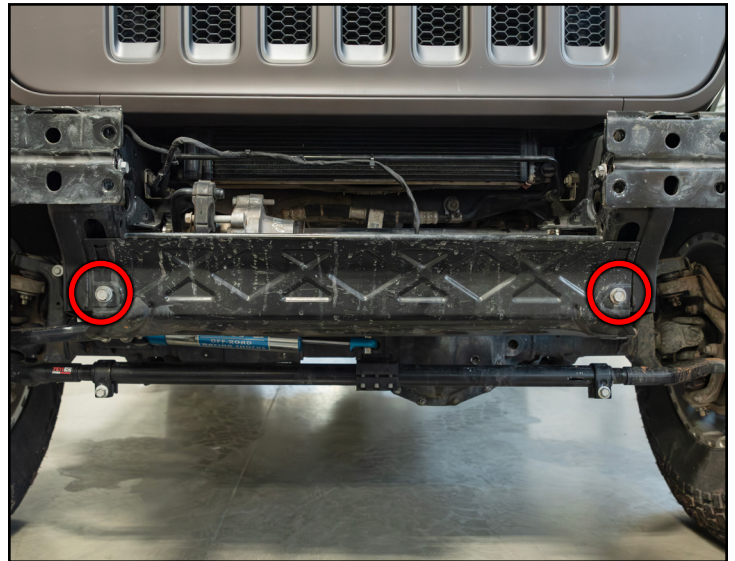

## Section 1: Removing the Stock Components

### Step #7 Panel Clip Removal Tool

Remove the plastic clips (**RED** circles) that secure the front grille to the radiator core support, then from the bottom of the grille starting at the outside corners pull the grille outward to free the retention tabs from their mounting locations.



### Step #8

Remove the front grille and set it aside.

**Optional:** The brackets (arrows) that are below the frame rail that secure the sway bar disconnect skid plate can be chopped flush with the frame.



## Section 2: Installing the New Front Bumper

### Step #1

Cut the provided double sided tape to size, then peel back the protective backing and apply the tape to the JLU front bumper spacers.



### Step #2

Peel back the protective backing from the double sided tape, then align the mounting locations on the bumper brackets (highlighted in **GREEN**) and the front frame mounting locations.



## Section 2: Installing the New

### Step #3 | Floor Jack -OR- Jack Stands

Starting with the RH mounting surface of the new front bumper install it over the RH frame mounting location, then shift the bumper toward the LH side and swing the LH side of the bumper into place. Align the mounting locations on the front bumper and the frame.

**Tech tip:** Having a friend to assist, along with using a floor jack and jack stands will make this installation easier.



### Step #4 | 19mm Socket & Torque Wrench

Install the provided M12 flanged bolts (circled in **YELLOW**) through the bumper, bracket and frame, then install the flat washer and nylon lock nut to secure the bumper in place.

Make any adjustments to the front bumper until desired fitment has been achieved, then torque the nut to 59 ft-lbs (80 Nm).

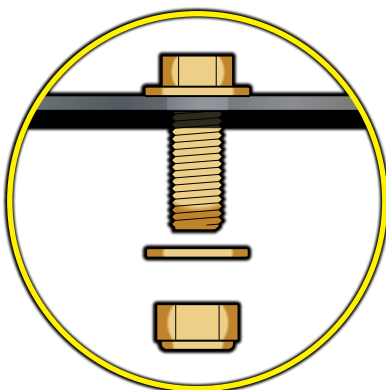

**\*M12 bolt orientation as shown:**



## Section 2: Installing the New

### Step #5

Install any front bumper accessories into the front bumper before re-installing the front grille.



### Step #6

Re-install the front grille and ensure the lower mounting tabs are fully pressed back into place.

**NOTE:** Depending on the winch being installed into the front bumper, the front grille may need to be trimmed or cut for clearance.



## Section 2: Installing the New

### Step #7

Re-install the plastic clips (**YELLOW** circles) to secure the upper grille to the radiator core support.

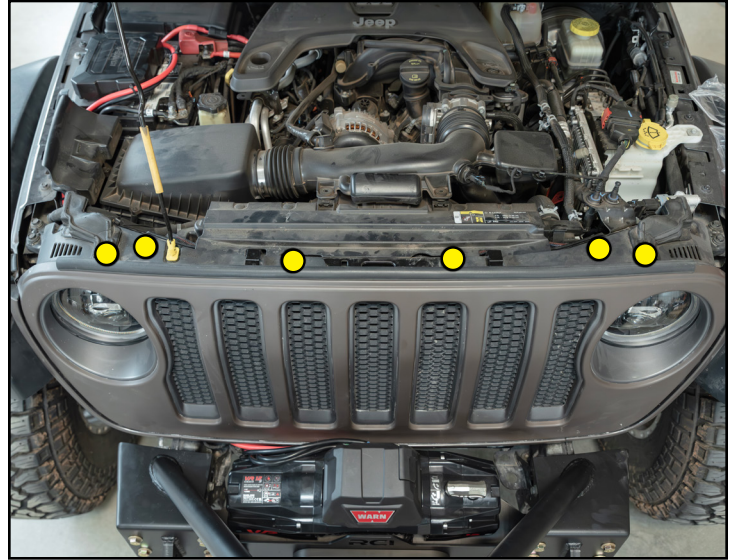

### Step #8

Enjoy your new RCI 18+ Jeep JLU Arapaho Front Bumper!



**CONGRATULATIONS, YOUR INSTALLATION IS COMPLETE!**

**ENJOY YOUR NEW RCI PROTECTION!**



**Share your new install with us on social media!  
We love seeing our products in the wild!**

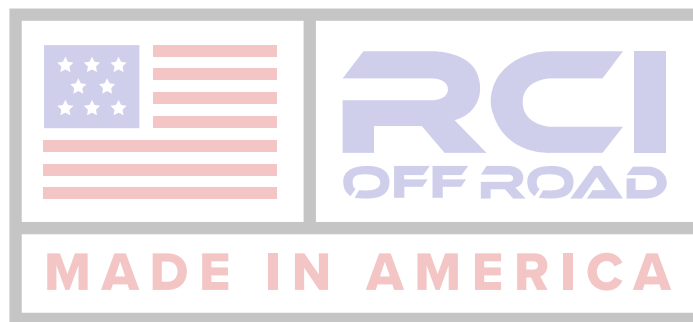

**Follow us on social media:**  
[instagram.com/rcioffroad/#](https://www.instagram.com/rcioffroad/)  
[facebook.com/RCIOffroad](https://www.facebook.com/RCIOffroad)  
[youtube.com/@RCIOFFROAD](https://www.youtube.com/@RCIOFFROAD)

**Contact:**  
1.970.797.3089  
[SALES@RCIOFFROAD.COM](mailto:SALES@RCIOFFROAD.COM)  
6701 N. FRANKLIN AVE. LOVELAND, CO 80538

**These instructions are provided as a courtesy by RCI Offroad**

Disclaimer: The products sold by RCI Metalworks are intended for off-road use only, should not be modified, and are for use only on the vehicle(s) specifically stated. RCI Metalworks makes no warranties express or implied, including of fitness for a particular purpose or merchantability. RCI Metalworks will not be liable for any damages arising out of the use or misuse of its products. It is the customers' responsibility to ensure the products are safely and properly attached to the vehicle, and all products should be installed by trained professionals. We strive to maintain extremely high-quality standards; however, all RCI Metalworks products are individually handcrafted, may vary slightly, and may contain minor imperfections. Due to the nature of raw aluminum, the material may have minor scratches and other blemishes caused by the manufacturing process, especially on the back side of product. RCI Metalworks is constantly seeking to improve its products and reserves the right to make changes to any product.